

HC-EVO-B16-BFDC-PLRBK - Housing



1407649

<https://www.phoenixcontact.com/us/products/1407649>

Please be informed that the data shown in this PDF document is generated from our online catalog. Please find the complete data in the user documentation. Our general terms of use for downloads are valid.



Panel mounting base B16, for double locking latch, material: PA 6.6-FR, protective cover material: PC, height: 30.5 mm, cable gland: none, protective cover: yes, Standard, with flat gasket

Your advantages

- Lower costs than metal version
- Low weight
- Lower risk of condensation

Commercial data

Item number	1407649
Packing unit	1 pc
Minimum order quantity	1 pc
Sales key	BF57
Product key	BF7APL
Catalog page	Page 626 (C-2-2019)
GTIN	4046356777124
Weight per piece (including packing)	104.5 g
Weight per piece (excluding packing)	103.8 g
Customs tariff number	85389099
Country of origin	PL

HC-EVO-B16-BFDC-PLRBK - Housing



1407649

<https://www.phoenixcontact.com/us/products/1407649>

Technical data

Notes

General	For contact inserts HC-B16, BB32, D40, DD72, HS6, HV6, M, K, HV06-I-PR, HV 6-E...C
---------	--

Product properties

Product type	Housing with locking latch
Housing type	Panel mounting base
Product family	HC-EVO-B
Application	Standard
Type	B16
Protective cover	yes
Pg screw connection	none

Data management status

Article revision	05
------------------	----

Dimensions

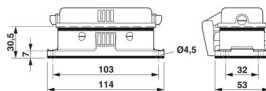
Dimensional drawing	
Width	53 mm
Height	30.5 mm
Length	114 mm
Hole diameter	4.5 mm

Installation dimensions

Width of the assembly cutout	35 mm
Length of the assembly cutout	86 mm

Material specifications

Flammability rating according to UL 94	V0 (Housing)
	V0 (Protective cover)
Seal material	NBR
	NBR
Housing material	PA 6.6-FR
Material, protective cover	PC

Mechanical properties

Mechanical data

Locking type	Pin
--------------	-----

Connection data

HC-EVO-B16-BFDC-PLRBK - Housing



1407649

<https://www.phoenixcontact.com/us/products/1407649>

Tightening torque	0.8 Nm ... 1.2 Nm (For M4 mounting screws on the panel-mount base)
-------------------	--

Mounting

Assembly note	Not for D series terminal adapters
	Not for HC-B 24-ADP-B..... adapter plates

Environmental and real-life conditions

Ambient conditions

Degree of protection	IP66 (when plugged in)
	IP54 (with closed protective cover)
Enclosure rating (NEMA)	12 (UL 50e)
Impact strength	IK09
Ambient temperature (operation)	-40 °C ... 125 °C

HC-EVO-B16-BFDC-PLRBK - Housing

1407649

<https://www.phoenixcontact.com/us/products/1407649>



Drawings

Dimensional drawing

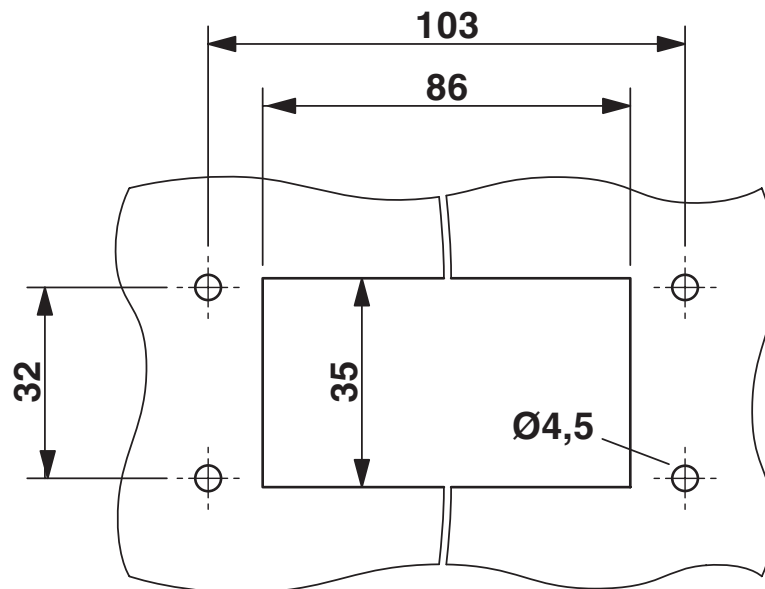

Mounting cutout

Dimensional drawing

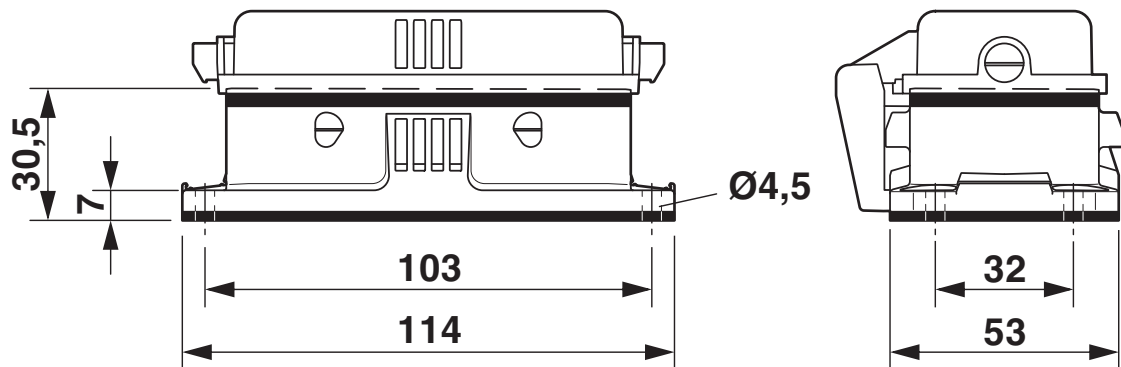

Dimensional drawing

HC-EVO-B16-BFDC-PLRBK - Housing



1407649

<https://www.phoenixcontact.com/us/products/1407649>

Approvals

 To download certificates, visit the product detail page: <https://www.phoenixcontact.com/us/products/1407649>

DNV

Approval ID: TAE000037S



EAC

Approval ID: RU C-DE.AI30.B.01102



EAC

Approval ID: RU C-DE.BL08.B.00511

HC-EVO-B16-BFDC-PLRBK - Housing



1407649

<https://www.phoenixcontact.com/us/products/1407649>

Classifications

ECLASS

ECLASS-11.0	27440202
ECLASS-12.0	27440202
ECLASS-13.0	27440202

ETIM

ETIM 9.0	EC000437
----------	----------

UNSPSC

UNSPSC 21.0	31261500
-------------	----------

HC-EVO-B16-BFDC-PLRBK - Housing



1407649

<https://www.phoenixcontact.com/us/products/1407649>

Environmental product compliance

EU RoHS	
Fulfills EU RoHS substance requirements	Yes, No exemptions
China RoHS	
Environment friendly use period (EFUP)	EFUP-E
	No hazardous substances above the limits
EU REACH SVHC	
REACH candidate substance (CAS No.)	No substance above 0.1 wt%

Phoenix Contact 2024 © - all rights reserved
<https://www.phoenixcontact.com>

Phoenix Contact USA
586 Fulling Mill Road
Middletown, PA 17057, United States
(+717) 944-1300
info@phoenixcon.com