

# RECOMMENDED P.C.B. LAYOUT

used for: D-SUB HD

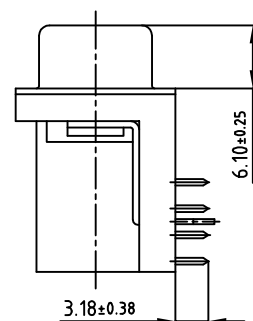
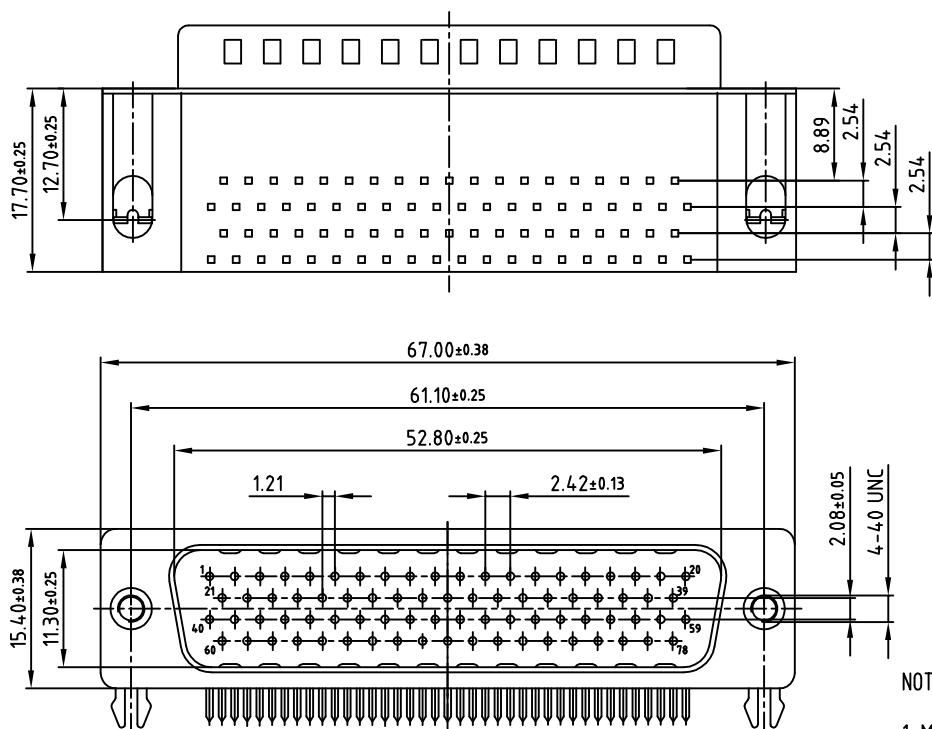
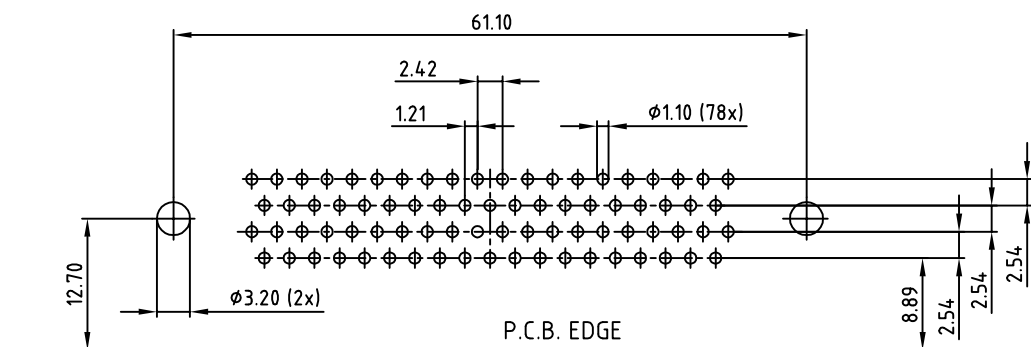

## NOTES

### 1. MATERIAL:

Housing:PBT, UL 94V-0, Color:Black.  
Terminal:Copper Alloy.  
Shell:SPCC.  
Boardlock:Copper Alloy.  
Rivet:Copper Alloy.

### 2. FINISH:

Terminal:Gold Plated over Nickel at Contact Area.  
Tin Plated over Nickel at Solder Ared.  
Shell:Nickel Plated.  
Boardlock:Tin Plated.  
Rivet:Nickel Plated.

### 3. This Product is LEAD-FREE & RoHS Compliance Product.

## SPECIFICATIONS

### 1. D-SUB

- 1.1 Voltage: 250 VAC(RMS) Max.
- 1.2 Current Rating: 3 Ampere per Contact
- 1.3 Contact Resistance: 25 mOhm max.
- 1.4 Insulation Resistance: 5000 MOhm min.
- 1.5 Dielectric Withstanding Voltage: 1000 VAC(RMS)
- 1.6 Total Mating Force: 27.4 Kgf Max.
- 1.7 Total Unmating Force: 2.5 Kgf Min.
- 1.8 Operating Temperature: -55°C to +85°C

Directive 2002/95/EC RoHS compliant

THIS DRAWING MAY NOT BE COPIED OR  
REPRODUCED IN ANY WAY, AND MAY NOT  
BE PASSED ON TO A THIRD PARTY WITHOUT  
WRITTEN PERMISSION.  
OWNERSHIP AND COPYRIGHT OF CONEC GmbH  
DO NOT ALTER CAD DRAWING BY HAND

rev.	description	date	name
a	Original		

tolerance	dim. in mm
.00 ±0.25	
.000 ±0.130	
2011	date
drawn	08.12.
appd.	08.12.
norm	
d-old	

scale:	2:1
material:	SEE SPECIFICATION
title:	D-SUB HD MALE 90° 78pos. SOLDER PIN ANGLED 0.350inch
dwg no:	16K1A2897
part no:	DLH5XP8AK53X

DIN-A  
3  
sh: 1/1

# Mouser Electronics

Authorized Distributor

Click to View Pricing, Inventory, Delivery & Lifecycle Information:

[CONEC:](#)

[DLH5XP8AK53X](#)