

HC-B 24-TMS-100/O1STM40S-EEE - Housing



1460360

<https://www.phoenixcontact.com/us/products/1460360>

Please be informed that the data shown in this PDF document is generated from our online catalog. Please find the complete data in the user documentation. Our general terms of use for downloads are valid.



HEAVYCON ADVANCE sleeve housing B24, with high-grade steel screw locking (hexagonal socket-head), salt water resistant aluminum, height 100 mm, with thread, 1 x M40 lateral cable outlet, without surface; conductive seal (EMC properties)

Commercial data

Item number	1460360
Packing unit	10 pc
Minimum order quantity	1 pc
Product key	BF7AAA
Catalog page	Page 525 (C-4-2013)
GTIN	4046356592819
Weight per piece (including packing)	457.2 g
Weight per piece (excluding packing)	457.2 g
Country of origin	DE

HC-B 24-TMS-100/O1STM40S-EEE - Housing



1460360

<https://www.phoenixcontact.com/us/products/1460360>

Technical data

Notes

General	for contact inserts HC-B24, BB46, D64, DD108, HV10/16, M
---------	--

Product properties

Product type	Housing with screw locking
Housing type	Sleeve housing
Application	Offshore/EMC
Type	B24
No. of cable outlets	1
Type of the screw connection	1x M40
Fixing screws	M6 (screw head: 5 mm Allen screw)
Shielded	yes
Cable outlet	lateral
Pg screw connection	none

Connection data

Tightening torque	3 Nm (Locking screw)
-------------------	----------------------

Dimensions

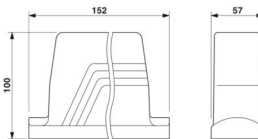
Dimensional drawing	
Width	57 mm
Height	100 mm
Length	152 mm

Installation dimensions

Width of the assembly cutout	35 mm
Length of the assembly cutout	112 mm

Material specifications

Seal material	NBR, conductive
Housing material	Die-cast aluminum, corrosion resistant
Housing surface material	uncoated
Locking latch material	Stainless steel

Environmental and real-life conditions

Ambient conditions

Degree of protection	IP66
	IP68 (0.2 bar/24 h)

HC-B 24-TMS-100/O1STM40S-EEE - Housing



1460360

<https://www.phoenixcontact.com/us/products/1460360>

	IP69K
Enclosure rating (NEMA)	4 (NEMA 250)
	4X (NEMA 250)
	6P (NEMA 250)
	12 (NEMA 250)
Ambient temperature (operation)	-40 °C ... 125 °C

Mechanical properties

Mechanical data

Type of the screw connection	1x M40
Locking type	Screw

Mounting

Assembly note	In order to guarantee that the protective conductor contact functions even when plugged in at an angle, the two panel-mount flanges must have sufficient electrical contact with the metal mounting panel.
	To ensure optimum shielding, any insulating power coating must be removed from the profile gasket area on the control cabinet panel. Tightening torque of locking screw: 3 Nm.
Fixing screws	M6 (screw head: 5 mm Allen screw)

Drawings

Dimensional drawing

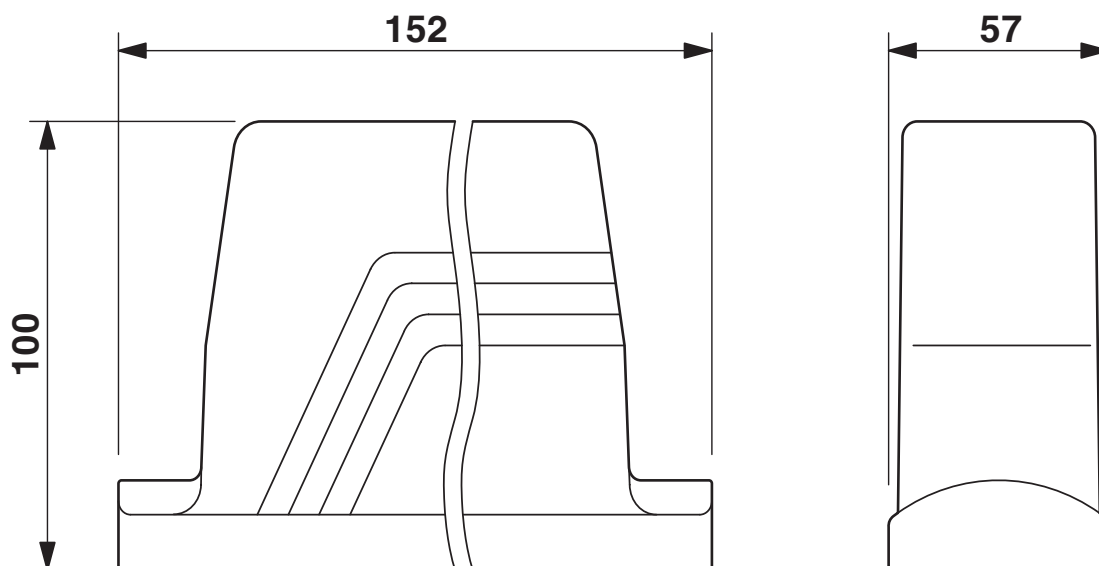

Dimensional drawing

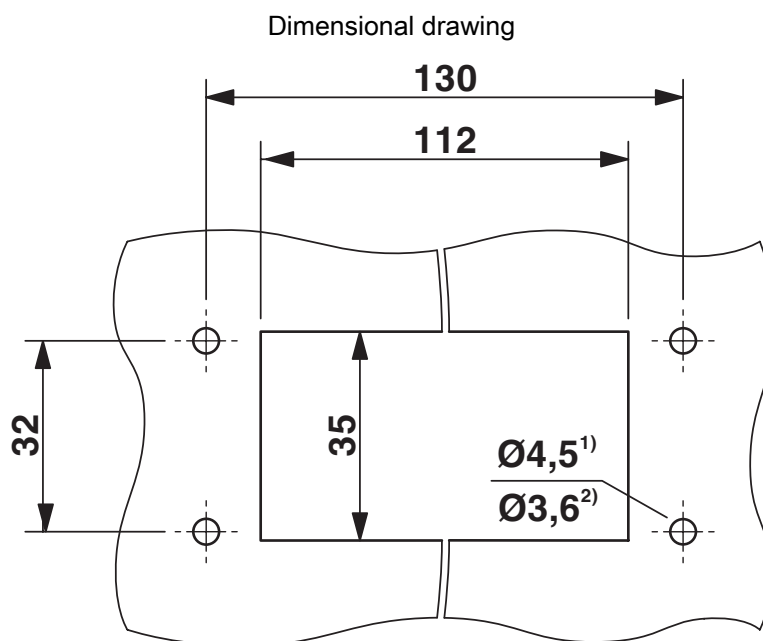

Panel cutout

²⁾ when self-tapping screws are used (Torx® 20, M4)

HC-B 24-TMS-100/O1STM40S-EEE - Housing



1460360

<https://www.phoenixcontact.com/us/products/1460360>

Classifications

ECLASS

ECLASS-11.0	27440202
ECLASS-13.0	27440202

Environmental product compliance

EU RoHS	
Fulfills EU RoHS substance requirements	Yes, No exemptions
EU REACH SVHC	
REACH candidate substance (CAS No.)	No substance above 0.1 wt%

HC-B 24-TMS-100/O1STM40S-EEE - Housing



1460360

<https://www.phoenixcontact.com/us/products/1460360>

Accessories

HC-B-AF - Panel-mount flange

1686533

<https://www.phoenixcontact.com/us/products/1686533>



Panel-mount flange for HEAVYCON ADVANCE housing

HC-B-AF-SET - Panel-mount flange

1604638

<https://www.phoenixcontact.com/us/products/1604638>

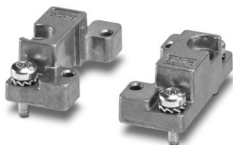

Panel-mount flange for HEAVYCON ADVANCE housing, set consisting of:
2 panel-mount flanges with 4 self-tapping screws (M4, Torx®) and 4 fan-type washers

HC-B 24-TMS-100/O1STM40S-EEE - Housing



1460360

<https://www.phoenixcontact.com/us/products/1460360>

HC-B 24-TMS-SD-IP50 - Protective cover

1690765

<https://www.phoenixcontact.com/us/products/1690765>



Protective cover B24, with clip locking, protective cover material: PA, height: 31.2 mm, seal: no, with lanyard

HC-B 24-TMS-SD-IP65 - Protective cover

1690804

<https://www.phoenixcontact.com/us/products/1690804>



HEAVYCON ADVANCE B24 IP65 protective cover, for panel mounting side, with screw locking, with retaining cord, diameter of retaining cord eyelet: 3 mm

HC-B 24-TMS-100/O1STM40S-EEE - Housing



1460360

<https://www.phoenixcontact.com/us/products/1460360>

HC-B-TMS-ERSSCHR-IMB - Screw

1409244

<https://www.phoenixcontact.com/us/products/1409244>



Replacement locking screw, M6, stainless steel, for HEAVYCON-ADVANCE housing, HC-B...TMS...EEE design, 5 mm Allen screw

G-INS-M40-M68N-PNES-GY - Cable gland

1411128

<https://www.phoenixcontact.com/us/products/1411128>



Cable gland, material for screw connection: PA, application: Standard, external cable diameter 19 mm ... 28 mm, shielding: no, connecting thread: M40 x 1.5, color: silver-grey RAL 7001

HC-B 24-TMS-100/O1STM40S-EEE - Housing



1460360

<https://www.phoenixcontact.com/us/products/1460360>

G-INS-M40-M68N-PNES-BK - Cable gland

1411137

<https://www.phoenixcontact.com/us/products/1411137>



Cable gland, material for screw connection: PA, application: Standard, external cable diameter 19 mm ... 28 mm, shielding: no, connecting thread: M40 x 1.5, color: jet black RAL 9005

G-INS-M40-M68N-NNES-S - Cable gland

1411167

<https://www.phoenixcontact.com/us/products/1411167>



Cable gland, material for screw connection: Brass, nickel-plated, application: Standard, external cable diameter 19 mm ... 28 mm, shielding: no, connecting thread: M40 x 1.5, color: silver, with O-ring

HC-B 24-TMS-100/O1STM40S-EEE - Housing

1460360

<https://www.phoenixcontact.com/us/products/1460360>



HC-M-KV-M40(27-34) - Cable gland

1607729

<https://www.phoenixcontact.com/us/products/1607729>



Metal screw connection up to 5 bar, thread length: 8 mm, cable diameter: 27 ... 34 mm, WAF 50, screw connection: M40

G-INSEC-M40-M68N-NCRS-S - Cable gland

1411192

<https://www.phoenixcontact.com/us/products/1411192>



Cable gland, material for screw connection: Brass, nickel-plated, application: EMC, external cable diameter 19 mm ... 27 mm, shielding: yes, connecting thread: M40 x 1.5, color: silver, with O-ring

HC-B 24-TMS-100/O1STM40S-EEE - Housing

1460360

<https://www.phoenixcontact.com/us/products/1460360>



HC-M-KV-Z-M40 - Cable gland

1646175

<https://www.phoenixcontact.com/us/products/1646175>

Metal screw connection with strain relief clamp, thread length: 8 mm, cable sealing area: 24 - 33 mm, clamping area: 26 - 36 mm, SW 50, screw connection: M40



REDUC-M-KV-M40/M32 - Reducing adapter

1647640

<https://www.phoenixcontact.com/us/products/1647640>

Reducing adapter, connecting thread: M40 x 1.5, color: silver, with O-ring



HC-B 24-TMS-100/O1STM40S-EEE - Housing

1460360

<https://www.phoenixcontact.com/us/products/1460360>



HC-M-BS-M40 - Screw plug

1645875

<https://www.phoenixcontact.com/us/products/1645875>

Screw plug, material for screw connection: Brass, nickel-plated, connecting thread: M40 x 1.5, color: silver



HC-B 24-TMS-EEE-PR-DI - Profile gasket

1409820

<https://www.phoenixcontact.com/us/products/1409820>

Profile gasket for sleeve housing type B24.....EEE



HC-B 24-TMS-100/O1STM40S-EEE - Housing



1460360

<https://www.phoenixcontact.com/us/products/1460360>

SF-BIT-HEXB 5-89 - Screw insert

1208911

<https://www.phoenixcontact.com/us/products/1208911>

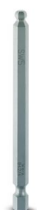

Screw bit, hexagonal with ball head, E6.3-1/4" drive, size: Hex 5 x 89 mm, hardened, suitable for holder according to DIN 3126-F 6.3/ISO 1173

SF-M BH - Screwdriver

1212070

<https://www.phoenixcontact.com/us/products/1212070>



Bit screwdriver, with 1/4" quick-action chuck, handle length 119 mm, 2-component handle, with non-slip grip, suitable for bits according to DIN 3126-C 6.3 and E 6.3/ISO 1173, magnetic

Phoenix Contact 2024 © - all rights reserved
<https://www.phoenixcontact.com>

Phoenix Contact USA
586 Fulling Mill Road
Middletown, PA 17057, United States
(+717) 944-1300
info@phoenixcon.com