

DESCRIPTION: M12 FEMALE - CABLE MOUNT - SOLDER CUP - 12 POS. - SHIELDED

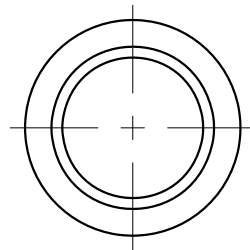

NUT

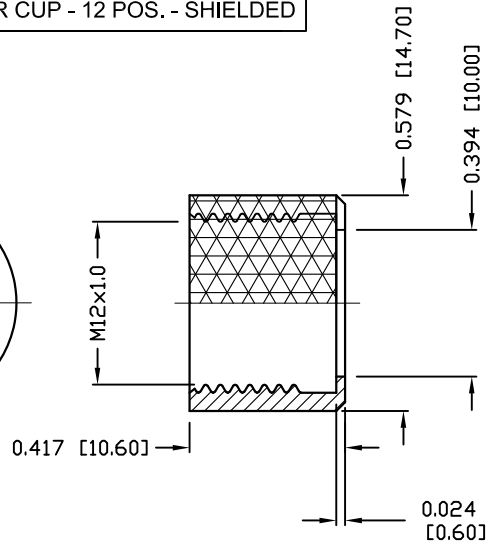

NOTE:

MATERIAL

HOUSING:

PBT UL94V-0, BLACK

CONTACT:

BRASS

NUT:

BRASS

O-RING:

EPDM, BLACK

SHELL:

BRASS

FINISH

CONTACT:

GOLD PLATED

NUT:

OVER 50μ" NICKEL

SHELL:

NICKEL PLATED

ELECTRICAL

RATED CURRENT:

1A

RATED VOLTAGE:

30V

INSULATION RESISTANCE:

100 MΩhms MIN.

CONTACT RESISTANCE:

10 mΩhms MAX.

WATER PROOF:

IP67

ENVIRONMENT

OPERATION TEMPERATURE:

-40°C TO +85°C

WIRE GAUGE:

24-28 AWG

858-012-203RSSY

3 = BRASS/TIN (B/T) SHELL & BRASS/NICKEL NUT

S = STAINLESS STEEL (SS) SHELL & NUT

T = B/T SHELL / SS NUT

1 = GOLD FLASH

4 = 10μ" GOLD

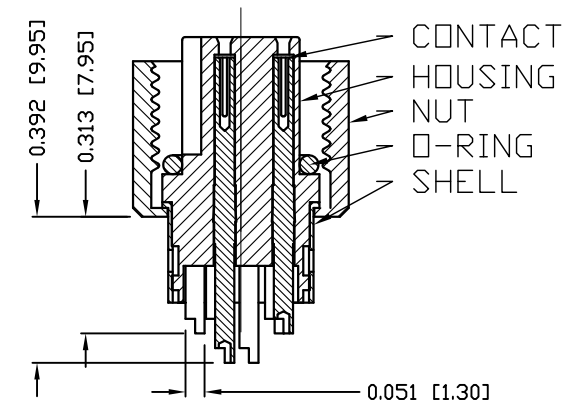
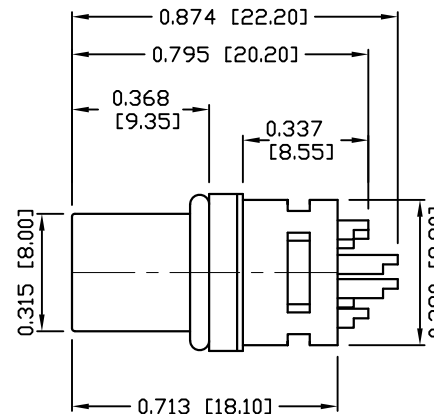
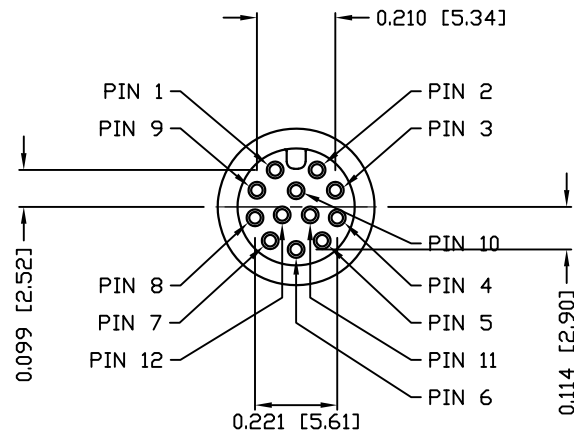

RoHS COMPLIANT

DO NOT SCALE FROM DRAWING



THESE DRAWINGS AND SPECIFICATIONS ARE THE PROPERTY OF NorComp AND SHALL NOT BE REPRODUCED, COPIED OR USED AS THE BASIS FOR THE MANUFACTURE OR SALE OF APPARATUS WITHOUT WRITTEN PERMISSION.

DRAWN:

M. SIGMON

DATE:

04-19-16

NorComp

SCALE:

NTS

SHEET

1

OF

1

REV

2

DWG NO.

858-012-203RSSY

Mouser Electronics

Authorized Distributor

Click to View Pricing, Inventory, Delivery & Lifecycle Information:

NorComp:

[858-012-203RSS1](#) [858-012-203RSS4](#)