

Actuator

17-
03035W

Distribution by
DigiKey

DigiKey



<https://digikey.eao.com/p/17-03035W>

Your product:



17-03035W Actuator

FRONT

Front form:	round
Reflector:	Metal, polished chromium-plated, internal
Front dimension:	Ø 7 mm

MOUNTING

Mounting cut-out:	Ø 6 mm
Design:	raised

OPERATING-/INDICATION PART

Illumination colour:	White
----------------------	-------

ELECTRICAL CHARACTERISTICS

Lumi. Intensity:	410 mcd
Polarity:	Anode (+) Brass plug-in connector Cathode (-) Brass tinned plug-in connector
Operation current:	15 mA \pm 15 %
Operating voltage:	24 V AC/DC \pm 10 %

MECHANICAL CHARACTERISTIC

Terminal:	Plug-in terminal, 2 x 0.5 mm
Weight:	0.003 kg
Tightening torque:	Fixing nut max. 0.2 Nm

AMBIENT CONDITION

IP Protection: IP40 front side, IP65 front side, according to IEC 60529

Operating temperature: – 20 °C ... + 60 °C

Storage temperature: – 25 °C ... + 80 °C

CERTIFICATE

Conformities: 2011 / 65 / EC (RoHS), 2014 / 35 / EU (230 VAC)

Approbations: UL

OTHER

Hints: Connectors: Brass terminal = anode (+); brass tinned terminal = cathode (-), IP67 front side gap between LED and reflector and gap between reflector and frontplate sealed to IP67 when using the supplied gasket., The plastic is limited resistant to chemicals.

Kind of illumination: Single-LED

Short Description: Actuator, Ø 6 mm, Ø 7 mm, round, Plug-in terminal, 2 x 0.5 mm, White

Dimension drawings:

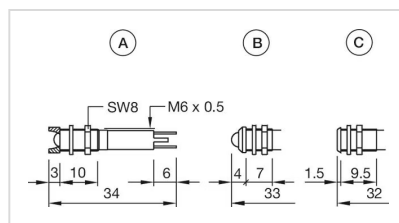

A = interior
B = exterior
C = superflat

Mounting cut-outs:

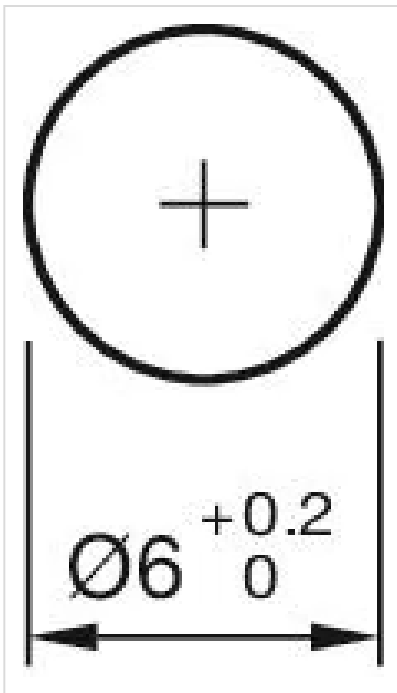

Wiring diagrams:

