

Customer Information Sheet

DRAWING No.: M80-551XXXX

SHEET 2 OF 2

IF IN DOUBT - ASK

(C)

NOT TO SCALE

THIRD ANGLE PROJECTION

ALL DIMENSIONS IN mm

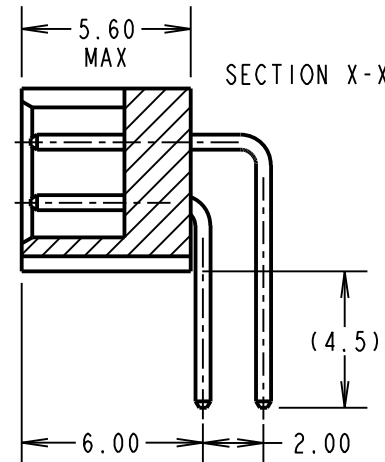
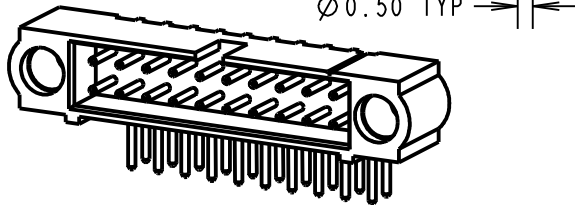
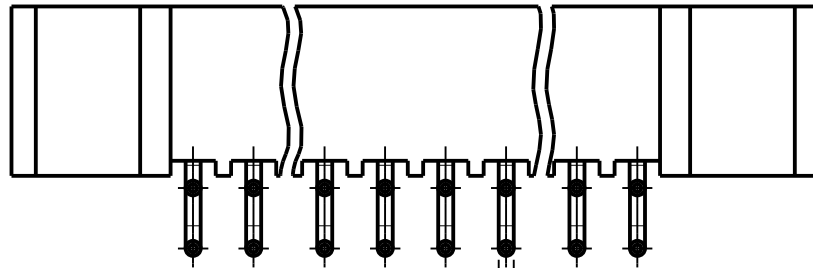
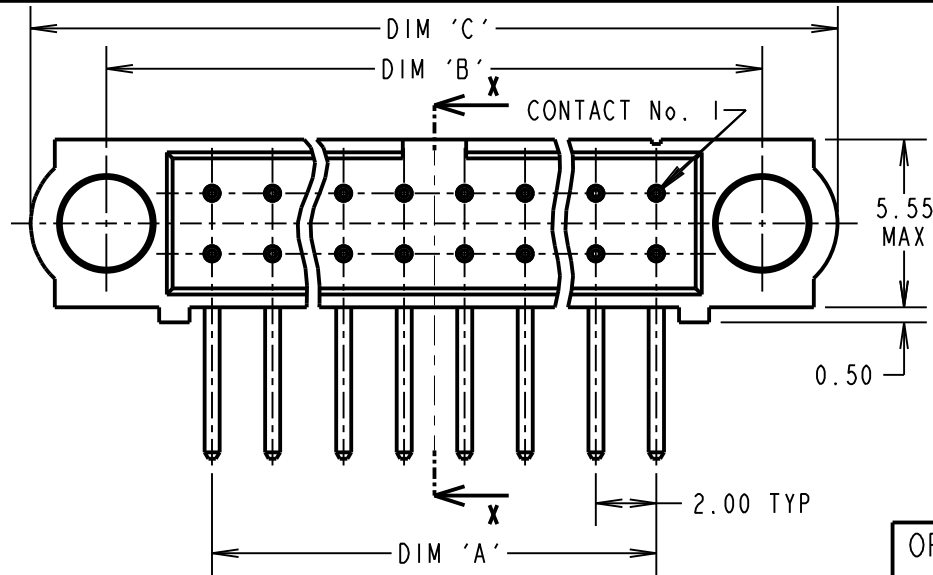

ORDER CODE:

M80-551XXXXNo. OF CONTACTS
04 TO 50
(EVEN NUMBERS ONLY)

FINISH

22 - SELECTIVE GOLD + TIN/LEAD
42 - SELECTIVE GOLD + 100% TIN OVER NICKEL
05 - GOLD ALL OVER

SPECIFICATIONS:

MATERIAL:

MOULDING = GLASS-FILLED PPS,
UL94V-0, BLACK

CONTACT = PHOSPHOR BRONZE

JACKSCREW = STAINLESS STEEL

FINISH:

22 = 0.75µ GOLD ON CONTACT AREA,
3 µ 90/10 TIN/LEAD ON TAILS42 = 0.75µ GOLD ON CONTACT AREA,
3 µ 100% TIN OVER NICKEL ON TAILS

05 = 0.75µ GOLD ALL OVER

ELECTRICAL:

CURRENT RATING AT 25°C = 3.0A MAX

CURRENT RATING AT 85°C = 2.2A MAX

WORKING VOLTAGE = 800V AC/DC

VOLTAGE PROOF = 1200V AC/DC

CONTACT RESISTANCE = 25 mΩ MAX

INSULATION RESISTANCE = 100 MΩ MIN

MECHANICAL:

DURABILITY = 500 OPERATIONS

ENVIRONMENTAL:

TEMPERATURE RANGE = -55°C TO +125°C

PACKING: TUBE

FOR COMPLETE SPECIFICATION, SEE

COMPONENT SPECIFICATION C005XX

(LATEST ISSUE)

NOTES:

1. RECOMMENDED PCB HOLE
SIZE = Ø0.70±0.05mm.

DIMENSION	CALCULATION
DIM 'A'	TOTAL No. OF CONTACTS - 2
DIM 'B'	TOTAL No. OF CONTACTS + 5
DIM 'C'	TOTAL No. OF CONTACTS + 10
EXAMPLE: CONNECTOR WITH 20 CONTACTS WITH SELECTIVE GOLD AND 100% TIN OVER NICKEL, M80-5512042	
DIM 'A' = 18.00mm, DIM 'B' = 25.00mm, DIM 'C' = 30.00mm	

MSP	2	18.08.15	13052
NAME	ISS.	DATE	C/NOTE
APPROVED: M.PERREN			
CHECKED: M.PLESTED			
DRAWN: W. J. BOURNE			
CUSTOMER REF.:			
ASSEMBLY DRG:			

HARWINwww.harwin.com
technical@harwin.comTHIS DRAWING AND ANY
INFORMATION OR DESCRIPTIVE
MATTER SET OUT HEREON ARE
CONFIDENTIAL AND COPYRIGHT
PROPERTY OF THE HARWIN
GROUP AND MUST NOT BE
DISCLOSED, LOANED, COPIED
OR USED FOR MANUFACTURING,
TENDERING OR FOR ANY
OTHER PURPOSE WITHOUT
THEIR WRITTEN PERMISSION.TOLERANCES
X. = ±1mm
X.X = ±0.50mm
X.XX = ±0.10mm
X.XXX = ±0.01mm
ANGLES = ±5°
UNLESS STATED

MATERIAL:

SEE ABOVE

FINISH:

SEE ABOVE

S/AREA:

mm²TITLE: JACKSCREW DATAMATE
DIL HORIZONTAL PC TAIL
(4.5mm) MALE ASSEMBLY (NO J/S)

DRAWING NUMBER:

M80-551XXXXSHT
2 OF 2

Mouser Electronics

Authorized Distributor

Click to View Pricing, Inventory, Delivery & Lifecycle Information:

Harwin:

[M80-5513422](#) [M80-5514222](#) [M80-5515022](#) [M80-5511422](#) [M80-5510622](#) [M80-5512042](#) [M80-5512642](#) [M80-5514422](#) [M80-5515042](#) [M80-5511442](#) [M80-5511042](#) [M80-5510642](#) [M80-5513442](#) [M80-5514242](#) [M80-5512022](#) [M80-5512622](#) [M80-5511222](#) [M80-5511242](#) [M80-5511822](#) [M80-5511842](#) [M80-5512605](#) [M80-5511805](#) [M80-5511642](#) [M80-5514442](#) [M80-5512442](#) [M80-5512422](#) [M80-5511622](#) [M80-5510605](#)