

RDE7U2E331J1K1H03B

In Production

RoHS

REACH

125 °C max.

Low acoustic noise

Deflecting crack

Soldering crack

Flow OK

Welding

Applications

Unsuitable Applications	Please be sure to read and comply with these "Precautions for use."
Specific Applications	Consumer equipment,Industrial Equipment,Mobile Electronics,Medical equipment [GHTF A/B/C] except for implant equipment,Automotive infotainment/comfort equipment Please refer to Our Website and specifications, etc. for information about the performance, functions, quality, management, and safety required for the above applications, and use Products after confirming the performance and reliability of the actual Product.

Appearance & Shape

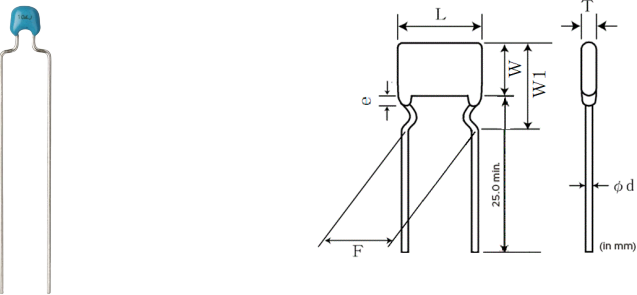

Notices

Halogen-free Products

References

Packaging	Specifications	Standard Packing Quantity
B	Bulk(Bag)	500

Mass (typ.)	
1 piece	0.11g

Attention

- 1.This datasheet is downloaded from the website of Murata Manufacturing Co., Ltd. Therefore, it's specifications are subject to change or our products in it may be discontinued without advance notice. Please check with our sales representatives or product engineers before ordering.
- 2.This datasheet has only typical specifications because there is no space for detailed specifications.
Therefore, please review our product specifications or consult the approval sheet for product specifications before ordering.

RDE7U2E331J1K1H03B



Specifications

L size or Outer diameter D	4.5mm max.
Width	3.5mm max.
T size	3.15mm max.
Lead spacing F	5.0±0.8mm
Lead diameter d	0.5±0.05mm
Paint dripping e	Up to the end of crimp
Capacitance	330pF ±5%
Rated voltage	250Vdc
Temperature characteristics	U2J(EIA)
Temperature range of temperature characteristics	-55°C to 125°C
Operating Temperature Range	-55°C to 125°C
TC	-55 to 25°C: -750+120/-347ppm/°C 25 to 125°C: -750±120ppm/°C
W1 size	5.0mm max.

Attention

- 1.This datasheet is downloaded from the website of Murata Manufacturing Co., Ltd. Therefore, it's specifications are subject to change or our products in it may be discontinued without advance notice. Please check with our sales representatives or product engineers before ordering.
- 2.This datasheet has only typical specifications because there is no space for detailed specifications.
Therefore, please review our product specifications or consult the approval sheet for product specifications before ordering.

RDE7U2E331J1K1H03B



Characteristic Data

The charts below may show another part number which shares its characteristics.

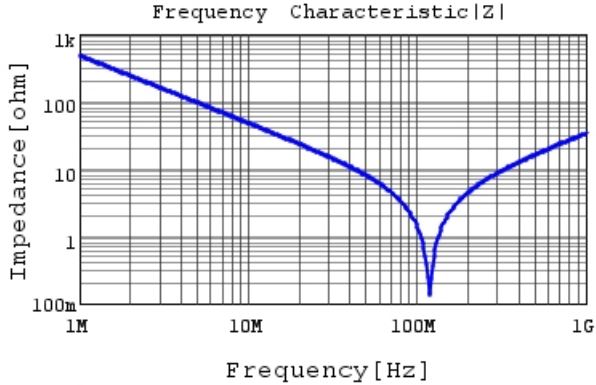

RDE7U2E331J1K1H03B |Z| DCOV, 25degC

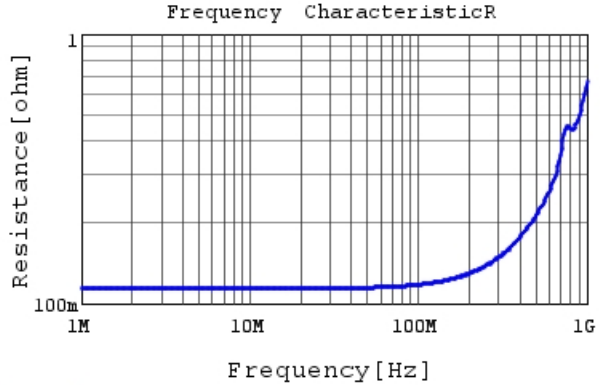

RDE7U2E331J1K1H03B R DCOV, 25degC

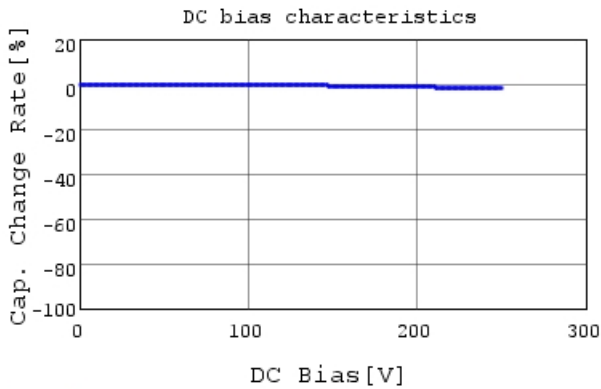

RDE7U2E331J1K1H03B C-DC bias capchange, 25.0

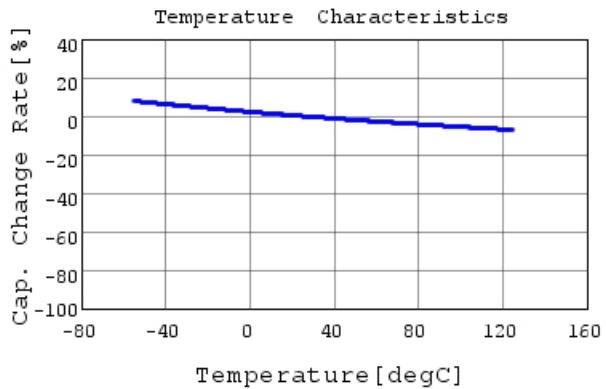

RDE7U2E331J1K1H03B C-Temp. capchange, DCOV,

Attention

- 1.This datasheet is downloaded from the website of Murata Manufacturing Co., Ltd. Therefore, it's specifications are subject to change or our products in it may be discontinued without advance notice. Please check with our sales representatives or product engineers before ordering.
- 2.This datasheet has only typical specifications because there is no space for detailed specifications.
Therefore, please review our product specifications or consult the approval sheet for product specifications before ordering.

RDE7U2E331J1K1H03B

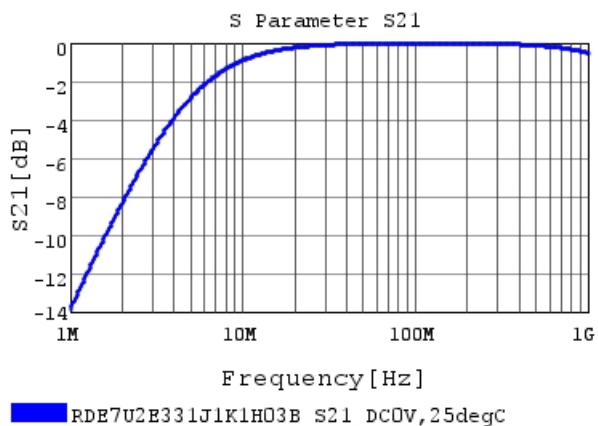

Attention

- 1.This datasheet is downloaded from the website of Murata Manufacturing Co., Ltd. Therefore, it's specifications are subject to change or our products in it may be discontinued without advance notice. Please check with our sales representatives or product engineers before ordering.
- 2.This datasheet has only typical specifications because there is no space for detailed specifications.
Therefore, please review our product specifications or consult the approval sheet for product specifications before ordering.