

1408313

<https://www.phoenixcontact.com/us/products/1408313>

Please be informed that the data shown in this PDF document is generated from our online catalog. Please find the complete data in the user documentation. Our general terms of use for downloads are valid.



HEAVYCON ADVANCE B32 sleeve housing, for increased environmental requirements, EMC conductive, with Allen screw locking, with 1 x M32/2 x M20 straight cable outlet

Commercial data

Item number	1408313
Packing unit	6 pc
Minimum order quantity	100 pc
Product key	BF7AAA
GTIN	4046356573276
Weight per piece (including packing)	629.616 g
Weight per piece (excluding packing)	629.616 g
Country of origin	DE

HC-B32-TMS-OSTM(32-20-20)G-EEE - Housing



1408313

<https://www.phoenixcontact.com/us/products/1408313>

Technical data

Notes

General	For contact inserts HC-B16, BB32, D40, DD72, HS6, HV6, M, K
---------	---

Product properties

Product type	Housing with screw locking
Housing type	Sleeve housing
Application	Offshore/EMC
Type	B32
No. of cable outlets	3
Type of the screw connection	1x M32 / 2x M20
Fixing screws	M6 (screw head: 5 mm Allen screw)
Cable outlet	straight
Pg screw connection	none

Connection data

Tightening torque	3 Nm (Locking screw)
-------------------	----------------------

Dimensions

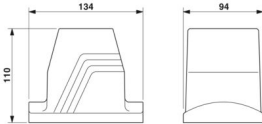
Dimensional drawing	
Width	94 mm
Height	100 mm
Length	126 mm

Installation dimensions

Width of the assembly cutout	70 mm
Length of the assembly cutout	84 mm

Material specifications

Seal material	NBR, conductive
Housing material	Die-cast aluminum, corrosion resistant
Housing surface material	uncoated
Locking latch material	Stainless steel

Environmental and real-life conditions

Ambient conditions

Degree of protection	IP66
	IP68 (0.2 bar/24 h)
	IP69K

HC-B32-TMS-OSTM(32-20-20)G-EEE - Housing



1408313

<https://www.phoenixcontact.com/us/products/1408313>

Enclosure rating (NEMA)	4 (NEMA 250)
	4X (NEMA 250)
	6P (NEMA 250)
	12 (NEMA 250)
Ambient temperature (operation)	-40 °C ... 125 °C

Mechanical properties

Mechanical data

Type of the screw connection	1x M32 / 2x M20
Locking type	Screw

Mounting

Assembly note	In order to guarantee that the protective conductor contact functions even when plugged in at an angle, the two panel-mount flanges must have sufficient electrical contact with the metal mounting panel.
	To ensure optimum shielding, any insulating power coating must be removed from the profile gasket area on the control cabinet panel. Tightening torque of locking screw: 3 Nm.
Fixing screws	M6 (screw head: 5 mm Allen screw)

Drawings

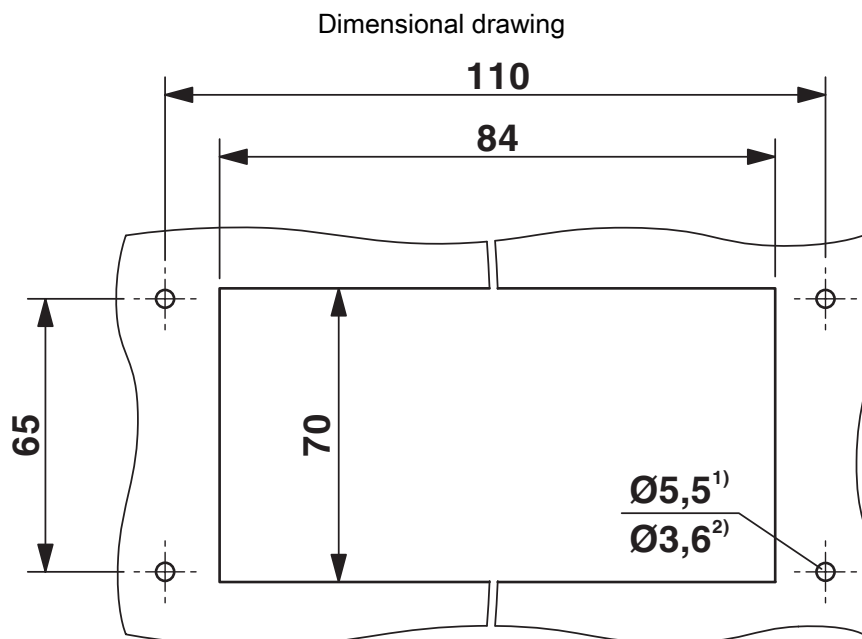

Panel cutout

²⁾ when self-tapping screws are used (Torx® 20, M4)

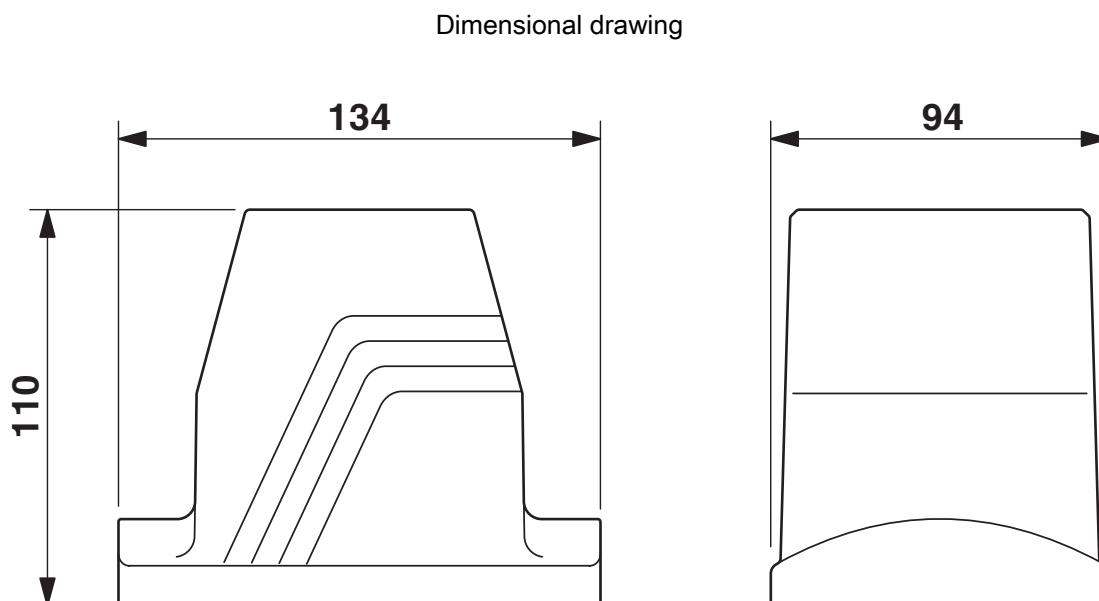

Dimensional drawing

HC-B32-TMS-OSTM(32-20-20)G-EEE - Housing

1408313

<https://www.phoenixcontact.com/us/products/1408313>



Classifications

ECLASS

ECLASS-11.0	27440202
ECLASS-13.0	27440202

HC-B32-TMS-OSTM(32-20-20)G-EEE - Housing



1408313

<https://www.phoenixcontact.com/us/products/1408313>

Environmental product compliance

EU REACH SVHC

REACH candidate substance (CAS No.)	No substance above 0.1 wt%
-------------------------------------	----------------------------

HC-B32-TMS-OSTM(32-20-20)G-EEE - Housing



1408313

<https://www.phoenixcontact.com/us/products/1408313>

Accessories

HC-B 32/48-AF - Panel-mount flange

1580524

<https://www.phoenixcontact.com/us/products/1580524>



HEAVYCON-ADVANCE mounting flange for screw locking HC B 32/48

HC-B 32-TMS-SD-IP65 - Protective cover

1580539

<https://www.phoenixcontact.com/us/products/1580539>



HEAVYCON ADVANCE B32 IP65 protective cover, for panel mounting side, screw locking with 2 Allen screws, with seal, 3 mm retaining cord eyelet

HC-B32-TMS-OSTM(32-20-20)G-EEE - Housing



1408313

<https://www.phoenixcontact.com/us/products/1408313>

HC-B-TMS-ERSSCHR-IMB - Screw

1409244

<https://www.phoenixcontact.com/us/products/1409244>



Replacement locking screw, M6, stainless steel, for HEAVYCON-ADVANCE housing, HC-B...TMS...EEE design, 5 mm Allen screw

SF-BIT-HEXB 5-89 - Screw insert

1208911

<https://www.phoenixcontact.com/us/products/1208911>



Screw bit, hexagonal with ball head, E6.3-1/4" drive, size: Hex 5 x 89 mm, hardened, suitable for holder according to DIN 3126-F 6.3/ISO 1173

HC-B32-TMS-OSTM(32-20-20)G-EEE - Housing

1408313

<https://www.phoenixcontact.com/us/products/1408313>



SF-M BH - Screwdriver

1212070

<https://www.phoenixcontact.com/us/products/1212070>



Bit screwdriver, with 1/4" quick-action chuck, handle length 119 mm, 2-component handle, with non-slip grip, suitable for bits according to DIN 3126-C 6.3 and E 6.3/ISO 1173, magnetic

Phoenix Contact 2024 © - all rights reserved

<https://www.phoenixcontact.com>

Phoenix Contact USA
586 Fulling Mill Road
Middletown, PA 17057, United States
(+717) 944-1300
info@phoenixcon.com