



PennEngineering
Corporate Headquarters – Danboro, PA
 5190 Old Easton Rd.
 Danboro, PA 18916
Phone: 215-766-8853
Toll-Free Phone: 1-800-237-4736 (U.S. only)
Email: info@pemnet.com
Website: www.pemnet.com

Part # MPP-2mm-4, PEM® Type MPP™ Self-clinching microPEM® Pins - Metric

PEM Type MPP, self-clinching microPEM® pins are ideal for today's compact electronic assemblies. Simply pressed into a properly sized mounting hole, these micro pins clinch permanently into place. They can be installed into a variety of sheet materials up to HRB 92/HB 195 in hardness and they offer excellent corrosion resistance.

Features and Benefits

- Satisfy demanding micro positioning and alignment applications.
- Head mounts flush into panels as thin as 0.5mm.
- Chamfered end makes mating hole

[+ more](#)

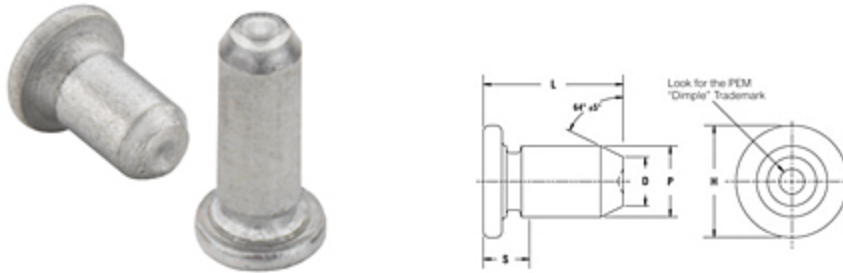

Specifications

Pin Diameter P ± 0.038	2.00 mm
	4 mm
L - Length ± 0.15	
Min. Sheet Thickness	0.50 mm
Hole Size in Sheet + 0.025	2.05 mm
D ± 0.1	1.36 mm
H ± 0.25	3.02 mm
S Max.¹	0.70 mm
Min. Dist. Hole C/L to Edge	4.40 mm

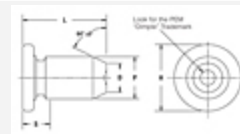

Anvil Length	7.18 mm
For Use in Sheet Hardness²	HRB 92 / HB 195 or Less
Fastener Material	Age Hardened A286 Stainless Steel
Standard Finish	Passivated per ASTM A380 and/or tested
CAD Supplier	PennEngineering® (PEM®)

¹ Pin diameter may exceed max. in this region.

² HRB - Hardness Rockwell “B” Scale. HB - Hardness Brinell