

# Indicator

17-221350

Distribution by  
DigiKey

**DigiKey**



<https://digikey.eao.com/p/17-221350>

Your product:

---



## 17-221350 Indicator

### FRONT

<b>Front form:</b>	round
<b>Front dimension:</b>	Ø 16 mm
<b>Reflector:</b>	Metal, black chromium-plated

### MOUNTING

<b>Mounting type:</b>	Panel mounting
<b>Mounting cut-out:</b>	Ø 14 mm
<b>Design:</b>	raised

### OPERATING-/INDICATION PART

<b>Illumination colour:</b>	Red
-----------------------------	-----

### ELECTRICAL CHARACTERISTICS

<b>Polarity:</b>	Anode (+) Brass plug-in connector Cathode (-) Brass tinned plug-in connector
<b>Operating voltage:</b>	24 V DC $\pm 10\%$
<b>Lumi. Intensity:</b>	100 mcd
<b>Operation current:</b>	9 - 17 mA $\pm 15\%$

### MECHANICAL CHARATERISTIC

**Weight:** 0.014 kg

**Tightening torque:** Fixing nut max. 0.2 Nm

**Terminal:** Plug-in terminal, 2.8 x 0.8 mm

#### AMBIENT CONDITION

**Operating temperature:** - 20 °C ... + 60 °C

**IP Protection:** IP40 front side, IP65 front side, according to IEC 60529

**Storage temperature:** - 25 °C ... + 80 °C

#### CERTIFICATE

**Approbations:** UL

**Conformities:** 2011 / 65 / EC (RoHS), 2014 / 35 / EU (230 VAC)

#### OTHER

**Hints:** Connectors: Brass terminal = anode (+); brass tinned terminal = cathode (-), IP67 front side gap between LED and reflector and gap between reflector and frontplate sealed to IP67 when using the supplied gasket., The plastic is limited resistant to chemicals.

**Kind of illumination:** Single-LED

**Short Description:** Actuator, Ø 14 mm, Ø 16 mm, round, Plug-in terminal, 2.8 x 0.8 mm, Red

**Mounting cut-outs:**

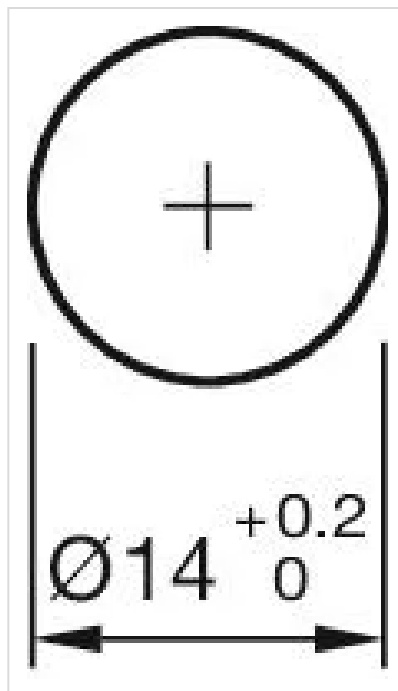

### Dimension drawings:

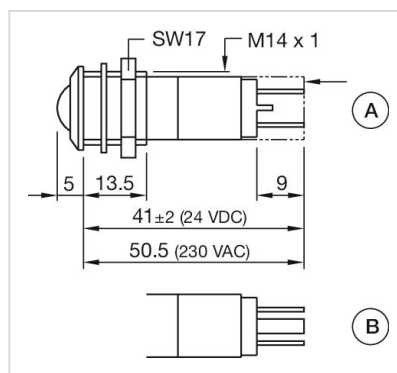

A = Protection tube (only 230 VAC)

B = Tri-colour

### Wiring diagrams:

