

EV-TAM3PC-1AC32A-5,0M6,0ESBK00 - AC charging cable



1623148
<https://www.phoenixcontact.com/us/products/1623148>

Please be informed that the data shown in this PDF document is generated from our online catalog. Please find the complete data in the user documentation. Our general terms of use for downloads are valid.

CHARX connect, Mobile AC charging cable with vehicle connector and infrastructure plug, with protective cap, Type 1, Type 2, IEC 62196-2, SAE J1772, cable: 5 m, straight



Product description

Mobile AC charging cable with vehicle charging connector and infrastructure charging plug for charging electric vehicles (EV) with alternating current (AC) via type 1 vehicle charging inlets, compatible with type 2 infrastructure charging sockets at charging stations for e-mobility (EVSE)

Your advantages

- Consistent design of all Phoenix Contact Vehicle Connectors and Infrastructure Plugs
- Silver-plated surface of the power and signal contacts
- Developed and produced in accordance with the IATF 16949 automotive standard and ISO 9001
- Convenient handling, thanks to the ergonomic handle and additional, rubber grip components

Commercial data

Item number	1623148
Packing unit	1 pc
Minimum order quantity	1 pc
Product key	XWBAEE
Catalog page	Page 744 (C-2-2017)
GTIN	4055626130620
Weight per piece (including packing)	2.56 kg
Weight per piece (excluding packing)	2.46 kg
Country of origin	DE

EV-TAM3PC-1AC32A-5,0M6,0ESBK00 - AC charging cable



1623148

<https://www.phoenixcontact.com/us/products/1623148>

Technical data

Product properties

Product type	AC charging cable
Product family	CHARX connect
Application	Mobile AC charging cable with vehicle connector and infrastructure plug, with protective cap
Charging mode	Mode 3, Case B
Charging standard	Type 1
	Type 2

Electrical properties

Type of charging current	AC single-phase
Charging power	8 kW
Charging current	32 A

Cable/line

Cable length	5 m
Wiring standards/regulations	prEN 50620/DIN EN 50620
Wiring certifications	VDE
Cable weight	max. 305.00 kg/km
Cable type	Class 5
Cable type	straight
Cable structure	3 x 6.0 mm ² + 1 x 0.5 mm ²
External cable diameter	12.80 mm ±0.4 mm
Outer sheath, material	TPE-U
Cable resistance	≤ 0.0033 Ω/m (based on a power core, at an ambient temperature of 20°C)
Bending radius	min. 96 mm (7.5x diameter)
Cable length	5 m
External cable diameter	12.80 mm ±0.4 mm
Cable type	Class 5
Wiring certifications	VDE
Wiring standards/regulations	prEN 50620/DIN EN 50620
Cable resistance	≤ 0.0033 Ω/m (based on a power core, at an ambient temperature of 20°C)

Standards and regulations

Standards

Standards/regulations	IEC 62196-2
	SAE J1772

EV-TAM3PC-1AC32A-5,0M6,0ESBK00 - AC charging cable



1623148

<https://www.phoenixcontact.com/us/products/1623148>

Drawings

Dimensional drawing

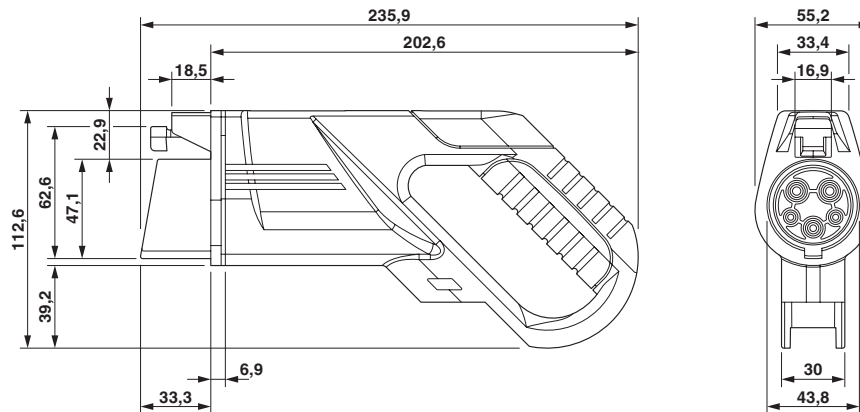

Vehicle connector

Connection diagram

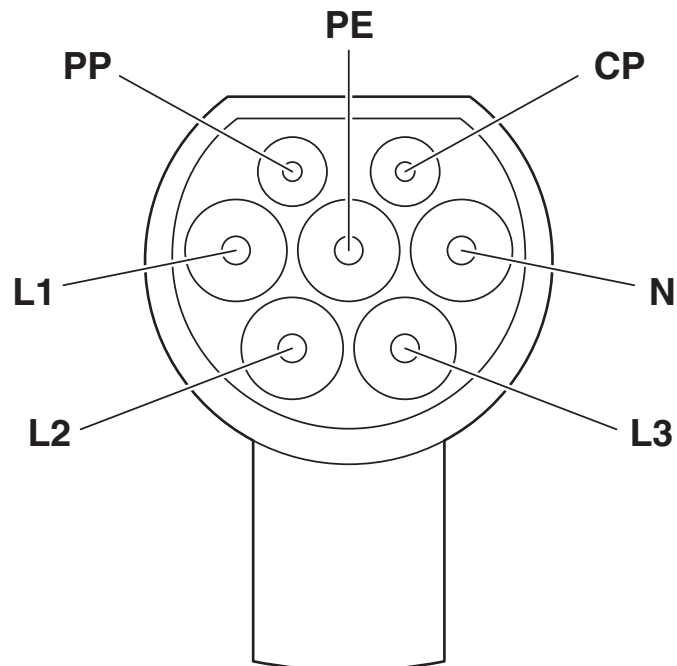

Pin assignment of Infrastructure Plug

EV-TAM3PC-1AC32A-5,0M6,0ESBK00 - AC charging cable



1623148

<https://www.phoenixcontact.com/us/products/1623148>

Schematic diagram

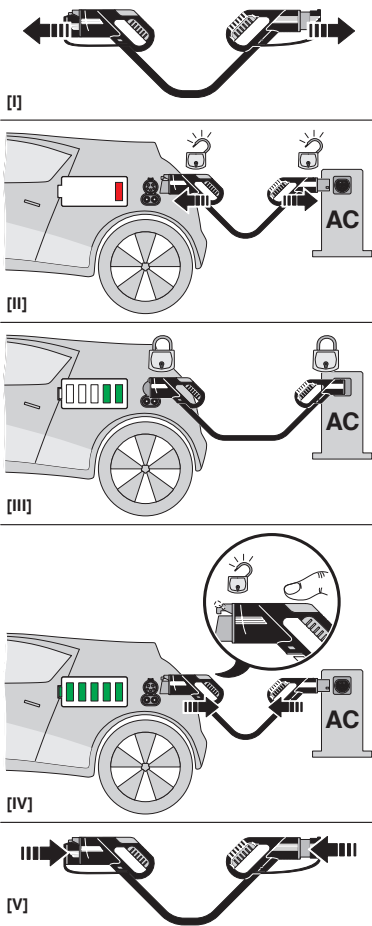

Operating instructions

Dimensional drawing

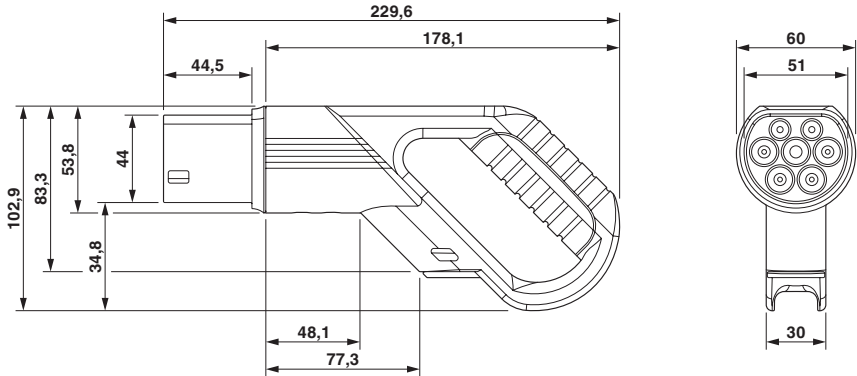

Infrastructure plug

EV-TAM3PC-1AC32A-5,0M6,0ESBK00 - AC charging cable

1623148

<https://www.phoenixcontact.com/us/products/1623148>

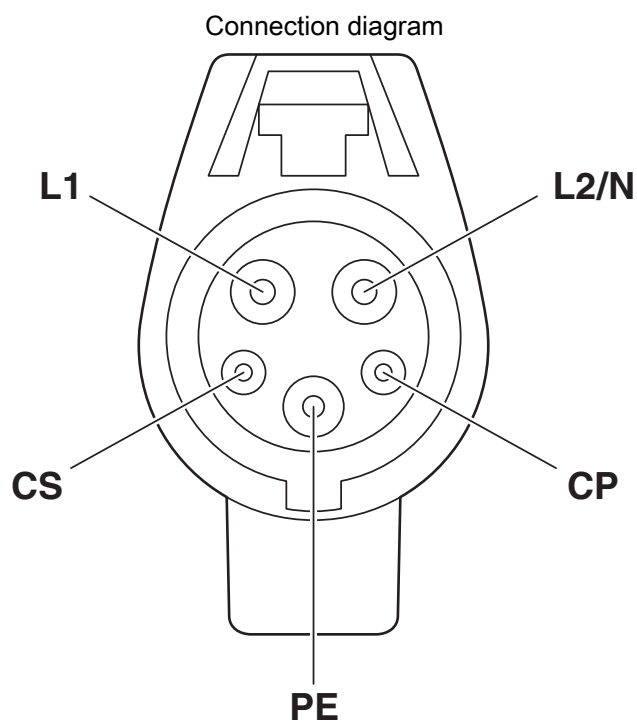

Pin assignment of the Vehicle Connector

EV-TAM3PC-1AC32A-5,0M6,0ESBK00 - AC charging cable



1623148
<https://www.phoenixcontact.com/us/products/1623148>

Environmental product compliance

China RoHS	
Environment friendly use period (EFUP)	<div>EFUP-10</div> <div>An article-related China RoHS declaration table can be found in the download area for the respective article under "Manufacturer declaration". For all articles with EFUP-E, no China RoHS declaration table issued and required.</div>
EU REACH SVHC	
REACH candidate substance (CAS No.)	No substance above 0.1 wt%

EV-TAM3PC-1AC32A-5,0M6,0ESBK00 - AC charging cable



1623148

<https://www.phoenixcontact.com/us/products/1623148>

Accessories

EV-T1AC-PARK - Charging connector holder

1624139

<https://www.phoenixcontact.com/us/products/1624139>



CHARX connect, Charging connector holder, Accessories, for vehicle charging connectors on charging stations (EVSE), Type 1, SAE J1772, Front mounting, housing: black

EV-T2M3SE24-3AC32A-0,7M6,0E10 - Infrastructure charging socket

1405216

<https://www.phoenixcontact.com/us/products/1405216>



CHARX connect, Infrastructure charging socket, for charging electric vehicles (EV) with alternating current (AC), Type 2, IEC 62196-2, 32 A / 480 V (AC), Single wires, length: 0.7 m, locking actuator: 24 V, 4-pos., Rear panel mounting, PHOENIX CONTACT logo

Phoenix Contact 2024 © - all rights reserved

<https://www.phoenixcontact.com>

Phoenix Contact USA
586 Fulling Mill Road
Middletown, PA 17057, United States
(+717) 944-1300
info@phoenixcon.com