

Indicator

17-000352

Distribution by
DigiKey**DigiKey**<https://digikey.eao.com/p/17-000352>

Your product:



17-000352 Indicator

FRONT

Front form:	round
Reflector:	Metal, polished chromium-plated, flat top LED
Front dimension:	Ø 7 mm

MOUNTING

Design:	raised
Mounting type:	Panel mounting
Mounting cut-out:	Ø 6 mm

OPERATING-/INDICATION PART

Illumination colour:	Yellow
-----------------------------	--------

ELECTRICAL CHARACTERISTICS

Lumi. Intensity:	6 mcd
Operation current:	15 mA \pm 15 %
Operating voltage:	24 V AC/DC \pm 10 %
Polarity:	Anode (+) Brass plug-in connector Cathode (-) Brass tinned plug-in connector

MECHANICAL CHARATERISTIC

Terminal:	Plug-in terminal, 2 x 0.5 mm
Weight:	0.003 kg
Tightening torque:	Fixing nut max. 0.2 Nm

AMBIENT CONDITION

Storage temperature:	– 25 °C ... + 80 °C
Operating temperature:	– 20 °C ... + 60 °C
IP Protection:	IP40 front side, IP65 front side, according to IEC 60529

CERTIFICATE

Approbations:	UL
Conformities:	2011 / 65 / EC (RoHS), 2014 / 35 / EU (230 VAC)
REACH:	REACH compliant
RoHS:	RoHS compliant

OTHER

Kind of illumination:	Single-LED
Hints:	Connectors: Brass terminal = anode (+); brass tinned terminal = cathode (-), IP67 front side gap between LED and reflector and gap between reflector and frontplate sealed to IP67 when using the supplied gasket., The plastic is limited resistant to chemicals.
Short Description:	Indicator, Ø 6 mm, Ø 7 mm, round, Plug-in terminal, 2 x 0.5 mm, Yellow
Mounting cut-outs:	

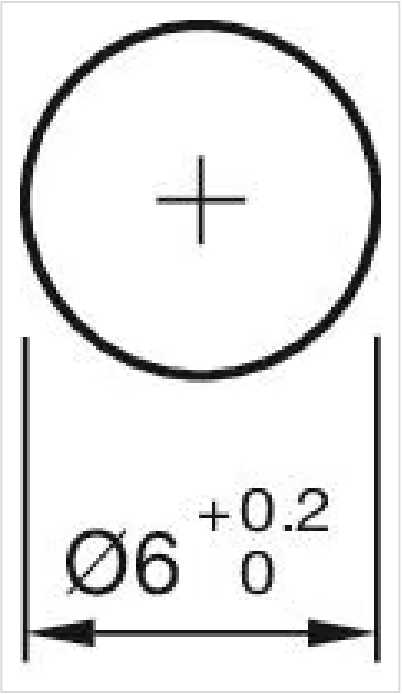

Dimension drawings:

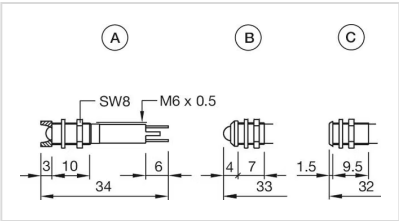

A = interior
B = exterior
C = superflat

Wiring diagrams:

