

Actuator

17-
2A035W

Distribution by
DigiKey

DigiKey



<https://digikey.eao.com/p/17-2A035W>

Your product:



17-2A035W Actuator

FRONT

Front dimension:	Ø 16 mm
Front form:	round
Reflector:	Metal, polished chromium-plated

MOUNTING

Design:	raised
Mounting cut-out:	Ø 14 mm

OPERATING-/INDICATION PART

Illumination colour:	White
----------------------	-------

ELECTRICAL CHARACTERISTICS

Operation current:	9 - 17 mA \pm 15 %
Lumi. Intensity:	1350 mcd
Polarity:	Anode (+) Brass plug-in connector Cathode (-) Brass tinned plug-in connector
Operating voltage:	24 V AC/DC

MECHANICAL CHARACTERISTIC

Tightening torque:	Fixing nut max. 0.2 Nm
Weight:	0.014 kg
Terminal:	Plug-in terminal, 2.8 x 0.8 mm

AMBIENT CONDITION

Operating temperature: – 20 °C ... + 60 °C

Storage temperature: – 25 °C ... + 80 °C

IP Protection: IP40 front side, IP65 front side, according to IEC 60529

CERTIFICATE

Conformities: 2011 / 65 / EC (RoHS), 2014 / 35 / EU (230 VAC)

Approbations: UL

OTHER

Short Description: Actuator, Ø 14 mm, Ø 16 mm, round, Plug-in terminal, 2.8 x 0.8 mm, White

Hints: Connectors: Brass terminal = anode (+); brass tinned terminal = cathode (-), IP67 front side gap between LED and reflector and gap between reflector and frontplate sealed to IP67 when using the supplied gasket., The plastic is limited resistant to chemicals.

Kind of illumination: Single-LED

Dimension drawings:

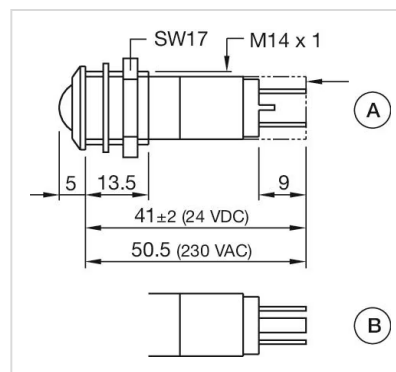

A = Protection tube (only 230 VAC)
B = Tri-colour

Mounting cut-outs:

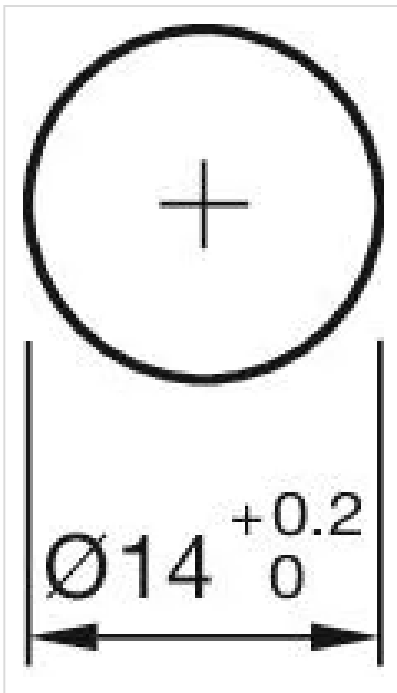

Wiring diagrams:

