

1 2 3 4 5 6 7 8 9 10

RoHS

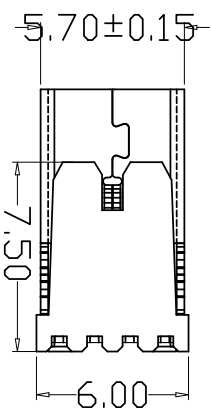
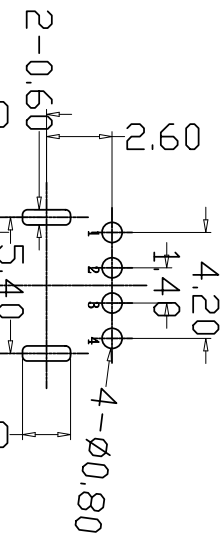
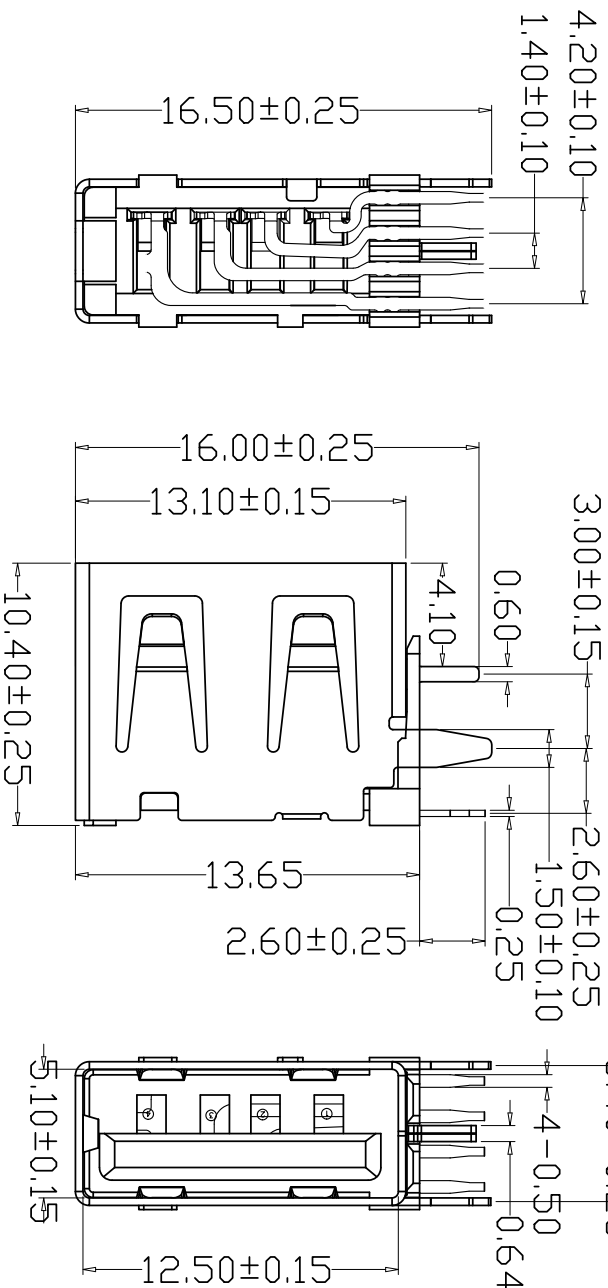
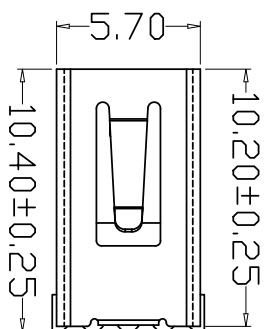

MAPX	MODIFICATION	DRW	DATE

电气特性:Electrical:

1. 额定电流: Current Rating

1. 5A/contact terminal

2. 额定电压: Voltage Rating

30V DC

3. 接触电阻: Contact Resistance

30 milliohms MAX

4. 耐电压: Dielectric Withstanding Voltage:

500 V AC AT Sea Level

5. 绝缘电阻: Insulation Resistance:

1000MEGA ohms MIN

物理性能:Mechanical:

1. 插拔力: Connector Mate and Unmate Force

Mate force:3.57kgf (MAX)

Unmate force:1.02kgf (MIN)

2. 端子保持力: Terminal Retention

1.0kgf (MIN)

3. 寿命: 1500次

原材料:Material:

1. 塑胶:Housing:PBT/LCP

2. 端子:Contact:Copper Alloy C2680

3. 外壳:Shell:SPCC/C2680

电镀:Finish:

1. 端子Contact: Au G/Fu" Plated on contact area

Tin50u" Plated on solder area

Nickel 50u" Plated underplating over all.

2. 外壳Shell: Nickel 50u" Min plating over all.

产品图

公差一览表

TOLERANCE DIMENSION

公差	公差	公差	公差
X	±0.35	X	±5.°
X	±0.30	X	±2.°
.XX	±0.25	.XX	±1.°
.XXX	±0.05	.XXX	±0.5°

深圳市精拓金电子有限公司
Shenzhen Jing Tuo Jin Electronics Co., Ltd.

单位: MM 制图: L-S-S 制图料号: 906-162A1024D10200

比例: 1:1 审核: 郭治富 产品名称: AP10.0侧插短体三直脚无边

日期: 2021-03-10 核准: 黄国荣 产品图章: 铜壳PBT黑胶

日期: 2022-03-10 核准: 黄国荣 版本: A0

RECOMMENDED PCB LAYOUT
GENERAL TOLERANCES: ±0.05

您正在使用 ZWCAD 2022 个人版, 不得用于商业用途, 详情请咨询 4007-482-588。