

- Computer with DisplayPort 1.2-compatible graphics card (e.g. AMD Radeon with AMD Eyefinity) required for video wall mode. Backward compatible with most DisplayPort 1.1a equipment running current graphics drivers with feature set limited to that of your equipment. Compatibility with older graphics cards not guaranteed.
- Maximum supported video resolutions and number of monitors depend on your graphics card. Check graphics card specifications to determine its capabilities.

## 3-Port Mini DisplayPort 1.2 to DisplayPort MST Hub 4K, 3840 x 2160 (4K x 2K) UHD, TAA

MODEL NUMBER: **B155-003-DP-V2**

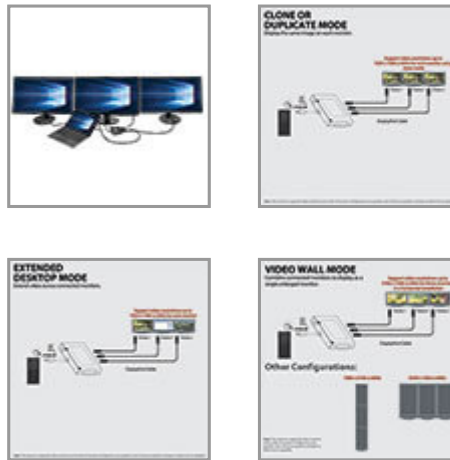

### Description

The B155-003-DP-V2 3-Port Mini DisplayPort 1.2 to DisplayPort MST Hub 4K connects up to three DisplayPort monitors to the Mini DisplayPort output on your computer. Ideal for digital signage in schools, churches, conference rooms, trade shows, hotels and retail outlets, this hub allows you to display the same image on all three monitors, extend the desktop across them, or combine all three as one large monitor in video wall mode.

The B155-003-DP-V2 is compliant with DisplayPort 1.2 and backward compatible with versions 1.1 and 1.1a with the feature set being limited to that of your equipment. It supports Ultra High Definition (UHD) video resolutions up to 3840 x 2160 (4K x 2K) at 24/30 Hz. In video wall mode, it supports expanded resolutions, such as 5760 x 1080 in a horizontal 1 x 3 monitor configuration or 1920 x 3240 in a vertical 3 x 1 configuration.

This Multi-Stream Transport (MST) hub also supports HDCP, EDID, DDC and 48-bit Deep Color (16 bits per channel), as well as DTS-HD, Dolby TrueHD and 7.1-channel surround sound audio. It works with all operating systems. Plug-and-play convenience means no software or drivers are needed. A built-in six-inch cable connects directly to a Mini DisplayPort source. LEDs indicate when the monitors are receiving a signal. The B155-003-DP-V2 complies with the Federal Trade Agreements Act (TAA) for GSA Schedule purchases.

### Highlights

- Supports UHD video resolutions up to 3840 x 2160 (4K x 2K)
- Built-in 6 in. cable connects directly to Mini DisplayPort source
- Supports up to 48-bit Deep Color (16 bits per channel)
- Works with all operating systems
- Supports DTS-HD, Dolby TrueHD and 7.1-channel surround sound

### System Requirements

- Computer with DisplayPort 1.2-compatible graphics card (e.g. AMD Radeon with AMD Eyefinity) required for video wall mode
- Backward compatible with most DisplayPort 1.1a equipment running current graphics drivers with feature set limited to that of your equipment. Compatibility with older graphics cards not guaranteed.
- Mac OS X does not support MST for NVIDIA and Intel Graphics Processor Units, limiting video display on connected monitors to mirror mode.
- Maximum supported video resolutions and number of monitors depend on your graphics card. Check graphics card specifications to determine its capabilities.



**Tripp Lite**  
1111 W. 35th Street  
Chicago, IL 60609 USA  
Telephone: 773.869.1234  
www.triplite.com

## Features

Connects Up to 3 DisplayPort Monitors to Your Computer's Mini DisplayPort (MDP)

- Ideal for digital signs in schools, churches, conference rooms, trade shows and retail settings
- Displays same image on 3 monitors simultaneously in mirror mode
- Extends desktop across 3 monitors in extended mode
- Combines 3 monitors into one large monitor in video wall mode
- Built-in 6 in. cable connects directly to Mini DisplayPort source
- LEDs indicate when monitors are receiving a signal

Meets the Latest Performance Standards

- Supports UHD video resolutions up to 3840 x 2160 (4K x 2K) @ 24/30 Hz
- Supports expanded resolutions in video wall mode, such as 5760 x 1080 in horizontal 1 x 3 configuration
- Supports HDCP, EDID and DDC
- Supports 48-bit Deep Color (16 bits per channel)
- Supports DTS-HD, Dolby TrueHD and 7.1-channel surround sound audio

Easy to Use Almost Anywhere

- Works with all operating systems
- Plug and play—no software or drivers required

TAA Compliant

- Complies with Federal Trade Agreements Act (TAA) for GSA Schedule purchases

- Monitor with DisplayPort input

## Package Includes

- B155-003-DP-V2 3-Port Mini DisplayPort 1.2 to DisplayPort MST Hub 4K
- External power supply with NEMA 1-15P plug and 5 ft. cord (Input: 100–240V, 50/60 Hz, 0.5A; Output: 5V, 2A)
- Owner's manual

## Specifications

MODEL TEXT	
What Does This Product Do?	Displays the same image on 3 DisplayPort monitors, extends the desktop across both, or combines both into one large monitor. Ideal for digital signage in schools, churches, conference rooms, trade shows and retail outlets.
OVERVIEW	
AC Adapter	Input: 100-240V, 50/60Hz, 0.5A; Output: 5V, 2A, 5 ft.
PHYSICAL	
Unit Dimensions (hwd / in.)	0.94 x 4.3 x 3
Unit Dimensions (hwd / cm)	2.4 x 10.9 x 7.62
Unit Weight (lbs.)	0.25
Unit Weight (kg)	0.11
Color	Black



**Tripp Lite**  
1111 W. 35th Street  
Chicago, IL 60609 USA  
Telephone: 773.869.1234  
[www.tripplite.com](http://www.tripplite.com)

CONNECTIONS	
Ports	3
Side A - Connector 1	MINI DISPLAYPORT (MALE)
Side B - Connector 1	(3) DISPLAYPORT (FEMALE)
CERTIFICATIONS	
Approvals	CE, FCC, RoHS, and REACH
WARRANTY	
Product Warranty Period (Worldwide)	3-year limited warranty

© 2018 Tripp Lite. All rights reserved. All product and company names are trademarks or registered trademarks of their respective holders. Use of them does not imply any affiliation with or endorsement by them. Tripp Lite has a policy of continuous improvement. Specifications are subject to change without notice. Tripp Lite uses primary and third-party agencies to test its products for compliance with standards. See a list of Tripp Lite's testing agencies: <https://www.tripplite.com/products/product-certification-agencies>