

## TYPE 931-SLS

3.5 mm spacing - 2 to 16 poles

Series	Download PDF	Download DXF	Can plug with	How to order	Color specifications	Print
--------	--------------	--------------	---------------	--------------	----------------------	-------



931-SLS

One possible variation of assembly

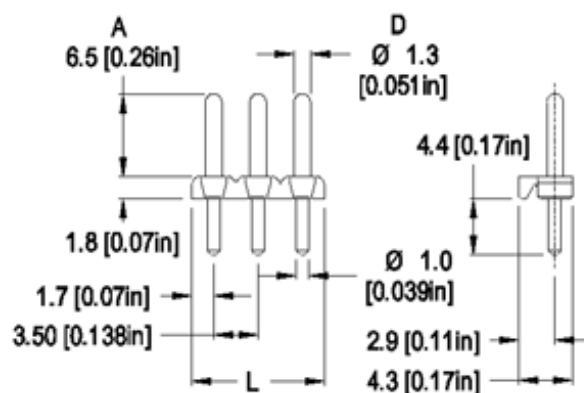

Dimensions: mm (in.)

Length of Connector (L)

L = No. of Poles x Center to Center Spacing

Length of Pinstrip (L)

L = No. of Poles x Center to Center Spacing

Other options:

In 1.10 mm diameter (D), the following protruding lengths (A) are available: 7.8, 10.3, 11.0, 11.7, 11.9, 12.5, 14.2, 14.7 and 15.7 mm.

In 1.15 mm diameter (D), the following protruding lengths (A) are available: 6.5 and 14.7 mm.

In 1.30 mm diameter (D), the following protruding lengths (A) are available: 6.5, 7.2, 7.7, 7.8, 8.5, 10.5, 11.0, 16.5, 19.8, 21.5, 22.0 and 29.0 mm.

## Description

- Pinstrip
- Plug-In Direction Perpendicular to PCB and Wire Entrance Parallel to PCB when plugged with **930-FL (-DS)** **938-FL (-DS)**

## Technical Data

**Center to Center Spacing:** 3.5 mm (0.138 in.)

**Recommended Hole Diameter in PC Board:**

1.3 mm (0.051 in.) for 1.0 mm (0.039 in.) pin (standard) 1.4 mm (0.055 in.) for 1.1 mm (0.043 in.) pin (limited options) 1.6 mm (0.063 in.) for 1.3 mm (0.051 in.) pin (limited options)

## Application

## Approval Information

UL File No.E69841

CSA File No.LR24322



Rating	Current(A)	Voltage(V)	Application group	AWG
UL	6	300	B,C	
CSA	6	300	B	

## International Approvals:



## International Approvals Notes:

ROHS WEEE Pb free compliant.

## Material

This can be plugged with the 930-FL (-DS) or 938-FL (-DS), Entry of the pin can be on top side or on the bottom of these plugs. You can stack the plug on top of each other when used with extra long pins on the 931-SLS strips. You can choose your pin length depending on the insertion forces or extraction forces required.

**Molding:** PBT GF, self extinguishing to UL 94, V-0, color black  
**Temperature limits:**  
**Short Time:** 200C (392F)  
**Continuous:** RTI 105C (221F)  
**Low Limit:** -40C (-40F)  
**Comparative Tracking Index:** CTI > 175  
**Oxygen Index Rating:** 32%

**Solder Pin:** PCB end: 1 mm (0.039 in.) or 1.1 (0,043 in.), plug-in end: 1.1 mm (0.043 in.), 1.15 (0.045 in.) and 1.3 mm (0.051 in.), tin plated copper alloy

 [Top of page](#)

How to order

Item 931-SLS

Options

- Gold Plating (5 micro inches)
- Gold Plating (30 micro inches)
- Silver Plating (30 micro inches)
- Pin length 10.5 mm (0.413 in.)
- Pin length 16.5 mm (0.649 in.)
- Pin length 19.8 mm (0.779 in.)

**Note:** Plated component: solder pin

**Ordering Note:** To order alternate pin lengths and diameters please download the PDF file above.

[Request sample](#)  
[Request quote](#)  
[Place order](#)

Quantity

931-SLS/

POLES:  
02 to 16

[Add to shopping cart](#)