

Actuator

17-210350

Distribution by
DigiKey**DigiKey**<https://digikey.eao.com/p/17-210350>

Your product:



17-210350 Actuator

FRONT

Front form:	round
Reflector:	Metal, polished chromium-plated
Front dimension:	Ø 16 mm

MOUNTING

Mounting cut-out:	Ø 14 mm
Design:	raised

OPERATING-/INDICATION PART

Illumination colour:	Red
----------------------	-----

ELECTRICAL CHARACTERISTICS

Operation current:	20 mA \pm 15 %
Polarity:	Anode (+) Brass plug-in connector Cathode (-) Brass tinned plug-in connector
Operating voltage:	24 V DC \pm 10 %
Lumi. Intensity:	150 mcd

MECHANICAL CHARACTERISTIC

Weight:	0.014 kg
Tightening torque:	Fixing nut max. 0.2 Nm
Terminal:	Plug-in terminal, 2.8 x 0.8 mm

AMBIENT CONDITION

Storage temperature: – 25 °C ... + 80 °C

Operating temperature: – 20 °C ... + 60 °C

IP Protection: IP40 front side, IP65 front side, according to IEC 60529

CERTIFICATE

Approbations: UL

Conformities: 2011 / 65 / EC (RoHS), 2014 / 35 / EU (230 VAC)

OTHER

Kind of illumination: Single-LED

Short Description: Actuator, Ø 14 mm, Ø 16 mm, round, Plug-in terminal, 2.8 x 0.8 mm, Red

Hints: Connectors: Brass terminal = anode (+); brass tinned terminal = cathode (-), IP67 front side gap between LED and reflector and gap between reflector and frontplate sealed to IP67 when using the supplied gasket., The plastic is limited resistant to chemicals.

Wiring diagrams:

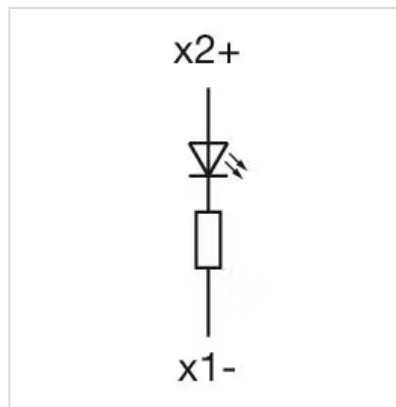

Mounting cut-outs:

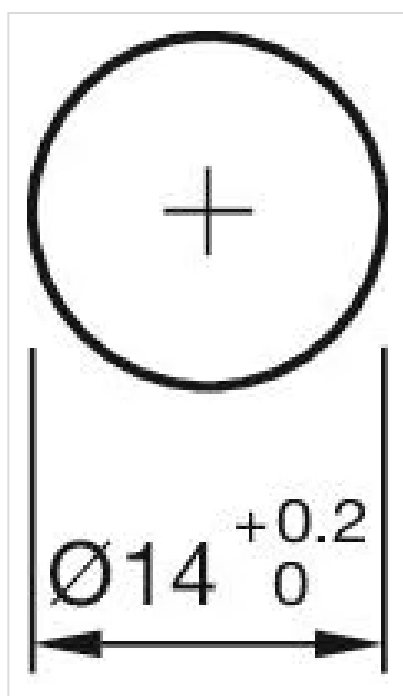

Dimension drawings:

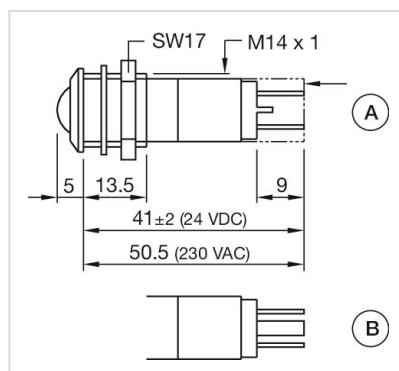

A = Protection tube (only 230 VAC)
B = Tri-colour