

PCB terminal block - PTE 1,5/ 2-7,5 EU - 1709231

Please be informed that the data shown in this PDF Document is generated from our Online Catalog. Please find the complete data in the user's documentation. Our General Terms of Use for Downloads are valid (<http://phoenixcontact.com/download>)



PCB terminal block, Nominal current: 2 A, Nom. voltage: 400 V, Pitch: 7.5 mm, Number of positions: 2, Connection method: Screw connection with tension sleeve, Mounting: Wave soldering, Conductor/PCB connection direction: 0 °, Color: black, For special applications, a rated insulation voltage of 250 V at a rated surge voltage of 1 kV is also possible according to overvoltage category IV and degree of pollution 3.

Why buy this product



Key Commercial Data

Packing unit	1
GTIN	
GTIN	4055626053318
Custom tariff number	85369010

Technical data

Environmental Product Compliance

China RoHS	Environmentally Friendly Use Period = 50
	For details about hazardous substances go to tab "Downloads", Category "Manufacturer's declaration"

Drawings

PCB terminal block - PTE 1,5/ 2-7,5 EU - 1709231

Drilling diagram

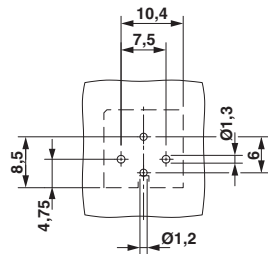

Dimensional drawing

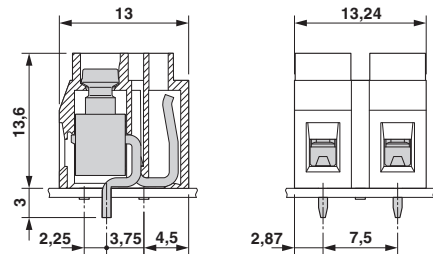

Classifications

eCl@ss

eCl@ss 5.1	27141190
eCl@ss 6.0	27261101
eCl@ss 8.0	27440401
eCl@ss 9.0	27440401

ETIM

ETIM 5.0	EC002643
----------	----------

Approvals

Approvals

Approvals

EAC

Ex Approvals

Approval details

EAC B.01742

Accessories

Accessories

Screwdriver tools

PCB terminal block - PTE 1,5/ 2-7,5 EU - 1709231

Accessories

Screwdriver - SZS 0,6X3,5 - 1205053



Actuation tool, for ST terminal blocks, insulated, also suitable for use as a bladed screwdriver, size: 0.6 x 3.5 x 100 mm, 2-component grip, with non-slip grip