

FEMALE FACE VIEWS

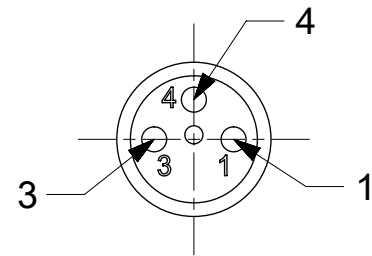

1 - BROWN
3 - BLUE
4 - BLACK

3 POLE

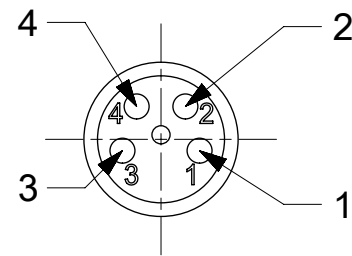

1 - BROWN
2 - WHITE
3 - BLUE
4 - BLACK

4 POLE

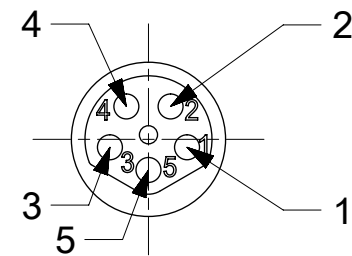

1 - BROWN
2 - WHITE
3 - BLUE
4 - BLACK
5 - GRAY

5 POLE

443030H08M030

POLES: 3, 4 & 5

LENGTH

M001 = .1 METERS

M010 = 1.0 METERS

M100 = 10 METERS

PART NUMBER LEGEND

MALE FACE VIEWS

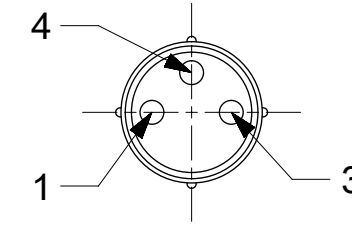

1 - BROWN
3 - BLUE
4 - BLACK

3 POLE

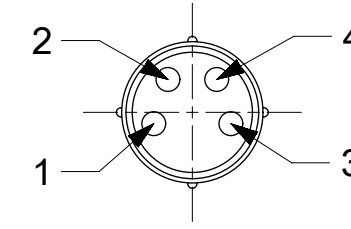

1 - BROWN
2 - WHITE
3 - BLUE
4 - BLACK

4 POLE

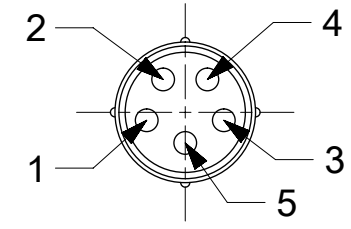

1 - BROWN
2 - WHITE
3 - BLUE
4 - BLACK
5 - GRAY

5 POLE

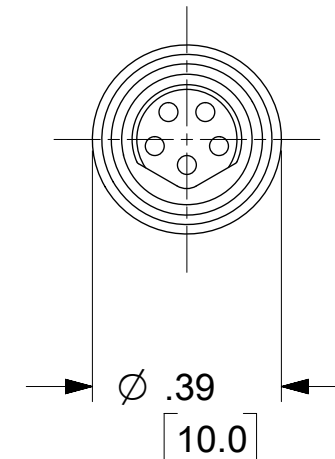
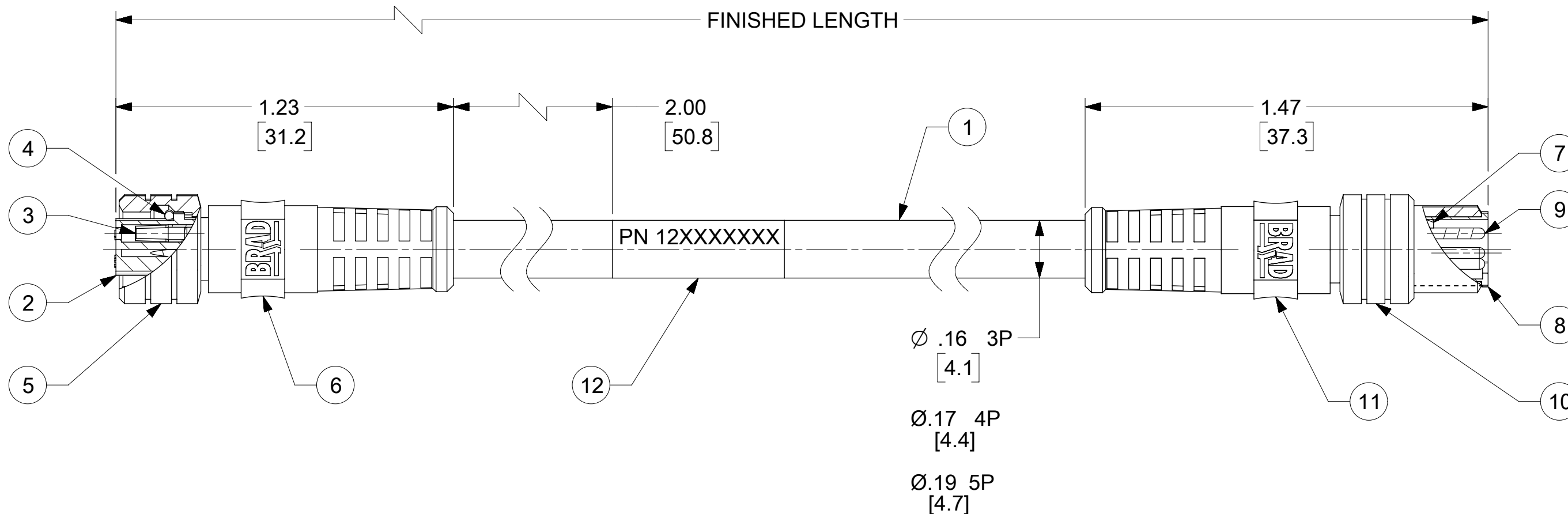
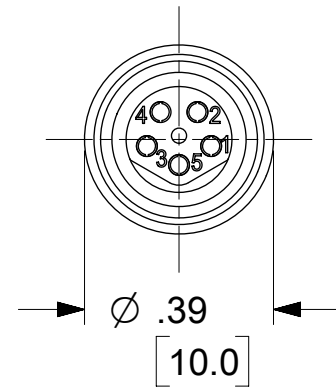

12	FLAG LABEL	VINYL	BLACK/YELLOW
11	OVERMOLD	TPC	YELLOW
10	COUPLING, MALE	BRASS	NICKEL PLATED
9	CONTACT PIN	Cu ALLOY	GOLD PLATED.
8	SLEEVE	BRASS	NICKEL PLATE
7	INSERT, MALE	PUR	BLACK
6	OVERMOLD, FEMALE	TPC	YELLOW
5	COUPLING, FEMALE	BRASS	NICKET PLATED
4	O-RING	FKM	RED
3	CONTACT SOCKET	CuALLOY	GOLD PLATED
2	INSERT, FEMALE	PUR	BLACK
1	CABLE, 24AWG [.25mm ²]	PUR JACKET	BLACK
ITEM	DESCRIPTION	MATERIAL	FINISH

NOTES:

1. MATERIAL: AS NOTED
2. FINISH: AS NOTED
3. ELECTRICAL:
VOLTAGE: 60VAC, 75VDC 3 & 4 POLE
VOLTAGE: 30VAC, 36VDC 5 POLE
CURRENT: 3A: 3, 4 & 5 POLE
4. TEMP RATING: -40°TO +80°C (STATIC)
-25°TO +80°C (FLEX)
5. PROTECTION: IP67 (WHEN MATED)
6. COUPLING THREAD: M8 X 1.0
7. UL LISTED FILE E152210, CSA FILE: LR6837
8. ALL DIMS ARE FOR REFERENCE UNLESS
TOLERANCED OR NOTED OTHERWISE

<div>FUNCTIONAL SYMBOLS</div> <div><div>F_A</div>= 0</div> <div><div>F_C</div>= 0</div> <div><div>F_P</div>= 0</div> <div>DIVISIONAL SYMBOLS</div>	THIS DRAWING CONTAINS INFORMATION THAT IS PROPRIETARY TO MOLEX ELECTRONIC TECHNOLOGIES, LLC AND SHOULD NOT BE USED WITHOUT WRITTEN PERMISSION																				
	DIMENSION UNITS		SCALE		CURRENT REV DESC: INITIAL RELEASE						<div>molex</div> <div>M8 DOUBLE END MALE/FEMALE 24AWG [.25MM], PUR JACKET - H08</div>										
	INCH/MM		1:1																		
	GENERAL TOLERANCES (UNLESS SPECIFIED)				EC NO: 760287 DRWN: RSTONE 2023/08/18 CHK'D: ALEON01 2023/08/22 APPR: BWOODMAN 2023/08/22 INITIAL REVISION: DRWN: R. STONE 2023/08/18 APPR: B. WOODMAN ---						PRODUCT CUSTOMER DRAWING DOCUMENT NUMBER 1200870016 DOC TYPE PSD DOC PART 000 REVISION A										
	MM		INCH																		
	4 PLACES		± ±																		
	3 PLACES		± ±																		
	2 PLACES		± ±																		
	1 PLACE		± ±																		
	0 PLACES		± ±																		
ANGULAR TOL ± °				THIRD ANGLE PROJECTION <div></div> <div>C-SIZE 120087</div>						MATERIAL NUMBER SEE P/N LEGEND				CUSTOMER GENERAL MARKET				SHEET NUMBER 1 OF 1			
DRAFT WHERE APPLICABLE MUST REMAIN WITHIN DIMENSIONS																					

10

9

8

7

6

5

4

3

2

1

FACE VIEW

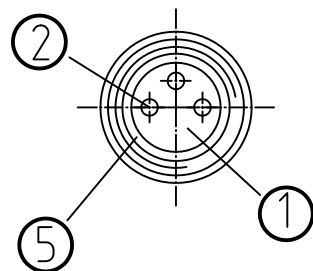

FINISHED LENGHT

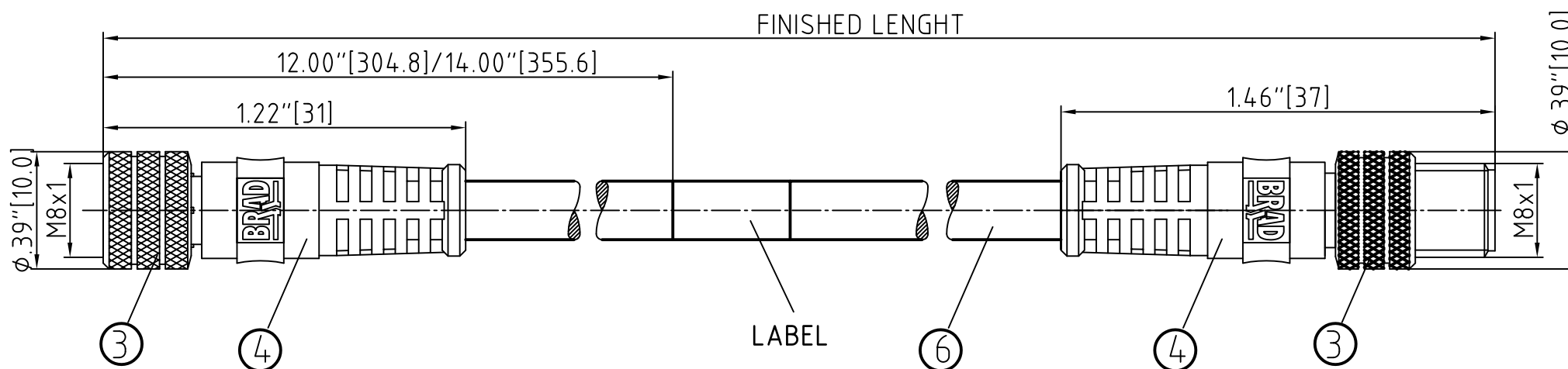

FACE VIEW

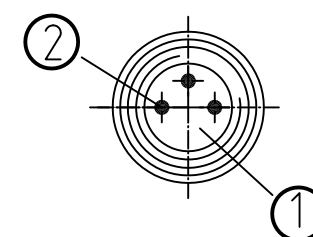

MALE FACE VIEW

3-POLE

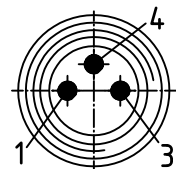

4-POLE

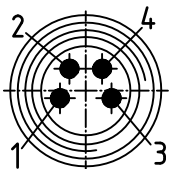

FEMALE FACE VIEW

3-POLE

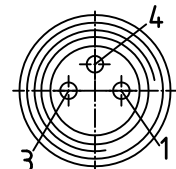

4-POLE

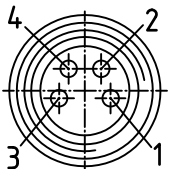
1 BROWN
3 BLUE
4 BLACK1 BROWN
2 WHITE
3 BLUE
4 BLACK

POLE	MATERIAL NUMBER	ENGINEERING NUMBER	FINISHED LENGHT IN/MM
3	1200870018	443030B09M006	1.97' +1.75" -0 [0.6M +44.5 -0]
3	1200870021	443030B09M020	6.56' +3.50" -0 [2.0M +88.9 -0]
3	1200870023	443030B09M050	16.40' +6.50" -0 [5.0M +165.1 -0]

CONNECTOR SPECIFICATION:

VOLTAGE RATING	3-4POL:60V/AC 75V/DC
AMPERAGE RATING	3 AMPS
PROTECTION	IP68
OPERATING TEMPERATURE	-25°C TO +80°C
UL CERTIFICATIONS	UL listed, File #E152210
CSA CERTIFICATIONS	CSA CERTIFIED, File LR6837

ITEM	COMPONENT	MATERIAL	FINISH
1	INSERT	POLYURETHANE (PUR)	BLACK
2	CONTACT SOCKET	COPPER ALLOY	GOLD OVER NICKEL
3	COUPLING NUT	BRASS	NICKEL PLATED
4	OVERMOLD	TPE	YELLOW
5	O-RING	VITON	
6	CABLE- 24 AWG, (COPPER STRANDING) 3/4 CONDUCT. 300V	JACKET: PUR	YELLOW

DESCRIPTION EC NO: WEU2010-0326 DRWN: REISSNER 2010/02/03 CHKD: FP APPR: FPACHER 2010/02/05 REV		QUALITY SYMBOLS = 0 = 0	GENERAL TOLERANCES (UNLESS SPECIFIED)			DIMENSION STYLE IN/MM		SCALE 2:1	DESIGN UNITS METRIC	THIRD ANGLE PROJECTION	
				mm	INCH	DRAWN BY DATE REISSNER 2010/02/03		NC 3/4P M/MFE XM ST/ST AWG 24 PUR ----			
			4 PLACES	±---	±---	CHECKED BY DATE FP 2010/02/03					
			3 PLACES	±---	±---	APPROVED BY DATE FPACHER 2010/02/05					
			2 PLACES	±---	±.01	MATERIAL NO. SEE TABLE		DOCUMENT NO. SD-120087-014		SHEET NO. 1	
			1 PLACE	±0.3	±---						
			ANGULAR ± --- °								
DRAFT WHERE APPLICABLE MUST REMAIN WITHIN DIMENSIONS			THIS DRAWING CONTAINS INFORMATION THAT IS PROPRIETARY TO MOLEX INCORPORATED AND SHOULD NOT BE USED WITHOUT WRITTEN PERMISSION								