

Actuator

704.411.018.12

Distribution by
DigiKey

DigiKey



<https://digikey.eao.com/p/704.411.018.12>

Your product:



704.411.018.12 Actuator

FRONT

Front dimension:	Ø 35 mm
Front bezel material:	Aluminium
Front bezel colour:	Nature
Front form:	round

MOUNTING

Mounting cut-out:	Ø 30.5 mm
Design:	flush
Mounting type:	Panel mounting

OPERATING-/INDICATION PART

Lever colour:	Black
Lever material:	plastic
Lever shape:	short

ELECTRICAL CHARACTERISTICS

Standards:	The switches comply with the "Standards for low-voltage switching devices" DIN EN 60947-1
------------	---

MECHANICAL CHARACTERISTIC

Switching positions:	2 positions
Weight:	0.056 kg
Switching action:	Rest - Maintained

Mechanical lifetime: ≤2.5 Mio. cycles of operation

Switching angle: 90° right

AMBIENT CONDITION

IP Protection: IP65 front side

Operating temperature: – 40 °C ... + 55 °C

Storage temperature: – 40 °C ... + 85 °C

OTHER

Hints: Max. 3 switching elements can be clipped on

Short Description: Actuator, Ø 30.5 mm, Ø 35 mm, non illuminative, Black, short, round, Nature, Aluminium, anodised, Rest - Maintained

max. number of switching elements: 3

Switching positions:

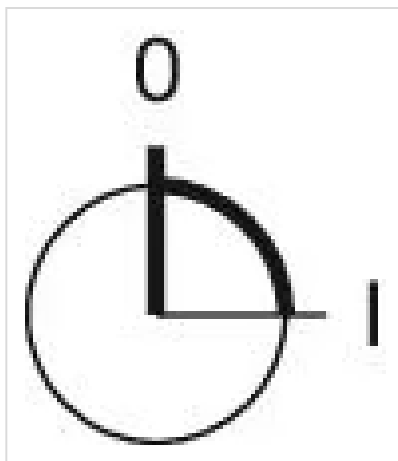

Dimension drawings:

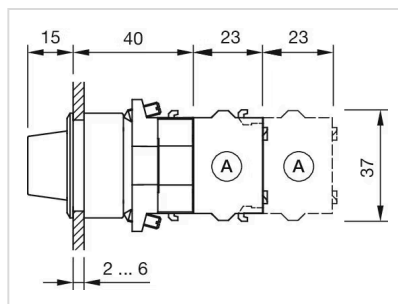

X = Screw terminal

Mounting cut-outs:

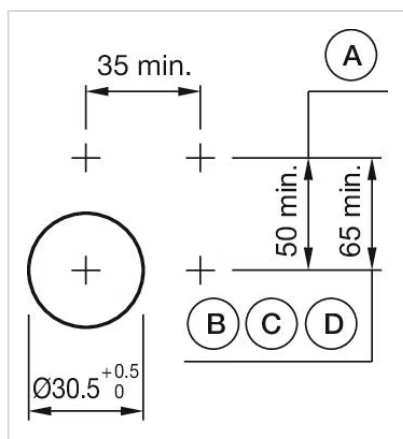

A = Screw terminal
 B = Push-in terminal (PIT)
 C = Plug-in terminal 6.3 mm x 0.8 mm
 D = Double plug-in terminal 6.3 mm x 0.8 mm

Wiring diagrams:

