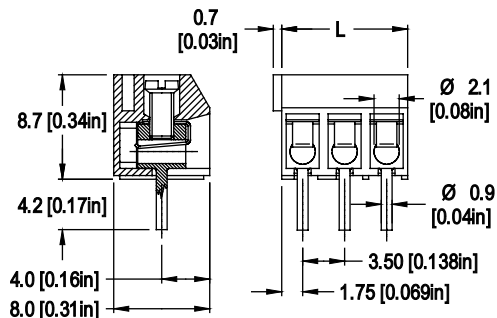

Series 93

Types 930-T (-DS)

3.5 mm spacing • 2 and 3 poles

Dovetail
Interlocking
Feature

Dimensions: mm (in.) When locating connector, allow 0.5 mm clearance around it for process-induced variations.
Length of Connector (L) L = No. of Poles x Center to Center Spacing

DESCRIPTION

• Dovetail version • Low profile • Wire entrance parallel to PC Board

TECHNICAL DATA

Center to Center Spacing: 3.5 mm (0.138 in.) Wire Stripping length: 6 mm (0.25 in.)
Nominal Cross Section: 1 mm² (1550 mils²) Recommended Hole Ø in PCB: 1.2 mm (0.047 in.)

APPROVAL INFORMATION

	Rating	Current (A)	Voltage (V)	AWG	Application Group	Screw Tightening Torque
UL File No.: E69841	UL	7	300	26-16	B,C	max. 2.0 lbf.in.
CSA File No.: LR24322	CSA	7	150	26-16	B,E	max. 0.2 Nm

DS version is CSA certified for 26-18 AWG.

Rated Impulse Withstand Voltage: 2500 V

MATERIAL

MOLDING: Polyamide, self extinguishing to UL 94, V-0, grey
TEMPERATURE LIMITS: Short time: 140°C (284°F)
Continuous: RTI 105°C (221°F)
Low limit: -40°C (-40°F)
Comparative Tracking Index: CTI > 600
Oxygen Index Rating: 33%

Terminal Body: Tin plated copper alloy

Wire Protector: nickel silver

Screw: yellow chromate passivated, zinc plated, steel, M2

Solder Pin: tin plated copper alloy, Ø 0.9 mm (0.035 in.)

ACCESSORIES

• BST Self Adhesive Marking Strips. Consecutively numbered.

OPTIONS See How to Order. If more than one option is required, please separate each option with a dash (-).

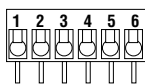

CN: Consecutive Numbering (hot stamped White numbers)

SM: Special Marking (please provide sketch)

G05: Gold Plating (5 micro inches)

G30: Gold Plating (30 micro inches)

S30: Silver Plating (30 micro inches)

(Plated components: terminal body)

HOW TO ORDER

WIRE PROTECTOR: with: - DS	POLES: 02 and 03	OPTIONS: CN, SM, G05, G30, S30
930-T	/	-

www.weco.ca/products/930-T (-DS)



Series 95

Types 950 (-DS)

5 mm spacing • 2 to 32 poles

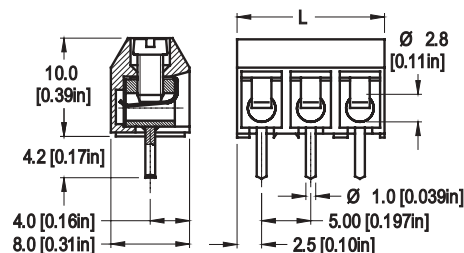

Dimensions: mm (in.) When locating connector, allow 0.5 mm clearance around it for process-induced variations.
Length of Connector (L) L = No. of Poles x Center to Center Spacing

DESCRIPTION

• Solid version • Low profile • Wire entrance parallel to PC Board

TECHNICAL DATA

Center to Center Spacing: 5 mm (0.197 in.) Wire Stripping length: 6 mm (0.25 in.)
Nominal Cross Section: 1.5 mm² (2325 mils²) Recommended Hole Ø in PCB: 1.3 mm (0.051 in.)

APPROVAL INFORMATION

	Rating	Current (A)	Voltage (V)	AWG	Application Group	Screw Tightening Torque
UL File No.: E69841	UL	6	300	26-14	B,C	max. 3.5 lbf.in.
CSA File No.: LR24322	CSA	15	300	26-12	B	max. 0.4 Nm

UL: 15 A for factory wiring only.

Version DS is CSA certified for 26-14 AWG.

International Approvals: (S)

Rated Impulse Withstand Voltage: 2500 V

MATERIAL

Self extinguishing to UL 94, V-0, grey 2 to 8 pole 9 to 32 pole
MOLDING: 2 to 8 pole: Polyamide
9 to 32 pole: Polyamide (glass fiber reinforced)
TEMPERATURE LIMITS: Short time: 140°C (284°F) 200°C (392°F)
Continuous: RTI 105°C (221°F) RTI 105°C (221°F)
Low limit: -40°C (-40°F) -40°C (-40°F)
Comparative Tracking Index: CTI > 600 CTI > 175
Oxygen Index Rating: 32% 33%

Terminal Body: tin plated copper alloy

Wire Protector: tin plated copper alloy

Screw: yellow chromate passivated, zinc plated, steel, M2.6

Solder Pin: tin plated copper alloy, Ø 1.0 mm (0.04 in.)

ACCESSORIES

• BST Self Adhesive Marking Strips. Consecutively numbered.
• Jumper, Type 970-J1.

OPTIONS See How to Order. If more than one option is required, please separate each option with a dash (-).

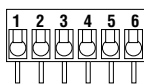

CN: Consecutive Numbering (hot stamped White numbers)

SM: Special Marking (please provide sketch)

BS: Copper Alloy Screws

PS: Clear chromate passivated, zinc plated, steel screws

G05: Gold Plating (5 micro inches)

G30: Gold Plating (30 micro inches)

S30: Silver Plating (30 micro inches)

XXMM: Longer Solder Pins up to 75 mm (3 in.), XX = protruding length of pins, in millimeters
(Plated components: terminal body)

Version with 10 mm spacing, please consult factory.

HOW TO ORDER

WIRE PROTECTOR: with: - DS	POLES: 02 to 32	OPTIONS: CN, SM, BS, PS, G05, G30, S30, XXMM
950	/	-

www.weco.ca/products/950 (-DS)