

# EV-GBG3PC-3AC16A-5,0M2,5ESBK01 - AC charging cable



1627604  
<https://www.phoenixcontact.com/us/products/1627604>

Please be informed that the data shown in this PDF document is generated from our online catalog. Please find the complete data in the user documentation. Our general terms of use for downloads are valid.



CHARX connect, Mobile AC charging cable, with vehicle charging connector and infrastructure charging plug, For charging electric vehicles (EV) with alternating current (AC) via GB/T vehicle charging inlets, with protective cap, GB/T, GB/T 20234.2-2015, GB/T 18487.1-2015, 16 A / 440 V (AC), housing: black, gray, PHOENIX CONTACT logo, cable: 5 m, black, straight

## Product description

Mobile AC charging cable with vehicle connector and infrastructure plug for charging electric vehicles (EV) with alternating current (AC), via a GB/T vehicle charging inlet, compatible with GB/T Infrastructure Socket Outlets at charging stations for E-Mobility (EVSE)

## Your advantages

- Complete product range
- Convenient handling due to the ergonomic, triple award-winning design
- Available with your logo on request - for consistent branding of your charging station
- Longitudinal water tightness reliably prevents water ingress
- Developed and produced in accordance with the IATF 16949 automotive standard and ISO 9001
- Tested in accordance with automotive standards LV124, LV214, and LV215-2
- Tested in accordance with EV Ready 37 requirements

## Commercial data

Item number	1627604
Packing unit	1 pc
Minimum order quantity	1 pc
Product key	XWBAEF
Catalog page	Page 31 (C-7-2019)
GTIN	4055626342856
Weight per piece (including packing)	2,450 g
Weight per piece (excluding packing)	2,350 g
Country of origin	DE

# EV-GBG3PC-3AC16A-5,0M2,5ESBK01 - AC charging cable



1627604  
<https://www.phoenixcontact.com/us/products/1627604>

## Technical data

### Product properties

Product type	AC charging cable
Product family	CHARX connect
Application	For charging electric vehicles (EV) with alternating current (AC) via GB/T vehicle charging inlets
	Compatible with GB/T infrastructure charging sockets at charging stations for electromobility (EVSE)
Type	Mobile AC charging cable
	with vehicle charging connector and infrastructure charging plug
Design	with protective cap
Affixed logo	PHOENIX CONTACT logo
Charging mode	Mode 3, Case B
Charging standard	GB/T

### Electrical properties

Type of signal transmission	Pulse width modulation
Note on the connection method	Crimp connection, cannot be disconnected
Coding	680 Ω (between PE and CC)
Type of charging current	AC 3-phase
Charging power	12.39 kW
Charging current	16 A

### Power contact

Number	5 (L1, L2, L3, N, PE)
Rated voltage	440 V
Rated current	16 A

### Signal contact

Number	2 (CP, CC)
Rated voltage	30 V AC
Rated current	2 A

## Dimensions

### Vehicle charging connector

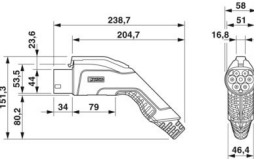
Dimensional drawing	 Vehicle connector
Width	55.9 mm

# EV-GBG3PC-3AC16A-5,0M2,5ESBK01 - AC charging cable



1627604

<https://www.phoenixcontact.com/us/products/1627604>

Height	85.4 mm
Depth	207.6 mm

## Material specifications

Color (Housing)	black (9005)
Color (Handle area)	gray (7042)
Color (Mating face)	black (9005)
Color (Protective cap)	black (9005)
Color (Cable)	black (9005)
Material (Vehicle charging connector)	Plastic
Material (Cable outer sheath)	TPE-U
Material (Contact surface)	Silver

## Cable/line

Cable length	5 m
Wiring standards/regulations	prEN 50620/DIN EN 50620
Wiring certifications	VDE
Cable weight	max. 250.00 kg/km
Cable type	Class 5
Cable type	straight
Cable structure	5 x 2.5 mm <sup>2</sup> + 1 x 0.5 mm <sup>2</sup>
External cable diameter	12.80 mm ±0.4 mm
Outer sheath, material	TPE-U
Cable resistance	≤ 0.00798 Ω/m (based on a power core, at an ambient temperature of 20°C)
Bending radius	min. 192 mm (15x diameter)
Cable length	5 m
External cable diameter	12.80 mm ±0.4 mm
Cable type	Class 5
Wiring certifications	VDE
Wiring standards/regulations	prEN 50620/DIN EN 50620
Cable resistance	≤ 0.00798 Ω/m (based on a power core, at an ambient temperature of 20°C)

## Mechanical properties

### Mechanical data

Insertion/withdrawal cycles	> 10000
Insertion force	< 100 N

## Environmental and real-life conditions

### Ambient conditions

Degree of protection (Vehicle charging connector)	IP55 (plugged in; when plugged in and ready to operate, the degree of protection is only ensued if both plug-in components are original products from Phoenix Contact or suitable standard-compliant products)
---	--

# EV-GBG3PC-3AC16A-5,0M2,5ESBK01 - AC charging cable



1627604  
<https://www.phoenixcontact.com/us/products/1627604>

Degree of protection (Protective cap)	IP54
Ambient temperature (operation)	-30 °C ... 50 °C
Ambient temperature (storage/transport)	-40 °C ... 80 °C
Altitude	5000 m (above sea level)

## Standards and regulations

Standards	
Standards/regulations	GB/T 20234.2-2015
	GB/T 18487.1-2015

# EV-GBG3PC-3AC16A-5,0M2,5ESBK01 - AC charging cable

1627604

<https://www.phoenixcontact.com/us/products/1627604>

## Drawings

Schematic diagram

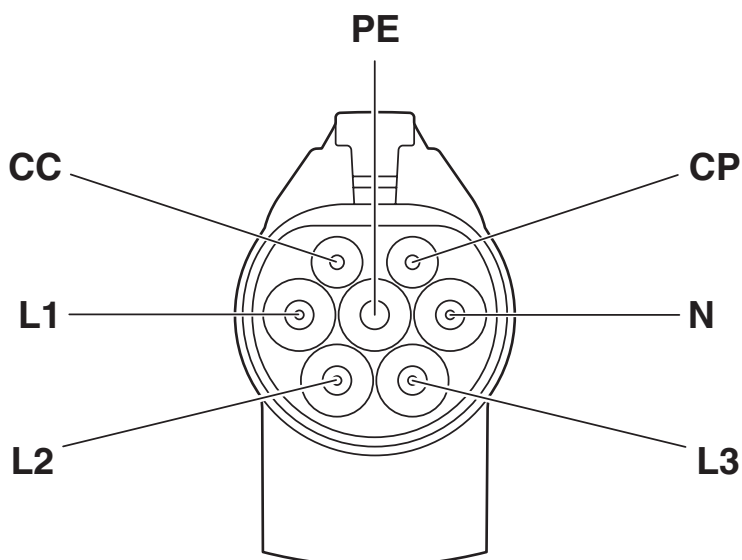

Pin assignment of the Vehicle Connector

Connection diagram

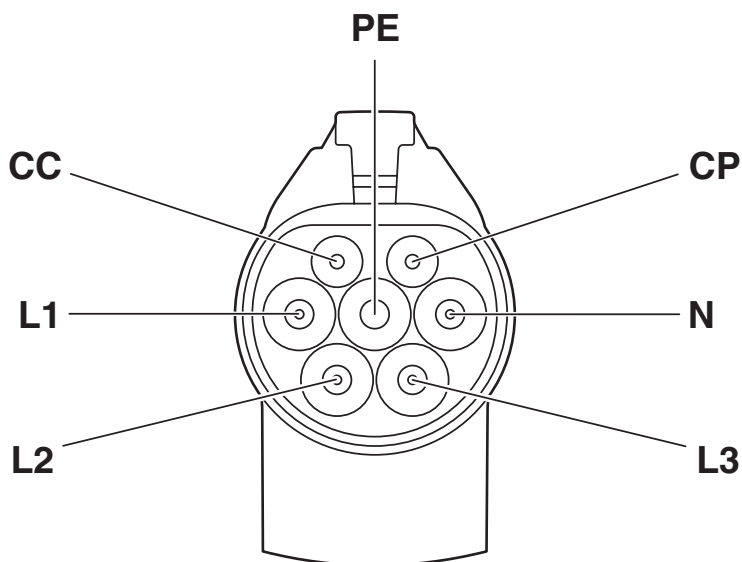

Pin assignment of Infrastructure Plug

EV-GBG3PC-3AC16A-5,0M2,5ESBK01 - AC charging cable



1627604

<https://www.phoenixcontact.com/us/products/1627604>

Dimensional drawing

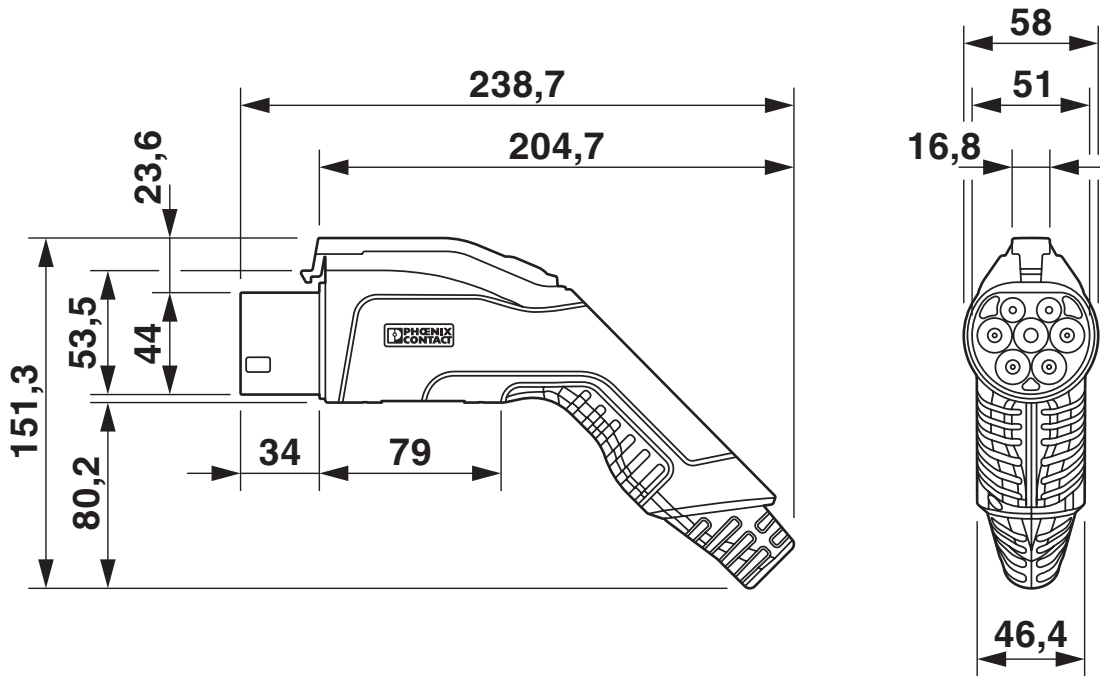

Vehicle connector

Dimensional drawing

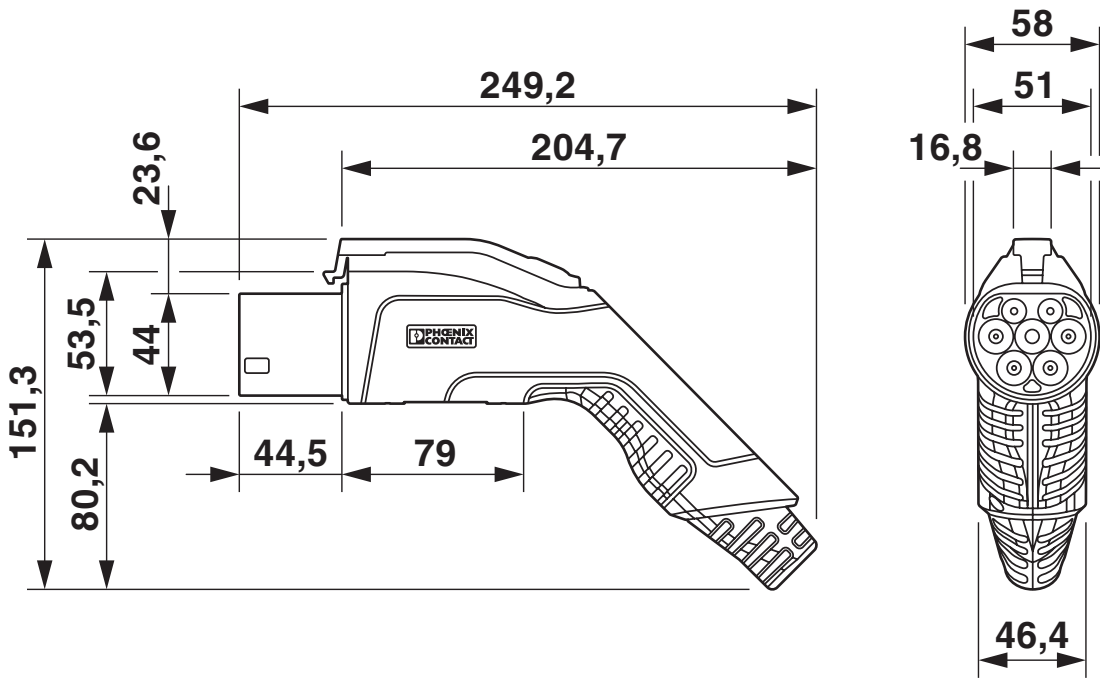

Infrastructure plug

# EV-GBG3PC-3AC16A-5,0M2,5ESBK01 - AC charging cable

1627604

<https://www.phoenixcontact.com/us/products/1627604>

Schematic diagram

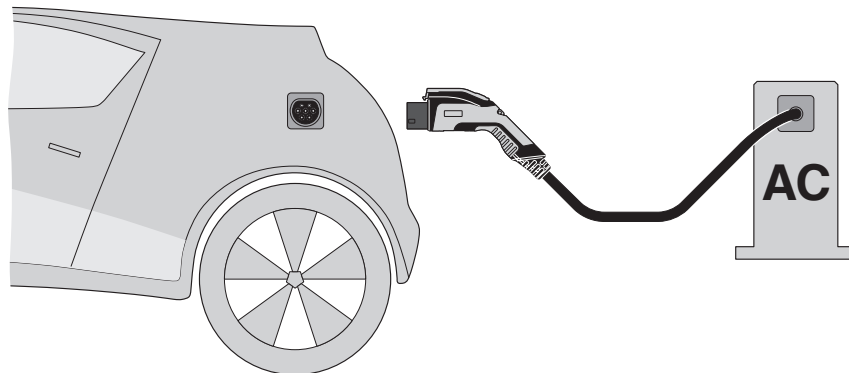

## Terminology definition

Schematic diagram

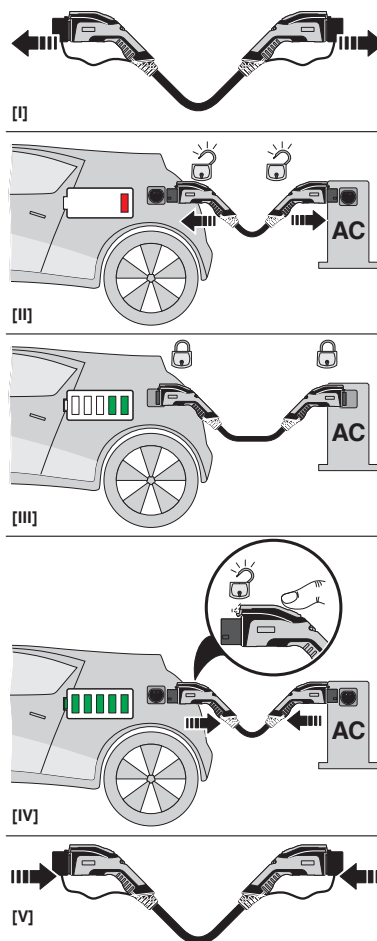

## Operating instructions

# EV-GBG3PC-3AC16A-5,0M2,5ESBK01 - AC charging cable



1627604  
<https://www.phoenixcontact.com/us/products/1627604>

## Classifications

### ECLASS

ECLASS-11.0	27144705
-------------	----------

### ETIM

ETIM 8.0	EC002897
----------	----------

### UNSPSC

UNSPSC 21.0	39121500
-------------	----------



# EV-GBG3PC-3AC16A-5,0M2,5ESBK01 - AC charging cable



1627604  
<https://www.phoenixcontact.com/us/products/1627604>

## Environmental product compliance

China RoHS	
Environment friendly use period (EFUP)	<div>EFUP-10</div> <div>An article-related China RoHS declaration table can be found in the download area for the respective article under "Manufacturer declaration". For all articles with EFUP-E, no China RoHS declaration table issued and required.</div>
EU REACH SVHC	
REACH candidate substance (CAS No.)	No substance above 0.1 wt%

# EV-GBG3PC-3AC16A-5,0M2,5ESBK01 - AC charging cable



1627604

<https://www.phoenixcontact.com/us/products/1627604>

## Accessories

### EV-GBAC-PARK - Charging connector holder

1624142

<https://www.phoenixcontact.com/us/products/1624142>



CHARX connect, Charging connector holder, Accessories, for vehicle charging connectors on charging stations (EVSE), GB/T, GB/T 20234.2, Front mounting, housing: black

---

Phoenix Contact 2024 © - all rights reserved  
<https://www.phoenixcontact.com>

Phoenix Contact USA  
586 Fulling Mill Road  
Middletown, PA 17057, United States  
(+717) 944-1300  
[info@phoenixcon.com](mailto:info@phoenixcon.com)