

← BACK TO KNOBS(/KNOBS/)



JD Series

The “JD Model” knob is simple, yet very traditional in appearance and feel. The look of this knob is classic and well respected. Saw cut indicator line is on half of the top and full-length of the side. Two 6-32 set screws.



PART NUMBER BREAK DOWN
 EXAMPLE: JD-50-1-5

JD	50	1	5
MODEL	DIAMETER	FINISH	SHAFT SIZE
These letters are the model series name.	This value indicates the outer diameter sizing of the knob.	This value indicates the color and finish of the knob.	This value indicates shaft sizing.
	50 - .500	1 - CLEAR GLOSS	5 - .250
	63 - .625	2 - BLACK GLOSS	6 - .125
	75 - .750	3 - CLEAR MATTE	7 - .2375 (6MM)
	90 - .925	4 - BLACK MATTE	



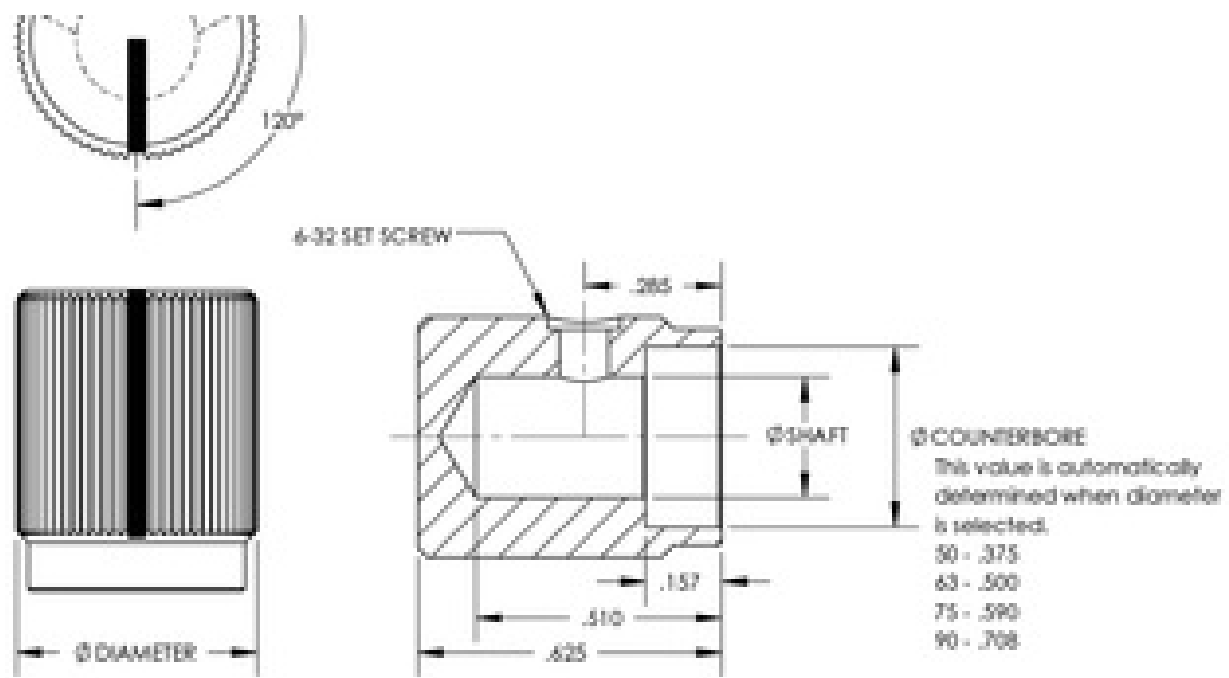

ROHS & REACH COMPLIANCE(/ROHS/) CONFLICT MINERALS COMPLIANCE(/TERMS-CONDITIONS/)

SPEC PRINTS (/SPEC-PRINTS/)

"WE COULD MAKE A REALLY BIG KNOB ... WE JUST CHOOSE NOT TO."

© 2016 KILO INTERNATIONAL