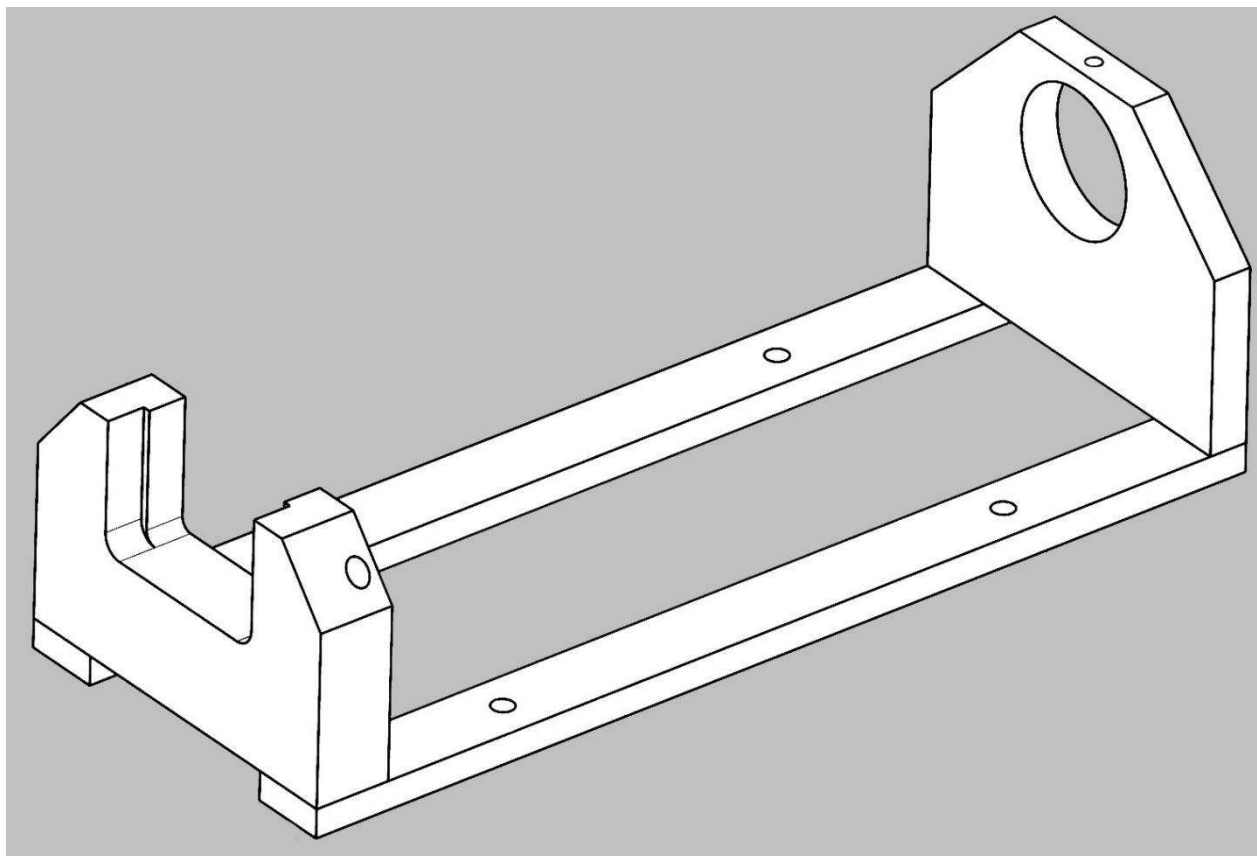

Figure 1: Bench Mount Assembly 312324



1. INTRODUCTION

This instruction sheet covers setup, maintenance, and repair for Bench Mount Assembly 312324. The tool is designed to aid in operating Hydraulic Hand Tools 59973-1, 59974-4, or 59975-1.



NOTE

The bench mount can also accommodate Hydraulic Hand Tools 1490748-1 and 1490749-1.

2. DESCRIPTION

The bench mount (Figure 2) features two rails, each of which has two holes for mounting to a bench surface. (Fasteners for mounting to the workbench are not included.) The handle end of the bench mount has a clearance hole for the handle of the tool. The crimp head on the hydraulic hand tool is mounted at the tool end of the bench mount. A socket head screw is used to adjust the tightness of mounting for both the head and handle of the tool. The bench mount allows for full actuation and function of the hydraulic hand tool.

Figure 2: Parts of bench mount

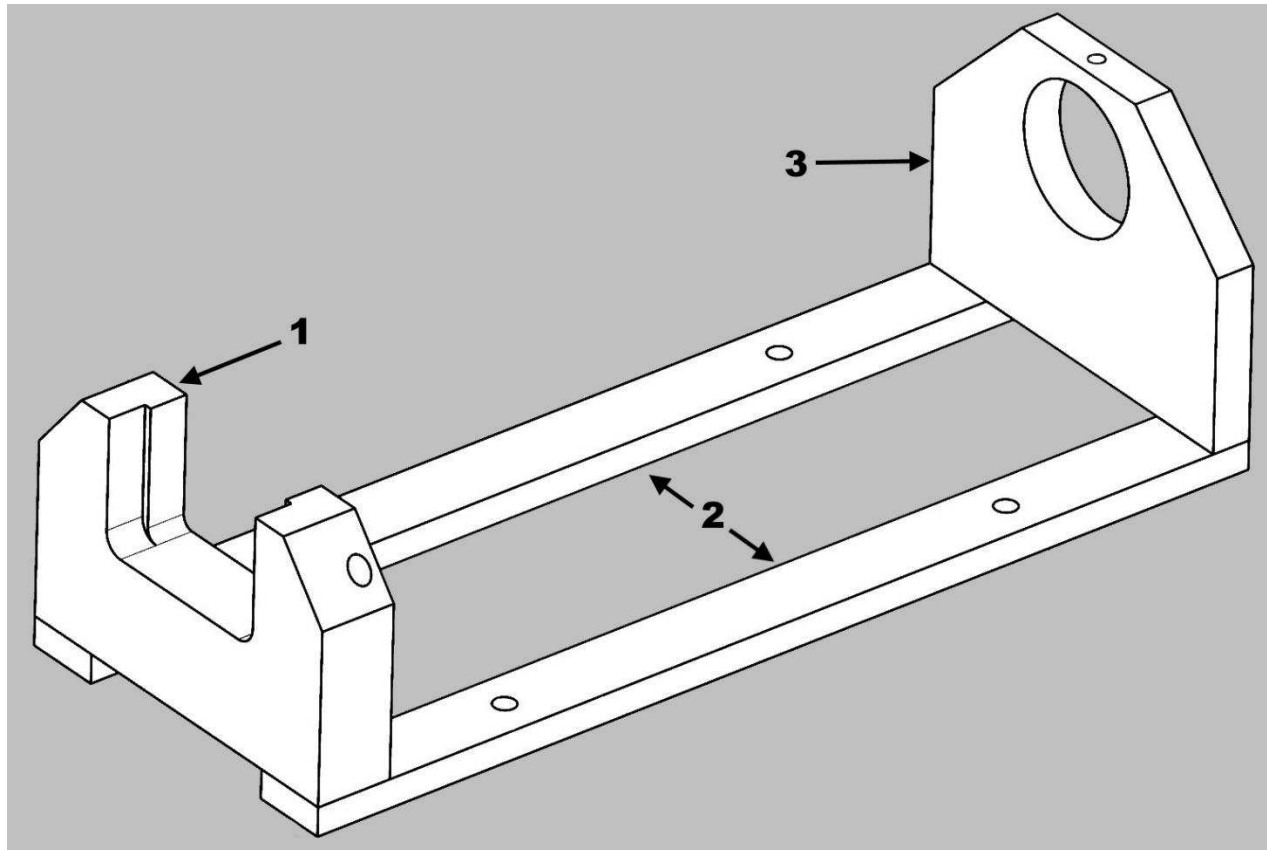

- 1** Tool end of bench mount
- 2** Rails
- 3** Handle end of bench mount

Figure 3: Dimensions

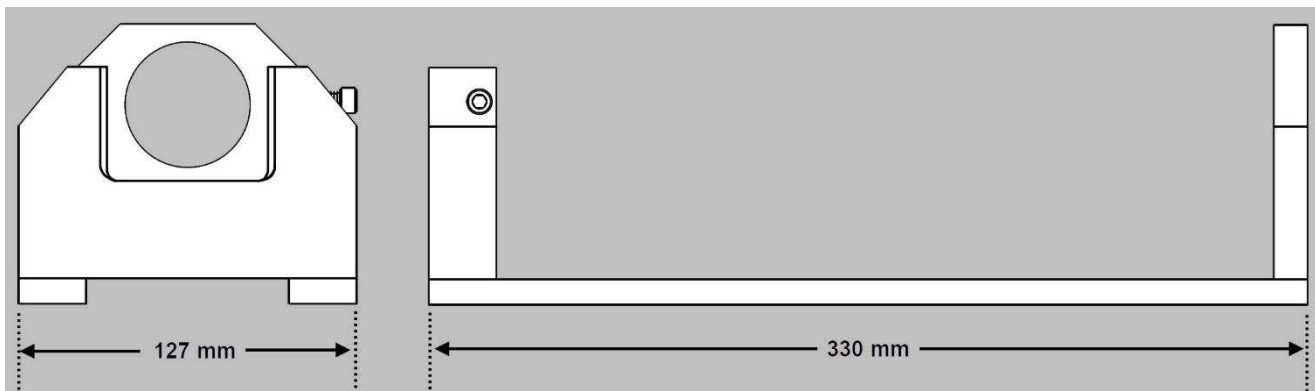

3. ASSEMBLING AND MOUNTING

1. Fasten both rails to the tool end of the bench mount using 10-24 x .625" socket head cap screws.
2. Attach the handle end of the bench mount to the rails and fasten with screws.
3. Use screws to secure the rails to the workbench.



NOTE

Each rail has two 7.1 mm [.28 in] diameter holes on 177.8 mm [7.0 in] centerline for securing the bench mount to a work surface.

4. Place the hydraulic hand tool into the bench mount assembly.
5. Insert 1/4 -20 x .75" socket head screws through the clearance holes on both the tool and handle ends of the bench mount (Figure 4). Tighten each screw just enough to hold the tool in place. Do not tighten the screw completely.
6. The hydraulic hand tool is ready for operation.

Figure 4: Tool retaining screws

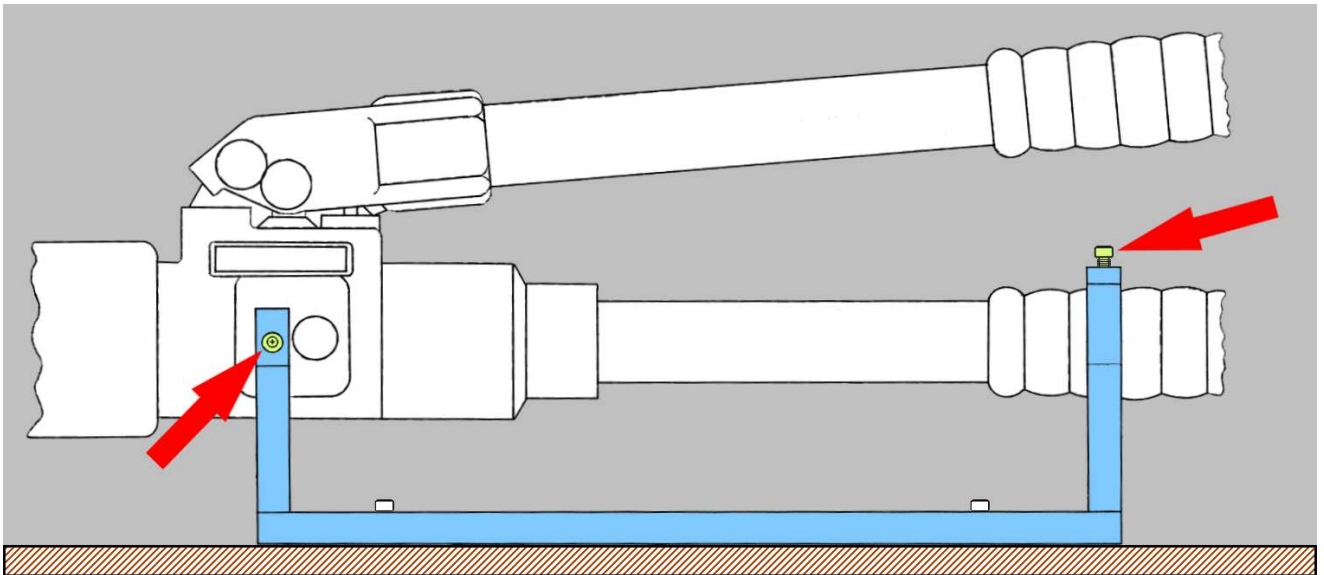

4. MAINTENANCE

To ensure optimum tool performance, clean the bench mount assembly periodically according to frequency of use.

1. Remove dust, moisture, and other contaminants with a clean, soft brush or lint-free cloth.
2. Visually inspect the bench mount for worn, chipped, or broken parts.
3. Verify that all screws are secure.

5. REPLACEMENT AND REPAIR

The parts listed in Table 1 are customer replaceable. Stock and control a complete inventory to prevent lost time when replacement of parts is necessary. Order replacement parts through your TE representative. You can also order parts by any of the following methods:

- Go to TE.com and click the **Shop TE** link at the top of the page.
- Call 800-522-6752.
- Write to:

CUSTOMER SERVICE (038-035)
TE CONNECTIVITY CORPORATION
PO BOX 3608
HARRISBURG PA 17105-3608

For customer repair services, call 800-522-6752.

Figure 5: Customer-replaceable parts

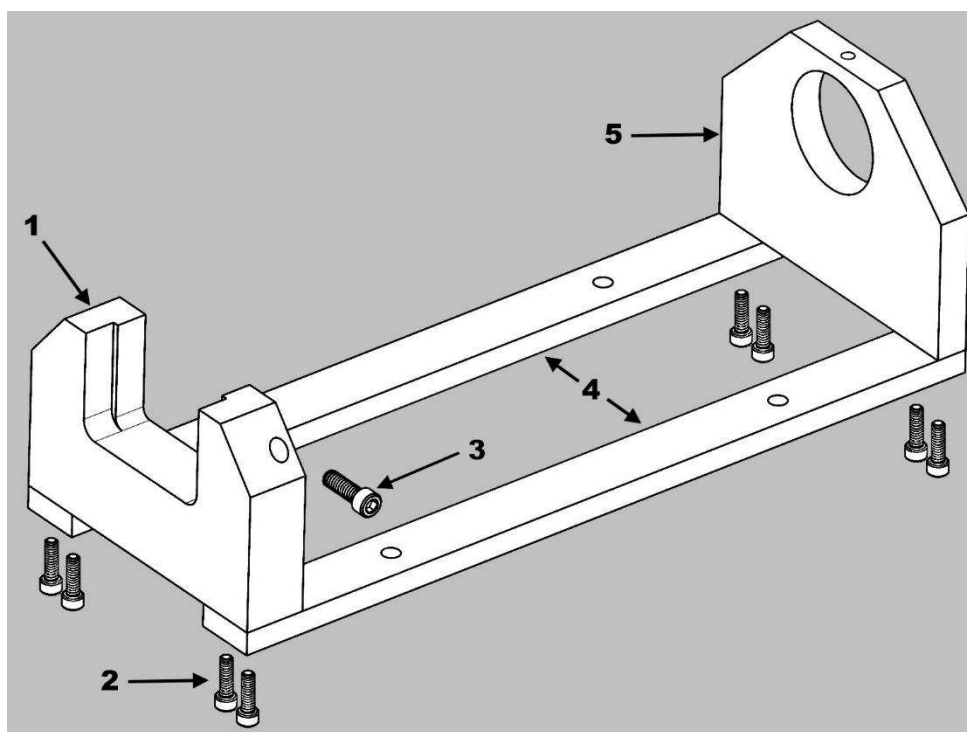

Table 1: Part numbers

Item	Part number	Description	Quantity per assembly
1	312325-1	Tool end, bench mount	1
2	5-21000-4	Screw, socket head cap, 10-24 x .625"	8
3	21007-8	Set screw, tool-retaining, socket head, 1/4 -20 x .75"	2
4	312327-1	Rail, bench mount	2
5	312326-1	Handle end, bench mount	1

6. REVISION SUMMARY

Revisions to this instruction sheet include:

Initial release