

SM Interset

Inter-set fixing for permanent anchorages in cavity walls. Zinc-plated metal fixing with metric screw



Product information

Features and benefits

- The fixing can be installed using installation pliers, or a normal screwdriver
- Body manufactured as one piece, with integral thread and flange for increased reliability
- Combination head screw supplied
- Integral anti-rotation lugs
- Hinged legs designed to maximise load-bearing capacity

Applications

- Shelves and bathroom accessories on standard plasterboard
- Radiators and kitchen cabinets on double thickness and tiled plasterboard
- Pictures
- Lamps
- Towel rails
- Curtain rails
-

Base materials

Approved for use in:

- Plasterboard
- Chipboard

Installation guide

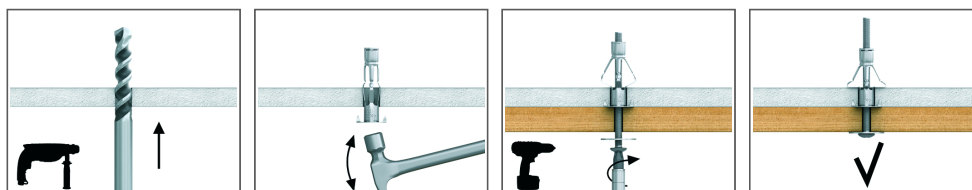

1. Drill a hole of required diameter.
2. Insert the fixing into the hole. Tap in lightly, ensuring that the anti-rotation lugs penetrate the face of the base material
3. With the hole drilled and the fixing inserted, the setting tool is used to pull the screw head, thus expanding the fixing body

Product information

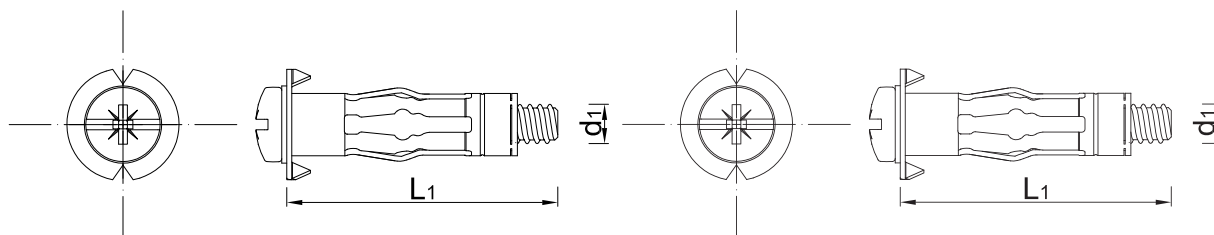

Product Code	Fixing	
	Diameter	Length
	d ₁	L ₁
	[mm]	
SM-04032	4	40
SM-05037	5	46
SM-06037	6	46

Installation data

Size			Ø5	Ø6	Ø4
Fixing diameter	d	[mm]	5	6	4
Hole diameter in substrate	d ₀	[mm]	10	12	8
Min. hole depth in substrate	h ₀	[mm]	-	-	-
Installation depth	h _{nom}	[mm]	-	-	-
Min. substrate thickness	h _{min}	[mm]	9.5	9.5	9.5
Min. spacing	s _{min}	[mm]	100	100	100
Min. edge distance	c _{min}	[mm]	100	100	100

Product commercial data

Product Code	Fixing		Quantity [pcs]			Weight [kg]			Bar Codes	Art No.
	Diameter [mm]	Length [mm]	Box	Outer	Pallet	Box	Outer	Pallet		
SM-04032	4	40	100	3200	76800	0.71	22.7	575.3	5906675191225	32582
SM-05037	5	46	100	1600	38400	1.27	20.3	517.7	5906675191720	32589
SM-06037	6	46	100	1200	28800	1.75	21.0	534.0	5906675192123	32596