

**PRODUCT DATASHEET**  
**Gt3 series**

last update 10/11/2014

**Product number C10891\_GT3-S**

Family	Gt3	FWHM	14 degrees
Type	Lens array	Efficiency	92 %
LED	XB-D	cd/Im	4.300
Color	Clear	Gerber File	Available
Diameter	35 mm		
Height	9 mm		
Style	Round		
Optic Material	PMMA		
Holder Material	-		
Fastening	["glue", "pin"]		
Status	Production ready		

**Product number C10892\_GT3-M**

Family	Gt3	FWHM	25 degrees
Type	Lens array	Efficiency	91 %
LED	XB-D	cd/Im	2.000
Color	Clear	Gerber File	Available
Diameter	35 mm		
Height	9 mm		
Style	Round		
Optic Material	PMMA		
Holder Material	-		
Fastening	["pin", "glue"]		
Status	Production ready		

**Product number C10893\_GT3-W**

Family	Gt3	FWHM	32 degrees
Type	Lens array	Efficiency	92 %
LED	XB-D	cd/Im	1.800
Color	Clear	Gerber File	Available
Diameter	35 mm		
Height	9 mm		
Style	Round		
Optic Material	PMMA		
Holder Material	-		
Fastening	["glue", "pin"]		
Status	Production ready		

**Product number C11624\_GT3-WW**

Family	Gt3	FWHM	38 degrees
Type	Lens array	Efficiency	92 %
LED	XB-D	cd/Im	1.400
Color	Clear	Gerber File	Available
Diameter	35 mm		
Height	9 mm		
Style	Round		
Optic Material	PMMA		
Holder Material	-		
Fastening	["pin", "glue"]		
Status	Production ready		



## PRODUCT DATASHEET

### Gt3 series

last update 10/11/2014

**NOTE:** The typical divergence will be changed by different color, chip size and chip position tolerance. The typical total divergence is the full angle measured where the luminous intensity is half of the peak value.



## PRODUCT DATASHEET

### Gt3 series

last update 10/11/2014

#### GENERAL INFORMATION

- Product series especially designed & optimized for XB-D series of LEDs.
- Special care taken to make light distribution as uniform as possible.
- Lens material optical grade PMMA with high UV and temperature resistance. Allows use of high current and temperature conditions.

Please find more information about used material from below:

[http://ledil.fi/sites/default/files/Documents/Technical/Material/PMMA%20N%20UL94\\_Yellow%20Card.pdf](http://ledil.fi/sites/default/files/Documents/Technical/Material/PMMA%20N%20UL94_Yellow%20Card.pdf)

<http://ledil.fi/sites/default/files/Documents/Technical/Material/PMMA%20N%20PLEXIGLAS-Datasheet.pdf>

Relative intensity of

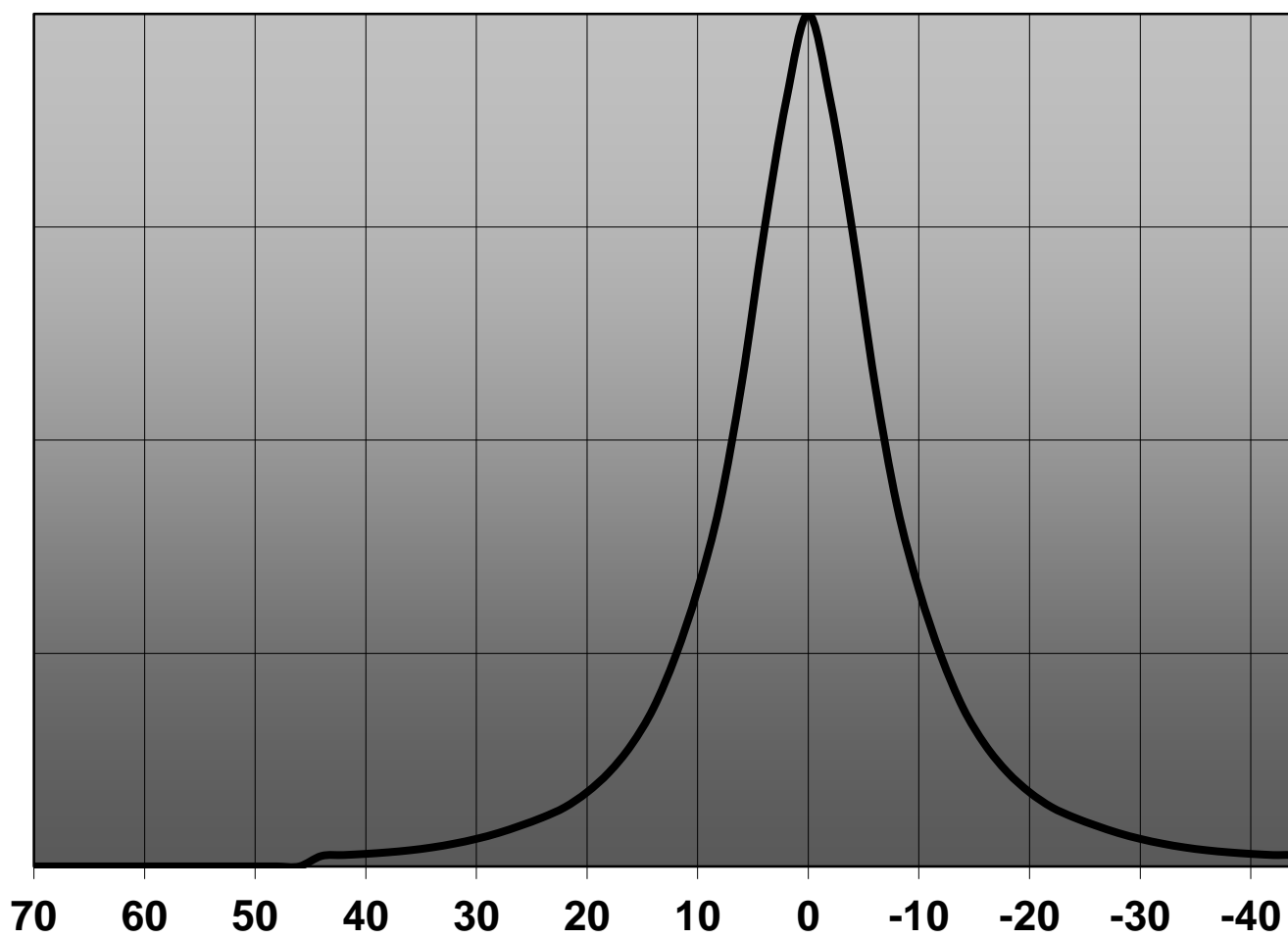

# Relative intensity of C10892\_GT3-M-XBD

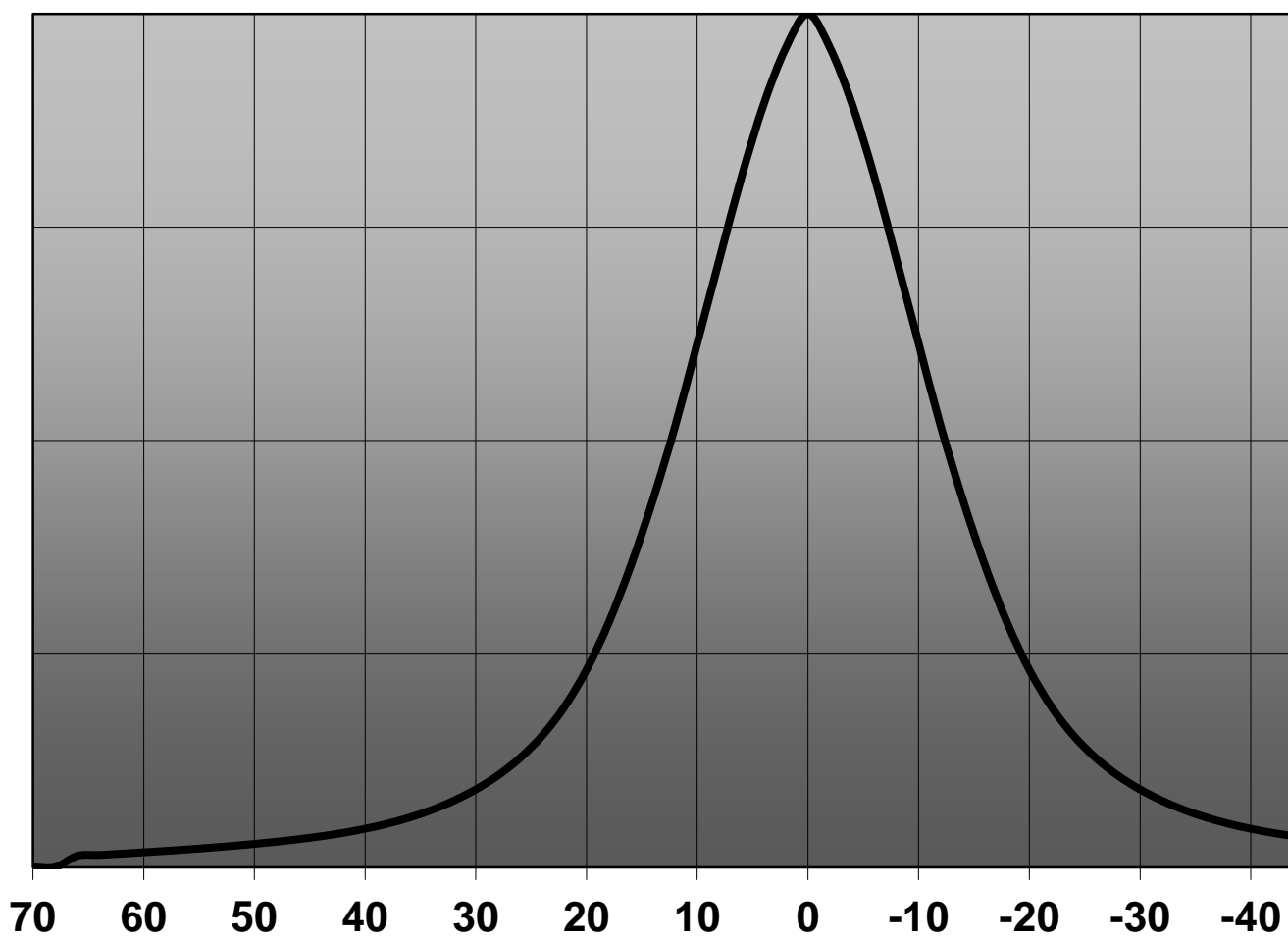

### Relative intensity of C10893\_GT3-W-XBD

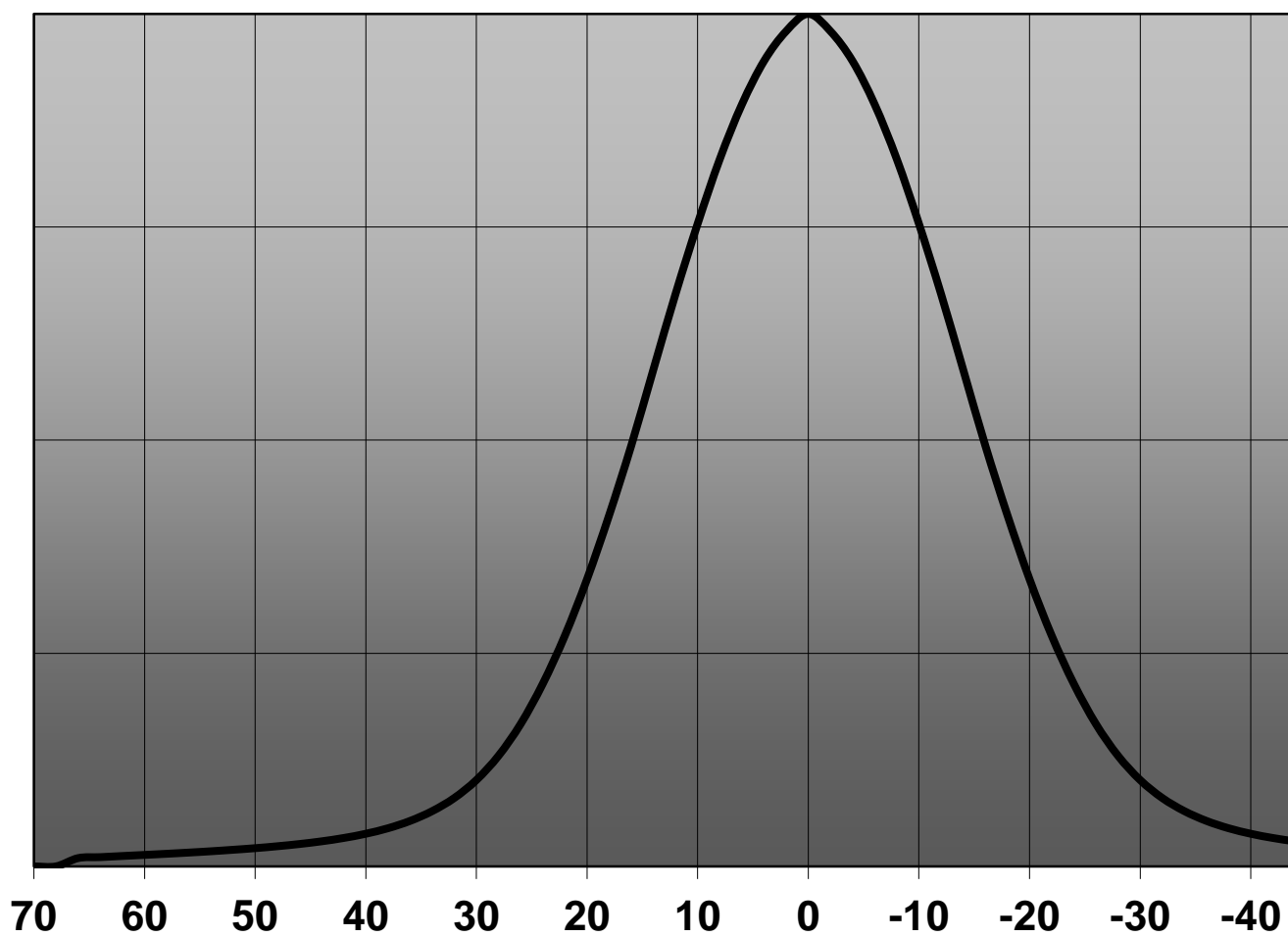

## Relative intensity of C11624-GT3-WW-XBD

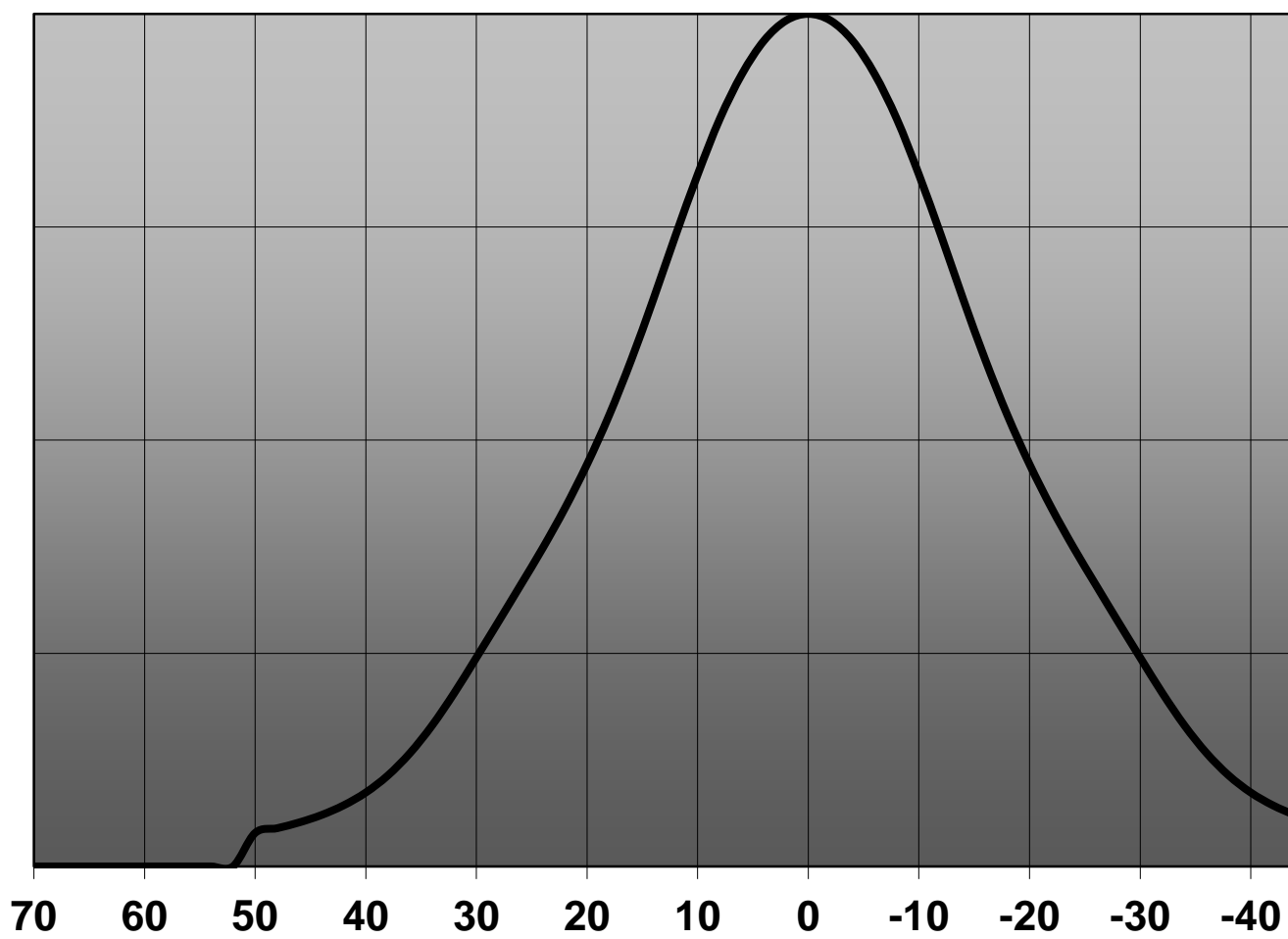

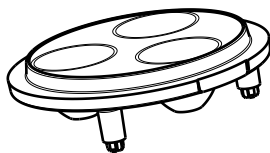

Isometric view  
Scale: 1:1

Material: PMMA

Part no.s:

- C10891\_GT3-XP-S
- C10891\_GT3-XP-G-S
- C10891\_GT3-OSL-S
- C10891\_GT3-DD-S
- C10891\_GT3-RE-ES-M
- C10891\_GT3-Z5-S
- C10892\_GT3-XP-M
- C10892\_GT3-XP-G-M
- C10892\_GT3-OSL-M
- C10892\_GT3-DD-M
- C10892\_GT3-XP-M
- C10892\_GT3-Z5-M
- C10893\_GT3-XP-W
- C10893\_GT3-XP-G-W
- C10893\_GT3-OSL-W
- C10893\_GT3-DD-W
- C10893\_GT3-RE-ES-W
- C11623\_GT3-RE-VW
- C11623\_GT3-N19-VW
- C11624\_GT3-XP-VW
- C11624\_GT3-XP-G-VW
- C11624\_GT3-OSL-VW
- C11624\_GT3-DD-VW
- C11624\_GT3-Z5-VW

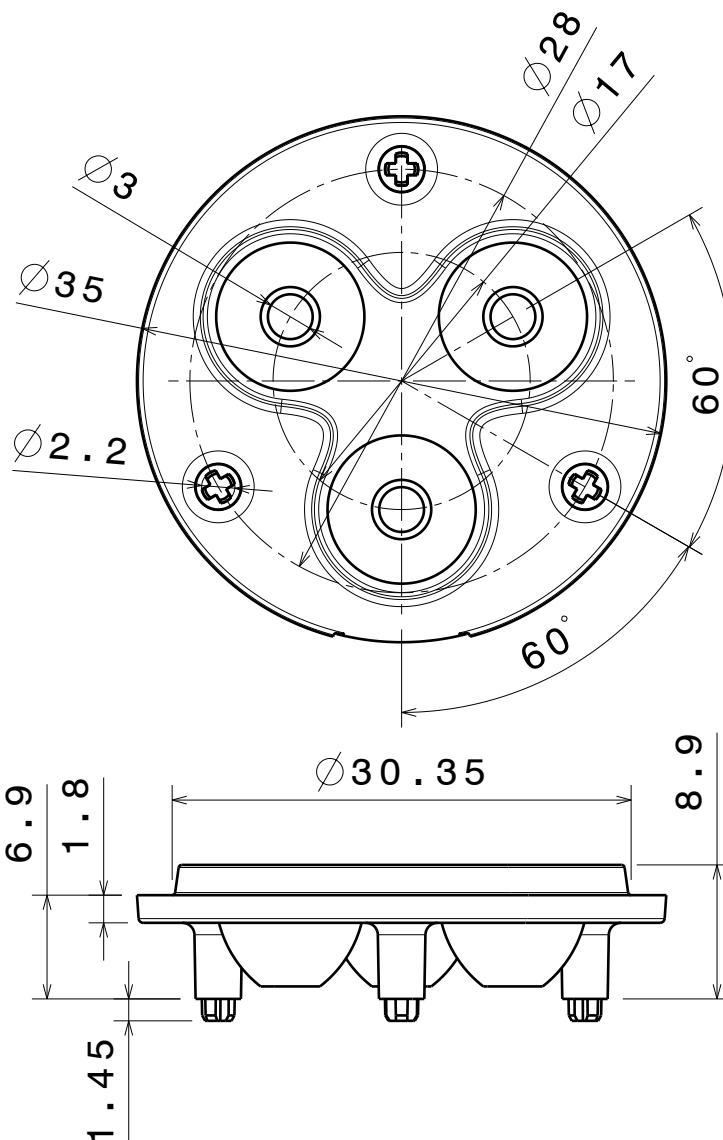

Bottom view

Front view

This drawing is our property.  
It can't be reproduced  
or communicated without  
our written agreement.



L  
T  
F  
F

e  
e  
i  
i

N  
n

d  
h

DRAWING TITLE

Datasheet GT3-Series Lens

DRAWN BY

p

DATE

08.01.2010

CHECKED BY

t

k

DATE

07.01.2010

DESIGNED BY

hh

DATE

07.01.2010

SIZE

A4

DRAWING NUMBER

-

REV

1

SCALE

2:1

WEIGHT (g)

SHEET

1/1

D

A