

# HC-B 32-AFS-72-O1M25-EEE - Housing



1580545

<https://www.phoenixcontact.com/us/products/1580545>

Please be informed that the data shown in this PDF document is generated from our online catalog. Please find the complete data in the user documentation. Our general terms of use for downloads are valid.



HEAVYCON ADVANCE B32 panel mounting base, for increased environmental requirements, EMC conductive, for Allen screw locking, with additional M25 gland

## Commercial data

Item number	1580545
Packing unit	100 pc
Minimum order quantity	1 pc
Product key	BF7AAA
GTIN	4046356547277
Weight per piece (including packing)	841.6 g
Weight per piece (excluding packing)	841.6 g
Country of origin	DE

# HC-B 32-AFS-72-O1M25-EEE - Housing



1580545

<https://www.phoenixcontact.com/us/products/1580545>

## Technical data

### Product properties

Product type	Housing with screw locking
Housing type	Panel mounting base
Application	Standard
Type	B32
Fixing screws	M6 (5 mm Allen screw)
Shielded	yes
Cable outlet	lateral
Pg screw connection	none

### Dimensions

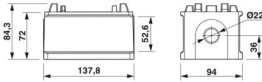
Dimensional drawing	
Width	94 mm
Height	84.3 mm
Length	137.8 mm

### Material specifications

Seal material	NBR, conductive
Housing material	die-cast aluminum
Housing surface material	uncoated

### Environmental and real-life conditions

Ambient conditions	
Degree of protection	IP66
	IP68 (0.2 bar/24 h)
	IP69K
Enclosure rating (NEMA)	4
	4X
	6P
	12
Ambient temperature (operation)	-40 °C ... 125 °C

### Mechanical properties

Mechanical data	
Locking type	Nut

### Mounting

# HC-B 32-AFS-72-O1M25-EEE - Housing



1580545

<https://www.phoenixcontact.com/us/products/1580545>

Fixing screws	M6 (5 mm Allen screw)
---------------	-----------------------

## Drawings

Dimensional drawing

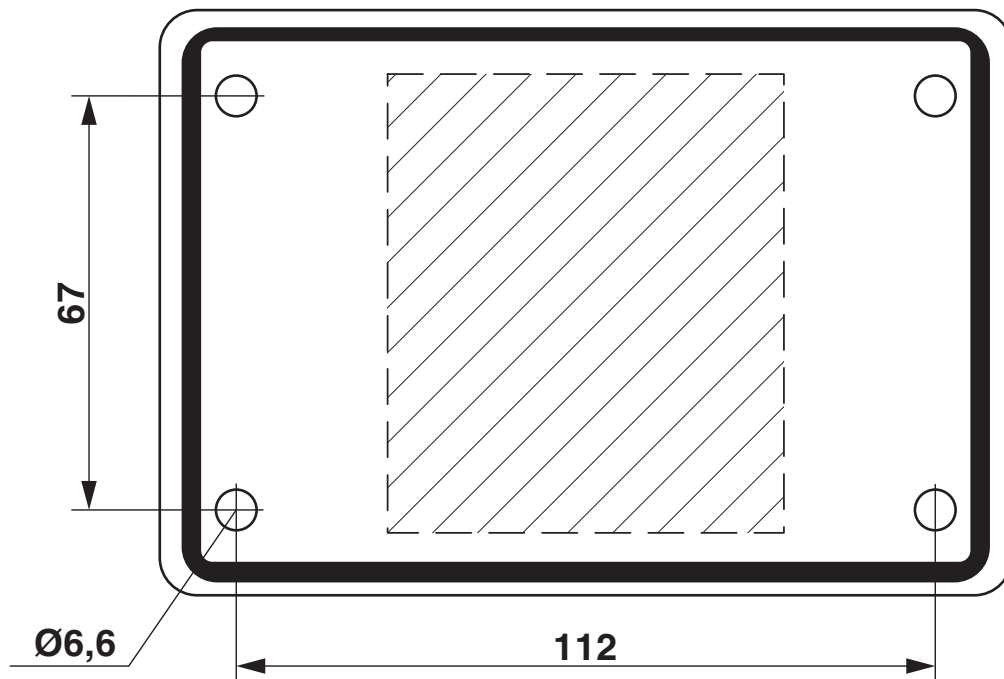

Fixing holes

Dimensional drawing

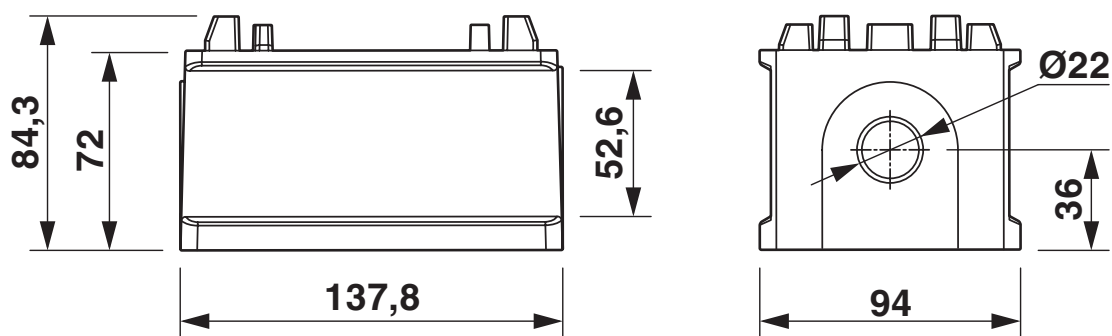

Dimensional drawing

# HC-B 32-AFS-72-O1M25-EEE - Housing

1580545

<https://www.phoenixcontact.com/us/products/1580545>



## Classifications

### ECLASS

ECLASS-11.0	27440202
ECLASS-13.0	27440202

# HC-B 32-AFS-72-O1M25-EEE - Housing



1580545

<https://www.phoenixcontact.com/us/products/1580545>

## Environmental product compliance

EU REACH SVHC

REACH candidate substance (CAS No.)	No substance above 0.1 wt%
-------------------------------------	----------------------------

# HC-B 32-AFS-72-O1M25-EEE - Housing

1580545

<https://www.phoenixcontact.com/us/products/1580545>



## Accessories

### G-INS-M25-M68N-PNES-GY - Cable gland

1411126

<https://www.phoenixcontact.com/us/products/1411126>



Cable gland, material for screw connection: PA, application: Standard, external cable diameter 11 mm ... 17 mm, shielding: no, connecting thread: M25 x 1.5, color: silver-grey RAL 7001

---

### G-INS-M25-M68N-PNES-BK - Cable gland

1411134

<https://www.phoenixcontact.com/us/products/1411134>



Cable gland, material for screw connection: PA, application: Standard, external cable diameter 11 mm ... 17 mm, shielding: no, connecting thread: M25 x 1.5, color: jet black RAL 9005

# HC-B 32-AFS-72-O1M25-EEE - Housing

1580545

<https://www.phoenixcontact.com/us/products/1580545>



## G-INS-M25-M68N-NNES-S - Cable gland

1411165

<https://www.phoenixcontact.com/us/products/1411165>



Cable gland, material for screw connection: Brass, nickel-plated, application: Standard, external cable diameter 11 mm ... 17 mm, shielding: no, connecting thread: M25 x 1.5, color: silver, with O-ring

---

## HC-M-KV-M25(14-21) - Cable gland

1646007

<https://www.phoenixcontact.com/us/products/1646007>



Metal screw connection up to 5 bar, thread length: 7 mm, cable diameter: 14 - 21 mm, WAF 34, screw connection: M25

# HC-B 32-AFS-72-O1M25-EEE - Housing

1580545

<https://www.phoenixcontact.com/us/products/1580545>



## G-INSEC-M25-S68N-NCRS-S - Cable gland

1411190

<https://www.phoenixcontact.com/us/products/1411190>



Cable gland, material for screw connection: Brass, nickel-plated, application: EMC, external cable diameter 11 mm ... 16 mm, shielding: yes, connecting thread: M25 x 1.5, color: silver, with O-ring

---

## G-INESR-M25-M68N-NEPDS-S - Cable gland

1415193

<https://www.phoenixcontact.com/us/products/1415193>



Cable gland, material for screw connection: Brass, nickel-plated, application: Standard, external cable diameter 9 mm ... 17 mm, shielding: no, connecting thread: M25 x 1.5, color: silver, with external strain relief, with O-ring

## HC-B 32-AFS-72-O1M25-EEE - Housing

1580545

<https://www.phoenixcontact.com/us/products/1580545>



## HC-M-KV-T-M25 - Cable gland

1646191

<https://www.phoenixcontact.com/us/products/1646191>

Metal screw connection with cable bend protection and strain relief, thread length: 7 mm, cable sealing area: 10 - 19 mm, clamping area: 14 - 21 mm, SW 30, screw connection: M25



---

## REDUC-M-KV-M25/M20 - Reducing adapter

1647624

<https://www.phoenixcontact.com/us/products/1647624>

Reducing adapter, connecting thread: M25 x 1.5, color: silver, with O-ring



# HC-B 32-AFS-72-O1M25-EEE - Housing

1580545

<https://www.phoenixcontact.com/us/products/1580545>



## ENLAR-M-KV-M25/M32 - Extension adapter

1647679

<https://www.phoenixcontact.com/us/products/1647679>

Extension adapter, connecting thread: M25 x 1.5, color: silver, with O-ring



---

## HC-M-BS-M25 - Screw plug

1645859

<https://www.phoenixcontact.com/us/products/1645859>

Screw plug, material for screw connection: Brass, nickel-plated, connecting thread: M25 x 1.5, color: silver



# HC-B 32-AFS-72-O1M25-EEE - Housing

1580545

<https://www.phoenixcontact.com/us/products/1580545>



## SF-BIT-HEXB 5-89 - Screw insert

1208911

<https://www.phoenixcontact.com/us/products/1208911>



Screw bit, hexagonal with ball head, E6.3-1/4" drive, size: Hex 5 x 89 mm, hardened, suitable for holder according to DIN 3126-F 6.3/ISO 1173

---

## SF-M BH - Screwdriver

1212070

<https://www.phoenixcontact.com/us/products/1212070>



Bit screwdriver, with 1/4" quick-action chuck, handle length 119 mm, 2-component handle, with non-slip grip, suitable for bits according to DIN 3126-C 6.3 and E 6.3/ISO 1173, magnetic

---

Phoenix Contact 2024 © - all rights reserved  
<https://www.phoenixcontact.com>

Phoenix Contact USA  
586 Fulling Mill Road  
Middletown, PA 17057, United States  
(+717) 944-1300  
[info@phoenixcon.com](mailto:info@phoenixcon.com)