

BSTA108NN00550236000

✓ ACTIVE

TE Internal #: BSA108N00550236000

Cable-to-Cable, 8 Position, Power & Signal, Cable Mount (Free-Hanging), Electrodeposited Nickel, Zinc Alloy, PA66, Standard Circular Connectors

[View on TE.com >](#)



Connectors > Circular Connectors > Standard Circular Connectors



Connector System: **Cable-to-Cable**

Connector Mounting Type: **Cable Mount (Free-Hanging)**

Number of Positions: **8**

Sealable: **No**

Circuit Application: **Power & Signal**

Features

Product Type Features

Connector Product Type	Housing Assembly
Connector System	Cable-to-Cable
Sealable	No
Circular Connector Type	Plug
Shell Type	Metal

Configuration Features

Number of Positions	8
Number of Power Positions	4
Number of Signal Positions	4
Contacts Preloaded	No

Electrical Characteristics

Operating Voltage	250 VAC, 630 VAC
-------------------	------------------

Body Features

Environmental Protection Type	Sealed
-------------------------------	--------



Environmental Protection	IP67
Shell Plating Material	Electrodeposited Nickel
Shell Base Material	Zinc Alloy
Circular Connector Insulation Material Type	PA66

Mechanical Attachment

Mating Alignment	With
Mating Retention Type	Screw
Connector Mounting Type	Cable Mount (Free-Hanging)
Mating Retention	With

Housing Features

Circular Connector Shell Size	23
Alignment Keyed	0°

Dimensions

Cable Diameter Range	7.5 – 12 mm[.29 – .47 in]
----------------------	---------------------------

Usage Conditions

IP Water Sealing Level	IP67
Operating Temperature Range	-20 – 130 °C[-4 – 266 °F]

Operation/Application

Durability Rating	500 Cycles
Circuit Application	Power & Signal
Shielded	Yes

Industry Standards

Compatible With Approved Standards Products	UL
UL Flammability Rating	UL 94V-0

Product Compliance

For compliance documentation, visit the product page on TE.com>

EU RoHS Directive 2011/65/EU	Compliant with Exemptions
EU ELV Directive 2000/53/EC	Compliant with Exemptions
China RoHS 2 Directive MIIT Order No 32, 2016	Restricted Materials Above Threshold
EU REACH Regulation (EC) No. 1907/2006	Current ECHA Candidate List: JUNE 2024 (241)



Candidate List Declared Against: JAN 2024  
(240)  
SVHC > Threshold:  
Pb (3.5% in Component)



Article Safe Usage Statements:  
Do not eat, drink or smoke when using this product. Wash thoroughly after handling. Recycle if possible and dispose of the article by following all applicable governmental regulations relevant to your geographic location.

Halogen Content	Not Yet Reviewed for halogen content
Solder Process Capability	Not applicable for solder process capability

Product Compliance Disclaimer

This information is provided based on reasonable inquiry of our suppliers and represents our current actual knowledge based on the information they provided. This information is subject to change. The part numbers that TE has identified as EU RoHS compliant have a maximum concentration of 0.1% by weight in homogenous materials for lead, hexavalent chromium, mercury, PBB, PBDE, DBP, BBP, DEHP, DIBP, and 0.01% for cadmium, or qualify for an exemption to these limits as defined in the Annexes of Directive 2011/65/EU (RoHS2). Finished electrical and electronic equipment products will be CE marked as required by Directive 2011/65/EU. Components may not be CE marked. Additionally, the part numbers that TE has identified as EU ELV compliant have a maximum concentration of 0.1% by weight in homogenous materials for lead, hexavalent chromium, and mercury, and 0.01% for cadmium, or qualify for an exemption to these limits as defined in the Annexes of Directive 2000/53/EC (ELV). Regarding the REACH Regulation, the information TE provides on SVHC in articles for this part number is based on the latest European Chemicals Agency (ECHA) ‘Guidance on requirements for substances in articles’ posted at this URL: <https://echa.europa.eu/guidance-documents/guidance-on-reach>

Compatible Parts

 <p>TE Part # BGC110N00001216000 923 RECEPTACLE, ANGLED, ROTATABLE</p>	 <p>TE Part # C0-0003-000-000 POSITIONING INSERT FOR 1 MM CONTACTS</p>	 <p>TE Part # C0-0004-000-000 POSITIONING INSERT FOR 2 MM CONTACTS</p>	<p>TE Part # C0-0101-000-P00 CRIMPING TOOL SMALL WITH POSITIONER</p>
<p>TE Part # C0-0201-000-P00 CRIMPING TOOL MID-SIZE</p>	<p>TE Part # C0-0235-000-P00 DIGITAL CRIMPING TOOL, SMALL</p>	<p>TE Part # C0-0236-000-P00 DIGITAL CRIMPING TOOL, MID SIZE</p>	

Customers Also Bought

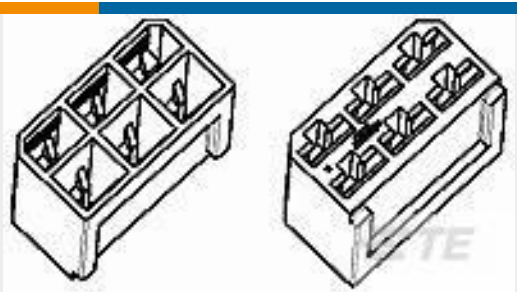

TE Part #280314  
FF 250 REC HSG 6P NYLON CLEAR

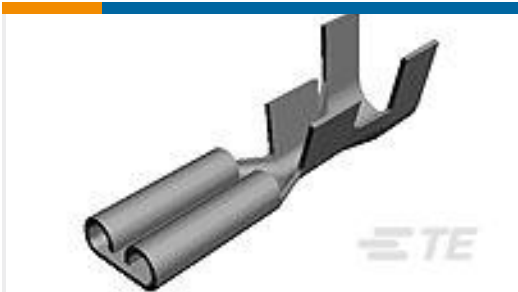

TE Part #5-160321-2  
FASTON 110 REC 22-20 AWG  
ELECTRO TPBR

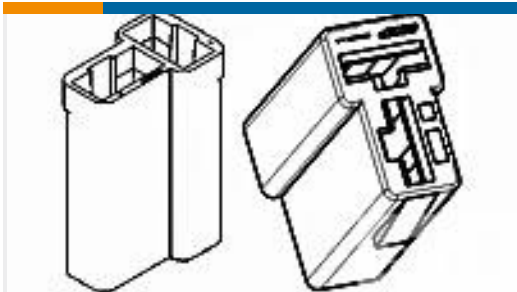

TE Part #180907  
FF 250 REC HSG 2P NYLON NAT



TE Part #8-34142-1  
PG R 22-16 COMM 22-18 MIL 6



TE Part #3-1617033-4  
HFW1230K11M = M39016/6-141M



TE Part #AGC113N00001215000  
623 RECEPTACLE ANGLED  
ROTATABLE



TE Part #650082-000  
D-436-58



TE Part #BKA199N00110200000  
923 EXTENSION, SPEEDTEC-READY



TE Part #AKA034N00090200000  
623 EXTENSION, SPEEDTEC-READY

Documents

Product Drawings

923 PLUG, SHORT

English

CAD Files

3D PDF

3D

Customer View Model

ENG\_CVM\_CVM\_BSA108N00550236000\_A.2d\_dxf.zip

English

Customer View Model

ENG\_CVM\_CVM\_BSA108N00550236000\_A.3d\_igs.zip

English

Customer View Model

ENG\_CVM\_CVM\_BSA108N00550236000\_A.3d\_stp.zip

English

By downloading the CAD file I accept and agree to the [Terms and Conditions](#) of use.

Datasheets & Catalog Pages



BSA108N00550236000

English

fuer Datenblaetter, die online konfigurierbar sind

German

Product Specifications

German