

Actuator

17-210352

Distribution by
DigiKey**DigiKey**<https://digikey.eao.com/p/17-210352>

Your product:



17-210352 Actuator

FRONT

Reflector:	Metal, polished chromium-plated
Front form:	round
Front dimension:	Ø 16 mm

MOUNTING

Design:	raised
Mounting cut-out:	Ø 14 mm

OPERATING-/INDICATION PART

Illumination colour:	Yellow
----------------------	--------

ELECTRICAL CHARACTERISTICS

Polarity:	Anode (+) Brass plug-in connector Cathode (-) Brass tinned plug-in connector
Lumi. Intensity:	70 mcd
Operation current:	20 mA ±15 %
Operating voltage:	24 V DC ±10 %

MECHANICAL CHARACTERISTIC

Tightening torque:	Fixing nut max. 0.2 Nm
Weight:	0.014 kg
Terminal:	Plug-in terminal, 2.8 x 0.8 mm

AMBIENT CONDITION

Storage temperature: – 25 °C ... + 80 °C

Operating temperature: – 20 °C ... + 60 °C

IP Protection: IP40 front side, IP65 front side, according to IEC 60529

CERTIFICATE

Conformities: 2011 / 65 / EC (RoHS), 2014 / 35 / EU (230 VAC)

Approbations: UL

OTHER

Short Description: Actuator, Ø 14 mm, Ø 16 mm, round, Plug-in terminal, 2.8 x 0.8 mm, Yellow

Hints: Connectors: Brass terminal = anode (+); brass tinned terminal = cathode (-), IP67 front side gap between LED and reflector and gap between reflector and frontplate sealed to IP67 when using the supplied gasket., The plastic is limited resistant to chemicals.

Kind of illumination: Single-LED

Wiring diagrams:

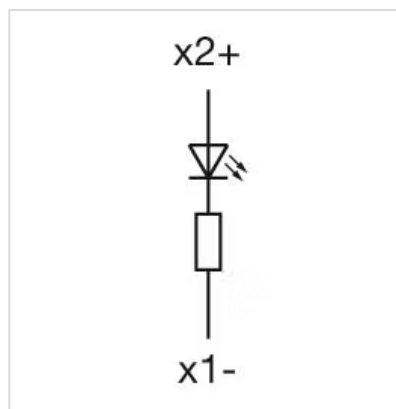

Mounting cut-outs:

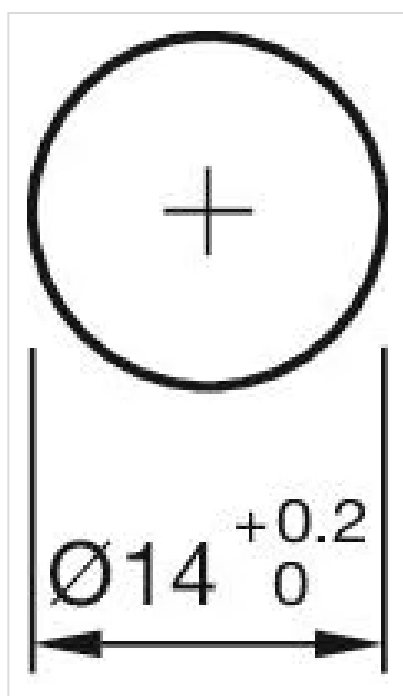

Dimension drawings:

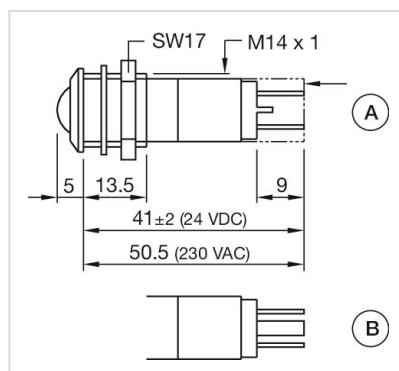

A = Protection tube (only 230 VAC)
B = Tri-colour