

## CATEGORIES

All

For more information or to request assistance, please contact [sales@precidip.com](mailto:sales@precidip.com)

[« Back to search results](#)

## YOUR SELECTED PRODUCT

## Screw-machined Contacts

01805

## Socket contacts

For other versions than the listed available standard types, please contact PRECI-DIP

## SPECIFICATIONS:

Socket contact with solder tail

- Press-in mount into dia 1.04 mm hole
- Materials: body brass, contact clip BeCu
- Electrical contact resistance max. 20 milliohms
- Mechanical life min. 500 cycles

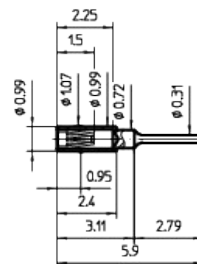
 Metric

## AVAILABLE STANDARD TYPES

Ordering Part Number		Plating Body	Plating Clip	Insertion	Extraction	Dia.Gauge	Max Current
01805-77-5410	RoHS	Flash Au	Flash Au	0.20 N	0.15 N	0.30 mm	3.0 A

## CAD CATALOG

Literature  
Catalog  
CAD catalog

## ABOUT PRECI-DIP

Career  
Contact  
Events

## OTHER INFO

Feedback  
Legal disclaimer  
Cross references

## NEWSLETTER

Stay informed!

subscription

This website is using cookies for statistics, site optimization and retargeting purposes. You consent to our cookies if you continue to use this website. [Read more here.](#)

powered by  [Accept](#)