

This drawing involves proprietary design rights of Tyco Electronics Corporation, and all design, manufacture, reproduction, use and sale rights regarding the same are expressly reserved. It is submitted for a specific purpose and the recipient by accepting this drawing, assumes custody and control and agrees to take reasonable precautions; (a) that this drawing will not be copied and reproduced, in whole or in part, or its contents revealed in any manner, or to any person except to meet the purpose for which it was delivered and (b) that any special features peculiar to this design will not be incorporated in other projects without the expressed written permission of Tyco Electronics Corporation.

REVISIONS			
EC	REV	DESCRIPTION	DATE
DS1Q-0002-05	A	NEW RELEASE	01/04/05

NOTES: UNLESS OTHERWISE SPECIFIED;

1. PART NUMBER CHANGES AND OR DESIGN CHANGES AFFECTING ITEM INTERCHANGEABILITY REQUIRE PRIOR ELCON APPROVAL AND AUTHORIZATION BY REVISION TO THIS DRAWING.
2. MATERIALS:

INSULATORS: THERMOPLASTIC, GLASS REINFORCED, COLOR-BLACK, UL94V-0 FLAMMABILITY RATED.

SIGNAL SOCKETS: PHOSPHOR BRONZE ALLOY.

POWER SOCKET CONTACTS: PHOSPHOR BRONZE ALLOY.
3. FINISHES:

CONTACT PLATING: SELECTIVE GOLD PER MIL-G-45204 OVER NICKEL PER AMS 2404.

TERMINAL PLATING: TIN OVER NICKEL

4 REFER TO DRAWING 997-010 FOR MATING SEQUENCE & MISALIGNMENT.

5 ITEMS PROVIDED TO THIS SPECIFICATION TO BE PERMANENTLY IDENTIFIED PER THE FOLLOWING IDENTIFIER:

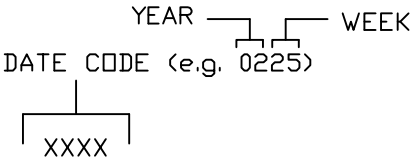

6. CONNECTOR INFORMATION

CONNECTOR	ELCON PART NUMBER	CONFIGURATION REF #	CONTACT	POSITION	CONTACT PITCH	VOLTAGE RATING*
SOCKET	376-0054-11200	TBD	SIGNAL	12-47	2.50 [.098]	60 VOLTS
			POWER	1-11	6.00 [.236]	60 VOLTS
SOCKET	376-0054-11130	TBD	SIGNAL	12-47	2.50 [.098]	60 VOLTS
			POWER	1-11	6.00 [.236]	60 VOLTS

\*IAW UL 60950

<div><div>MM INCH</div><div>OR MM [INCH]</div><div></div><div>THIRD ANGLE PROJECTION</div><div>UNLESS OTHERWISE SPECIFIED DIMENSIONS ARE IN METRIC [INCHES]</div><div>TOLERANCES</div><div>ANGLES ± .5°</div><div>DECIMALS</div><div>.XX ± .25 [.010]</div><div>.X ± .5 [.020]</div></div>	DRAWN	DATE	<div><div><div>tyco</div><div>Electronics</div></div><div>Tyco Electronics Corporation Menlo Park, Ca 94025</div><div>ELCON</div></div>			
	S. WAN	01/04/05				
	CHECKED		TITLE			
	APPROVED					
	APPROVED					
	D. CHAU	01/11/05	SIZE	DWG NUMBER	REV.	
	DCA APPROVED	01/26/05	B	C = 6651381	A	
	M. ALIM					
	ACAD FILE NUMBER	C6651381A.DWG			DWG SCALE 1 = 1	SH 1 OF 4

This drawing involves proprietary design rights of Tyco Electronics Corporation, and all design, manufacture, reproduction, use and sale rights regarding the same are expressly reserved. It is submitted for a specific purpose and the recipient by accepting this drawing, assumes custody and control and agrees to take reasonable precautions; (a) that this drawing will not be copied and reproduced, in whole or in part, or its contents revealed in any manner, or to any person except to meet the purpose for which it was delivered and (b) that any special features peculiar to this design will not be incorporated in other projects without the expressed written permission of Tyco Electronics Corporation.

REVISIONS			
EC	REV	DESCRIPTION	DATE
		SEE SHEET 1	

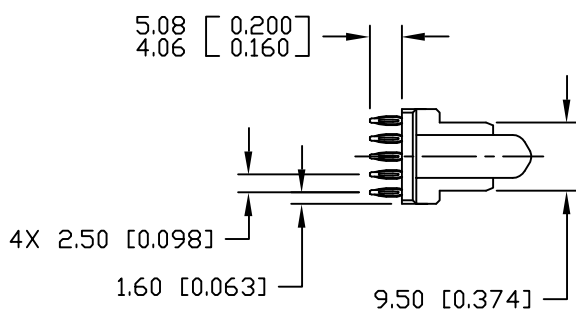

DETAIL A

RECOMMENDED PRINTED CIRCUIT HOLE  
FINISHED HOLE:  $\varnothing 1.02$  [0.040]  $\pm 0.08$  [0.003]  
DRILLED HOLE:  $\varnothing 1.15$  [0.0453]  $\pm 0.013$  [0.0005]  
COPPER PLATE: .025 [0.0010] MINIMUM (PER SURFACE)  
TIN PLATE: .008 [0.0003] MINIMUM (PER SURFACE)

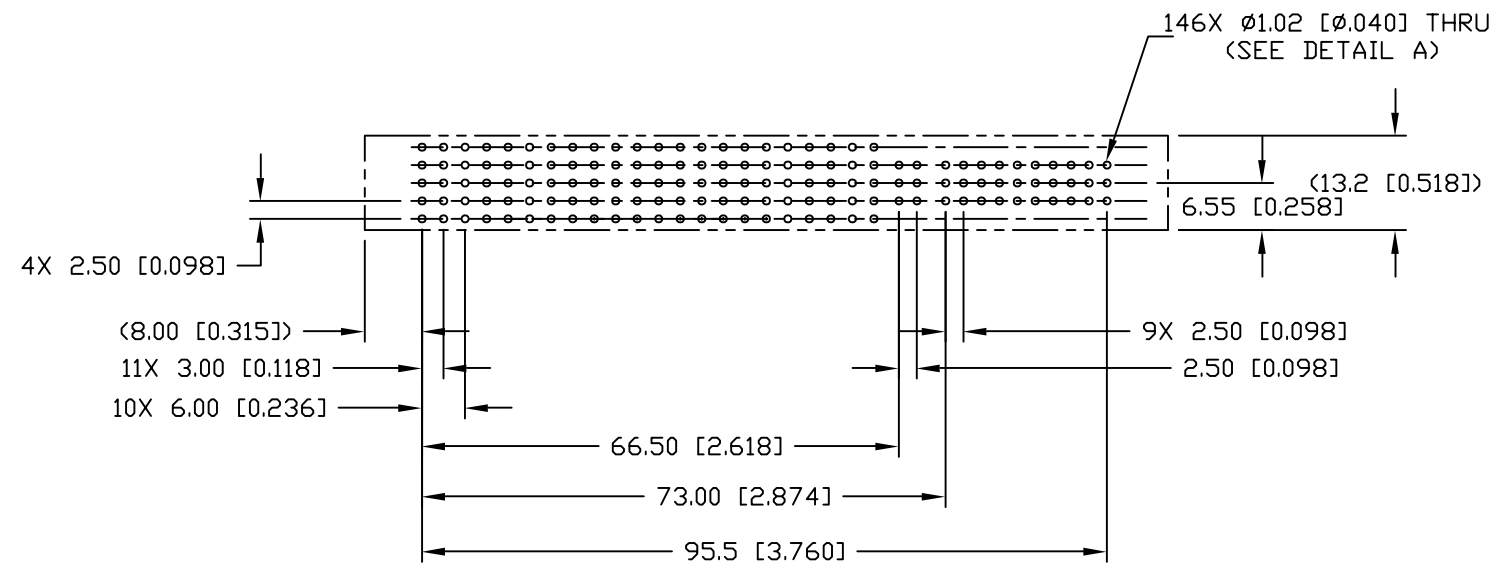
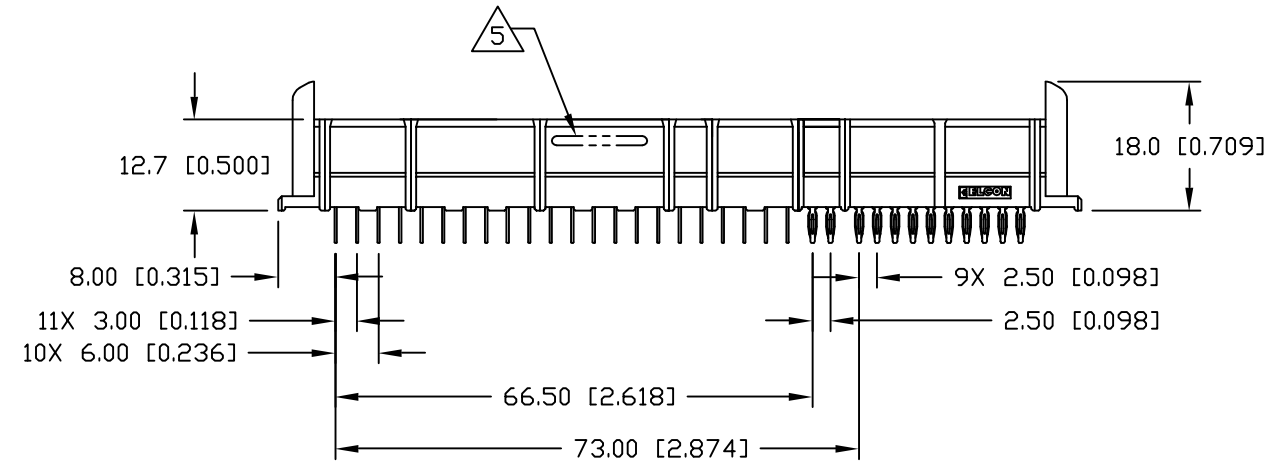
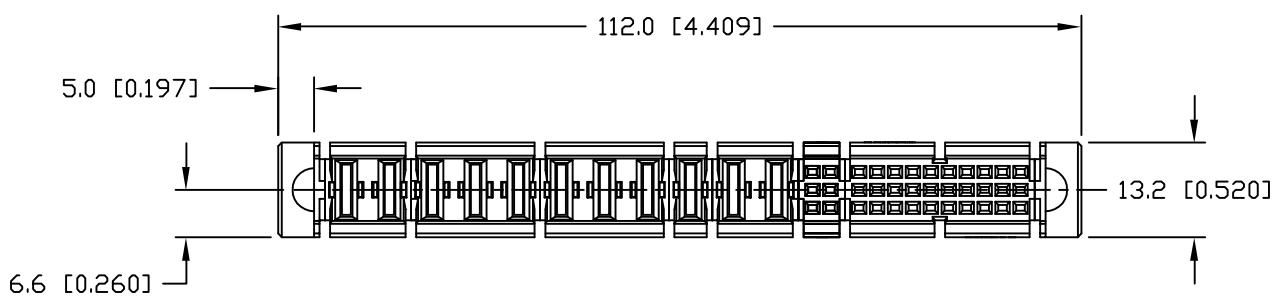

RECOMMENDED PC LAYOUT

<div><div><div>MM INCH</div><div>OR MM [INCH]</div></div><div></div><div>THIRD ANGLE PROJECTION</div></div> <div>UNLESS OTHERWISE SPECIFIED DIMENSIONS ARE IN METRIC [INCHES]</div> <div>TOLERANCES</div> <div>ANGLES ± .5°</div> <div>DECIMALS</div> <div>.XX ± .25 [.010]</div> <div>.X ± .5 [.020]</div>	DRAWN S. WAN	DATE 01/04/05	<div><div><div><div>tyco</div><div>Electronics</div></div><div>Tyco Electronics Corporation Menlo Park, Ca 94025</div></div><div>ELCON</div></div>		
	CHECKED		TITLE  SOCKET CONNECTOR, MINIPAK STRAIGHT, COMPLIANT TAILS PN: 376-0054-11200A		
	APPROVED				
	APPROVED				
	D. CHAU	01/11/05	SIZE B	DWG NUMBER C = 6651381	REV. A
DCA APPROVED M. ALIM	01/26/05				
ACAD FILE NUMBER		C6651381A.DWG		DWG SCALE 1 = 1	SH 2 OF 4

This drawing involves proprietary design rights of Tyco Electronics Corporation, and all design, manufacture, reproduction, use and sale rights regarding the same are expressly reserved. It is submitted for a specific purpose and the recipient by accepting this drawing, assumes custody and control and agrees to take reasonable precautions; (a) that this drawing will not be copied and reproduced, in whole or in part, or its contents revealed in any manner, or to any person except to meet the purpose for which it was delivered and (b) that any special features peculiar to this design will not be incorporated in other projects without the expressed written permission of Tyco Electronics Corporation.

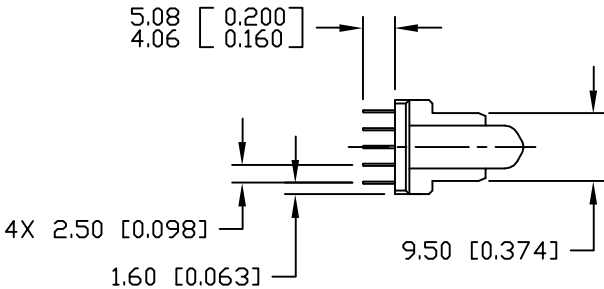

DETAIL A

RECOMMENDED PRINTED CIRCUIT HOLE

FINISHED HOLE:  $\phi 1.02$  [0.040]  $\pm 0.08$  [0.003]  
DRILLED HOLE:  $\phi 1.15$  [0.0453]  $\pm 0.013$  [0.0005]  
COPPER PLATE: .025 [0.0010] MINIMUM (PER SURFACE)  
TIN PLATE: .008 [0.0003] MINIMUM (PER SURFACE)

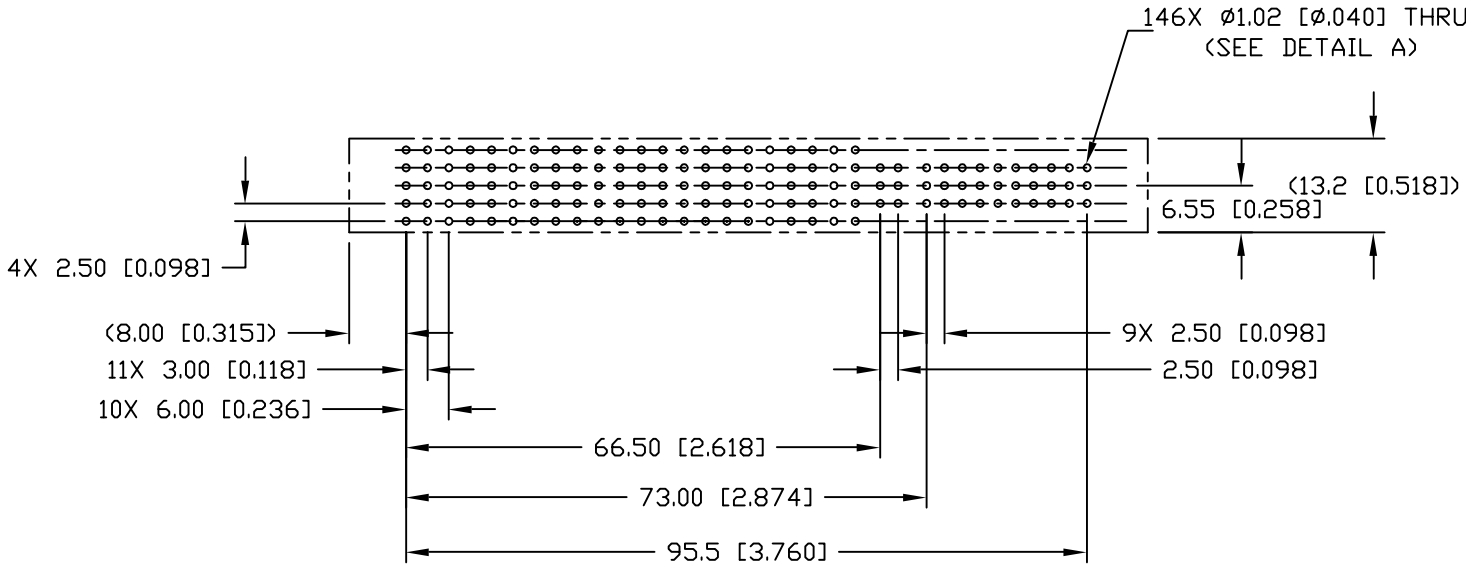

RECOMMENDED PC LAYOUT

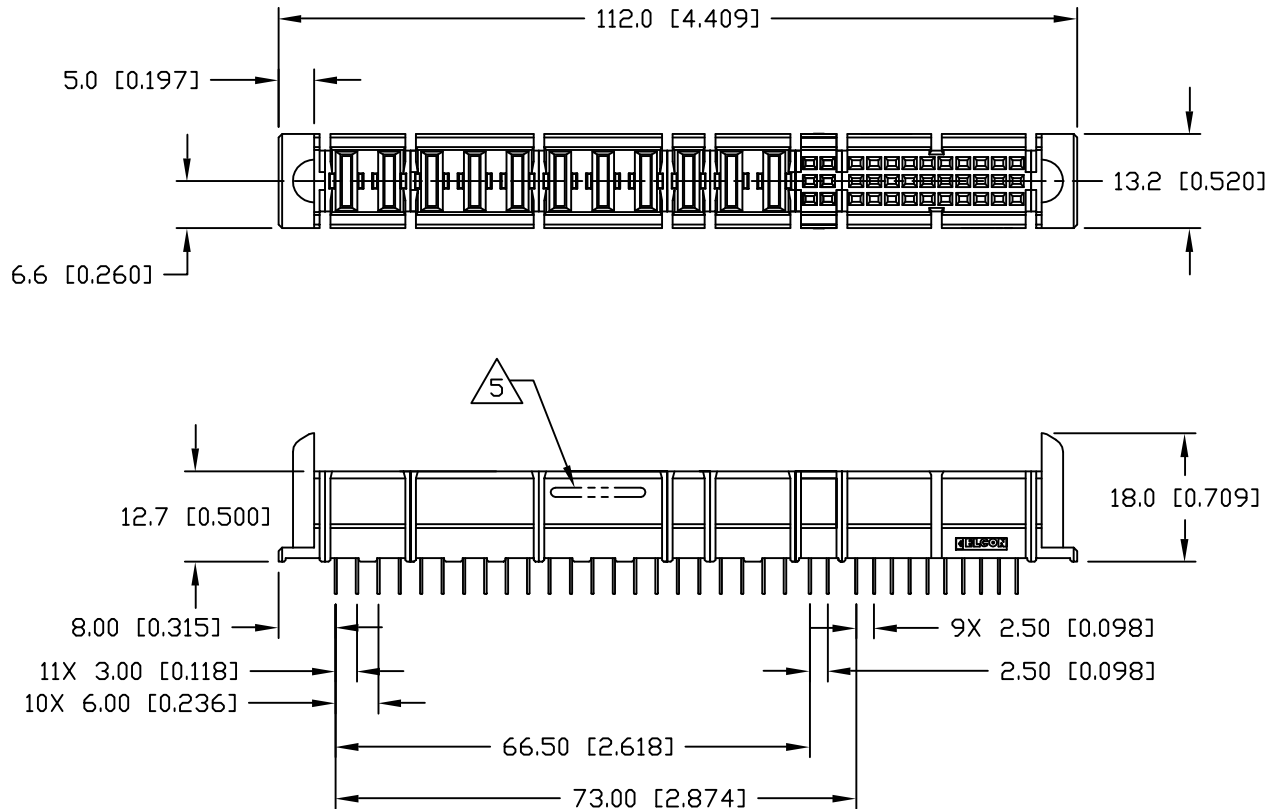

<div>MM INCH</div> <div></div> <div>THIRD ANGLE PROJECTION</div> <div>UNLESS OTHERWISE SPECIFIED DIMENSIONS ARE IN METRIC [INCHES]</div> <div>TOLERANCES</div> <div>ANGLES <math>\pm .5^\circ</math></div> <div>DECIMALS</div> <div>.XX <math>\pm .25</math> [0.010]</div> <div>.X <math>\pm .5</math> [0.020]</div>	DRAWN S. WAN	DATE 01/04/05	<div><b>tyco</b> Tyco Electronics Corporation <b>Electronics</b> Menlo Park, Ca 94025</div> <div><b>ELCON</b></div>	
	CHECKED		TITLE SOCKET CONNECTOR, MINIPAK STRAIGHT, SOLDER TAILS PN: 376-0054-11130A	
	APPROVED		SIZE B	DWG NUMBER C = 6651381
	APPROVED D. CHAU DCA APPROVED M. ALIM	01/11/05 01/26/05	REV. A	
ACAD FILE NUMBER C6651381A.DWG			DWG SCALE 1=1	SH 3 OF 4

This drawing involves proprietary design rights of Tyco Electronics Corporation, and all design, manufacture, reproduction, use and sale rights regarding the same are expressly reserved. It is submitted for a specific purpose and the recipient by accepting this drawing, assumes custody and control and agrees to take reasonable precautions; (a) that this drawing will not be copied and reproduced, in whole or in part, or its contents revealed in any manner, or to any person except to meet the purpose for which it was delivered and (b) that any special features peculiar to this design will not be incorporated in other projects without the expressed written permission of Tyco Electronics Corporation.

REVISIONS			
EC	REV	DESCRIPTION	DATE
		SEE SHEET 1	

PCB

PCB

PCB

PCB

PCB

PCB

PCB

PCB

PCB

PCB

PCB

PCB

PCB

PCB

PCB

PCB

PCB

PCB

PCB

PCB

PCB

PCB

PCB

PCB

PCB

PCB

PCB

PCB

PCB

PCB

PCB

PCB

PCB

PCB

PCB

PCB

PCB

PCB

PCB

PCB

PCB

PCB

PCB

PCB

PCB

PCB

PCB

PCB

PCB

PCB

PCB

PCB

PCB

PCB

PCB

PCB

PCB

PCB

PCB

PCB

PCB

PCB

PCB

PCB

PCB

PCB

PCB

PCB

PCB

PCB

PCB

PCB

PCB

PCB

PCB

PCB

PCB

PCB

PCB

PCB

PCB

PCB

PCB

PCB

PCB

PCB

PCB

PCB

PCB

PCB

PCB

PCB

PCB

PCB

PCB

PCB

PCB

PCB

PCB

PCB

PCB

PCB

PCB

PCB

PCB

PCB

PCB

PCB

PCB

PCB

PCB

PCB

PCB

PCB

PCB

PCB

PCB

PCB

PCB

PCB

PCB

PCB

PCB

PCB

PCB

PCB

PCB

PCB

PCB

PCB

PCB

PCB

PCB

PCB

PCB

PCB

PCB

PCB

PCB

PCB

PCB

PCB

PCB

PCB

PCB

PCB

PCB

PCB

PCB

PCB

PCB

PCB

PCB

PCB

PCB

PCB

PCB

PCB

PCB

PCB

PCB

PCB

PCB

PCB

PCB

PCB

PCB

PCB

PCB

PCB

PCB

PCB

PCB

PCB

PCB

PCB

PCB

PCB

PCB

PCB

PCB

PCB

PCB

PCB

PCB

PCB

PCB

PCB

PCB

PCB

PCB

PCB

PCB

PCB

PCB

PCB

PCB

PCB

PCB

PCB

PCB

PCB

PCB

PCB

PCB

PCB

PCB

PCB

PCB

PCB

PCB

PCB

PCB

PCB

PCB

PCB

PCB

PCB

PCB

PCB

PCB

PCB

PCB

PCB

PCB

PCB

PCB

PCB

PCB

PCB

PCB

PCB

PCB

PCB

PCB

PCB

PCB

PCB

PCB

PCB

PCB

PCB

PCB

PCB

PCB

PCB

PCB

PCB

PCB

PCB

PCB

PCB

PCB

PCB

PCB

PCB

PCB

PCB

PCB

PCB

PCB

PCB

PCB

PCB

PCB

PCB

PCB

PCB

PCB

PCB

PCB

PCB

PCB

PCB

PCB

PCB

PCB

PCB

PCB

PCB

PCB

PCB

PCB

PCB

PCB

PCB

PCB

PCB

PCB

PCB

PCB

PCB

PCB

PCB

PCB

PCB

PCB

PCB

PCB

PCB

PCB

PCB

PCB

PCB

PCB

PCB

PCB

PCB

PCB

PCB

PCB

PCB

PCB

PCB

PCB

PCB

PCB

PCB

PCB

PCB

PCB

PCB

PCB

PCB

PCB

PCB

PCB

PCB

PCB

PCB

PCB

PCB

PCB

PCB

PCB

PCB

PCB

PCB

PCB

PCB

PCB

PCB

PCB

PCB

PCB

PCB

PCB

PCB

PCB

PCB

PCB

PCB

PCB

PCB

PCB

PCB

PCB

PCB

PCB

PCB

PCB

PCB

PCB

PCB

PCB

PCB

PCB

PCB

PCB

PCB

PCB

PCB

PCB

PCB

PCB

PCB

PCB

PCB

PCB

PCB

PCB

PCB

PCB

PCB

PCB

PCB

PCB

PCB

PCB

PCB

PCB

PCB

PCB

PCB

PCB

PCB

PCB

PCB

PCB

PCB

PCB

PCB

PCB

PCB

PCB

PCB

PCB

PCB

PCB

PCB

PCB

PCB

PCB

PCB

PCB

PCB

# Mouser Electronics

Authorized Distributor

Click to View Pricing, Inventory, Delivery & Lifecycle Information:

[TE Connectivity:](#)

[6651381-1](#)