

Actuator

704.097.010

Distribution by
DigiKey

DigiKey



<https://digikey.eao.com/p/704.097.010>

Your product:



704.097.010 Actuator

FRONT

Front bezel material:	Aluminium
Front bezel colour:	Black
Front dimension:	Ø 35 mm

MOUNTING

Design:	flush
Mounting cut-out:	Ø 30.5 mm

OPERATING-/INDICATION PART

Lever shape:	long
Lever colour:	Black
Lever material:	plastic

ELECTRICAL CHARACTERISTICS

Standards:	The switches comply with the "Standards for low-voltage switching devices" DIN EN 60947-1
------------	---

MECHANICAL CHARACTERISTIC

Switching positions:	3 positions
Switching action:	Maintained - Rest - Momentary
Switching angle:	42° left / 42° right
Weight:	0.056 kg
Mechanical lifetime:	≤2.5 Mio. cycles of operation

AMBIENT CONDITION

IP Protection:	IP65 front side
Storage temperature:	– 40 °C ... + 85 °C
Operating temperature:	– 40 °C ... + 55 °C

OTHER

Short Description:	Actuator, Ø 30.5 mm, Ø 35 mm, non illuminative, Black, long, Black, Aluminium, anodised, Maintained - Rest - Momentary
---------------------------	--

max. number of switching elements:	3
---	---

Hints:	Max. 3 switching elements can be clipped on
---------------	---

Switching positions:

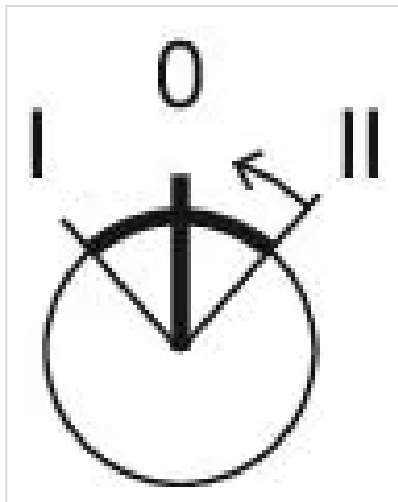

Wiring diagrams:



Dimension drawings:

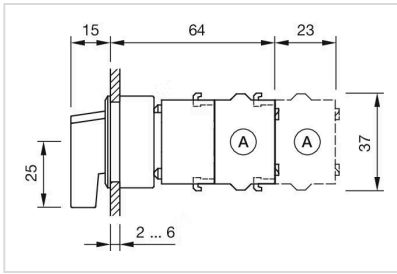

A = Screw terminal

Mounting cut-outs:

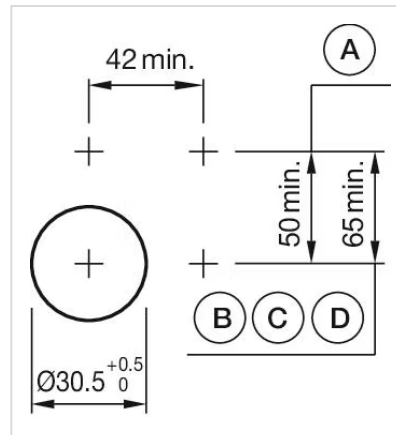

A = Screw terminal

B = Push-in terminal (PIT)

C = Plug-in terminal 6.3 mm x 0.8 mm

D = Double plug-in terminal 6.3 mm x 0.8 mm