

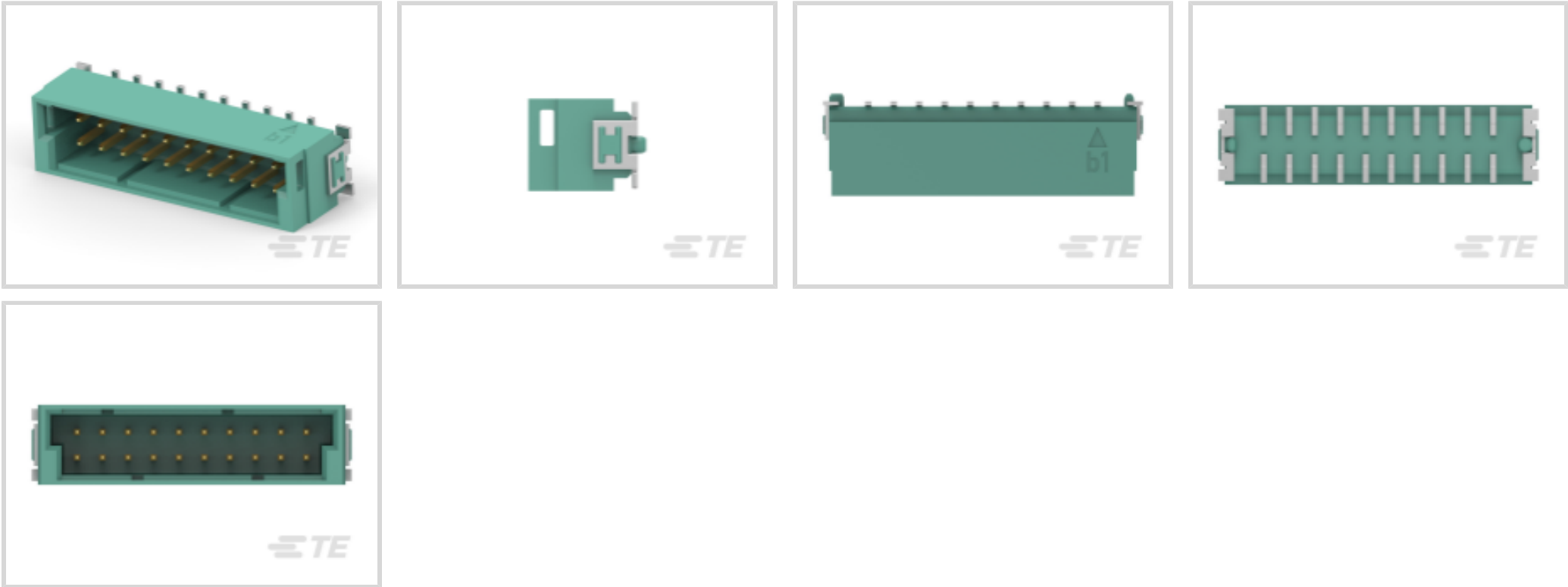

Connectors > PCB Connectors > PCB Headers & Receptacles



Connector System: **Board-to-Board**

Number of Positions: **20**

Centerline (Pitch): **2.54 mm [.1 in]**

PCB Mount Orientation: **Right Angle**

Number of Rows: **2**

Features

Product Type Features

Connector Shape	Rectangular
PCB Connector Assembly Type	PCB Mount Header
Header Type	Fully Shrouded
Connector System	Board-to-Board
Connector & Contact Terminates To	Printed Circuit Board

Configuration Features

Number of Columns	10
Board-to-Board Configuration	Perpendicular
Number of Loaded Positions	20
Connector Contact Load Condition	Fully Loaded
Number of Positions	20
PCB Mount Orientation	Right Angle
Number of Rows	2

Electrical Characteristics



Insulation Resistance	100 MΩ
Dielectric Withstanding Voltage (Max)	500 Vrms

Body Features

Primary Product Color	Green
-----------------------	-------

Contact Features

PCB Contact Termination Area Plating Material Thickness	4 – 6 μm[157.48 – 236.22 μin]
Contact Layout	Matrix
Contact Type	Pin
PCB Contact Termination Area Plating Material	Tin
Contact Base Material	Copper Alloy
Contact Mating Area Plating Material	Gold (Au)
Contact Current Rating (Max)	11.1 A

Termination Features

Termination Method to PCB	Surface Mount
---------------------------	---------------

Mechanical Attachment

Mounting Alignment Feature Length	.75 mm[.029 in]
PCB Mount Alignment Type	Pegs
Mating Alignment Type	Polarization
Mating Alignment	With
PCB Mount Alignment	With
PCB Mount Retention	Without
Connector Mounting Type	Board Mount

Housing Features

Centerline (Pitch)	2.54 mm[.1 in]
--------------------	----------------

Usage Conditions

Operating Temperature (Max)	105 °C[221 °F]
Operating Temperature Range	-40 – 105 °C[-40 – 221 °F]

Operation/Application

Circuit Application	Power & Signal
---------------------	----------------

Industry Standards

UL Flammability Rating	UL 94V-0
------------------------	----------



Packaging Features

Packaging Method	Tape & Reel
------------------	-------------

Product Compliance

For compliance documentation, visit the product page on TE.com>

EU RoHS Directive 2011/65/EU	Compliant
EU ELV Directive 2000/53/EC	Compliant
China RoHS 2 Directive MIIT Order No 32, 2016	No Restricted Materials Above Threshold
EU REACH Regulation (EC) No. 1907/2006	Current ECHA Candidate List: JUNE 2024 (241) Candidate List Declared Against: JUNE 2023 (235) Does not contain REACH SVHC
Halogen Content	Not Yet Reviewed for halogen content
Solder Process Capability	Not reviewed for solder process capability

Product Compliance Disclaimer

This information is provided based on reasonable inquiry of our suppliers and represents our current actual knowledge based on the information they provided. This information is subject to change. The part numbers that TE has identified as EU RoHS compliant have a maximum concentration of 0.1% by weight in homogenous materials for lead, hexavalent chromium, mercury, PBB, PBDE, DBP, BBP, DEHP, DIBP, and 0.01% for cadmium, or qualify for an exemption to these limits as defined in the Annexes of Directive 2011/65/EU (RoHS2). Finished electrical and electronic equipment products will be CE marked as required by Directive 2011/65/EU. Components may not be CE marked. Additionally, the part numbers that TE has identified as EU ELV compliant have a maximum concentration of 0.1% by weight in homogenous materials for lead, hexavalent chromium, and mercury, and 0.01% for cadmium, or qualify for an exemption to these limits as defined in the Annexes of Directive 2000/53/EC (ELV). Regarding the REACH Regulation, the information TE provides on SVHC in articles for this part number is based on the latest European Chemicals Agency (ECHA) 'Guidance on requirements for substances in articles' posted at this URL: <https://echa.europa.eu/guidance-documents/guidance-on-reach>

Compatible Parts



TE Part # 474008-E  
DRCQ 2,54 10 M \* SMD \* 137 E012  
167 GU-H

Also in the Series | ERNI MaxiBridge



Connector Contacts(4)



Hand Crimping Tools(2)



PCB Headers & Receptacles(29)



Pluggable I/O Cable Assemblies(9)



Wire-to-Board Connector Assemblies & Housings(22)

Customers Also Bought

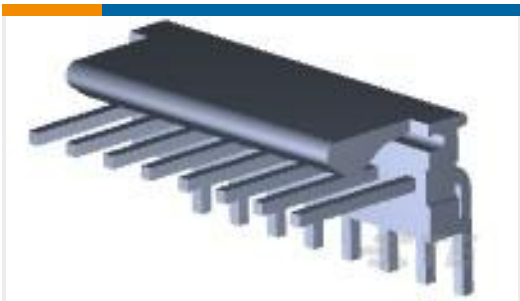

TE Part #3-641216-8  
08P MTA100 HDR ASSY FL/RA LF

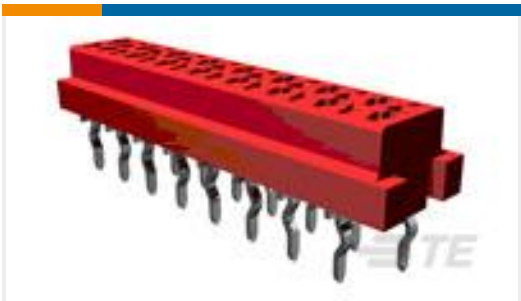

TE Part #215079-6  
MICRO-MATCH FOB.06P



TE Part #3-644563-4  
04P MTA100 CONN ASSY F/T 24AWG



TE Part #3-794636-4  
04P MICRO MNL ASSY,VRT,SMT,LF



TE Part #640388-4  
04P MTA156 HDR ASSY RN STR F/L

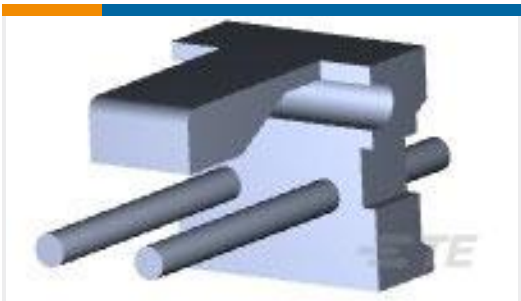

TE Part #640388-2  
02P MTA156 HDR ASSY RN STR F/L



TE Part #928814-1  
250 FASTON TAB TPBR



TE Part #2118714-2  
STD SHIELD FRAME, CRS-13.66X12.70X2.54MM



TE Part #3-641199-5  
05P MTA100 CONN ASSY WHT LF



TE Part #474006-E  
DRCQ 2,54 10 M \* SMD \* 137 E012 094 GU-H

Documents



Product Drawings

[DRCQ 2,54 20 M \\* SMD \\* 137 E012 167 GU-H](#)

German

CAD Files

Customer View Model

[ENG\\_CVM\\_CVM\\_464688-E\\_1.3d\\_igs.zip](#)

English

Customer View Model

[ENG\\_CVM\\_CVM\\_464688-E\\_1.3d\\_stp.zip](#)

English

Customer View Model

[ENG\\_CVM\\_CVM\\_464688-E\\_1.2d\\_dxf.zip](#)

English

3D PDF

3D

By downloading the CAD file I accept and agree to the [Terms and Conditions](#) of use.

Datasheets & Catalog Pages

[Datasheet - ERNI MixiBridge 2.54mm Connectors](#)

English

[Datasheet - ERNI MixiBridge 2.54mm Connectors](#)

German