



Features

- Formerly J. W. Miller® model
- Current rating up to 3.9 A
- Inductance range: 10 μ H to 1000 μ H
- Shielded construction
- RoHS compliant*



This series is obsolete and not recommended for new designs.

Applications

- DC/DC converters
- Power supplies
- Desktop notebooks
- Output chokes

RL110S Series - Radial Lead RF Choke

Electrical Specifications (@ 25 °C)

Part Number	Inductance (μ H)	Tol.	Q	Test Frequency		SRF (MHz) Typ.	DCR (Ω) Max.	I dc (A)
				L	Q			
RL110S-100M-RC	10	$\pm 20\%$	50	2.52 MHz	2.52 MHz	32	0.023	3.9
RL110S-120M-RC	12	$\pm 20\%$	50	2.52 MHz	2.52 MHz	26	0.024	3.6
RL110S-150M-RC	15	$\pm 20\%$	50	2.52 MHz	2.52 MHz	23	0.036	3.2
RL110S-180M-RC	18	$\pm 20\%$	50	2.52 MHz	2.52 MHz	20	0.039	2.9
RL110S-220M-RC	22	$\pm 20\%$	50	2.52 MHz	2.52 MHz	14	0.042	2.6
RL110S-270M-RC	27	$\pm 20\%$	40	2.52 MHz	2.52 MHz	12	0.045	2.4
RL110S-330L-RC	33	$\pm 15\%$	40	2.52 MHz	2.52 MHz	10	0.057	2.1
RL110S-390L-RC	39	$\pm 15\%$	40	2.52 MHz	2.52 MHz	8.5	0.076	2.0
RL110S-470L-RC	47	$\pm 15\%$	40	2.52 MHz	2.52 MHz	8.0	0.10	1.8
RL110S-560L-RC	56	$\pm 15\%$	35	2.52 MHz	2.52 MHz	7.5	0.11	1.6
RL110S-680L-RC	68	$\pm 15\%$	35	2.52 MHz	2.52 MHz	6.0	0.15	1.5
RL110S-820L-RC	82	$\pm 15\%$	35	2.52 MHz	2.52 MHz	4.7	0.16	1.4
RL110S-101L-RC	100	$\pm 15\%$	30	1 KHz	0.79 MHz	4.4	0.19	1.2
RL110S-121L-RC	120	$\pm 15\%$	30	1 KHz	0.79 MHz	4.2	0.21	1.1
RL110S-151L-RC	150	$\pm 15\%$	25	1 KHz	0.79 MHz	3.6	0.23	1.0
RL110S-181L-RC	180	$\pm 15\%$	25	1 KHz	0.79 MHz	3.3	0.26	0.92
RL110S-221L-RC	220	$\pm 15\%$	25	1 KHz	0.79 MHz	3.1	0.29	0.83
RL110S-271L-RC	270	$\pm 15\%$	25	1 KHz	0.79 MHz	2.9	0.36	0.75
RL110S-331L-RC	330	$\pm 15\%$	25	1 KHz	0.79 MHz	2.7	0.51	0.68
RL110S-391L-RC	390	$\pm 15\%$	25	1 KHz	0.79 MHz	2.4	0.69	0.62
RL110S-471L-RC	470	$\pm 15\%$	25	1 KHz	0.79 MHz	1.5	0.98	0.57
RL110S-561L-RC	560	$\pm 15\%$	20	1 KHz	0.79 MHz	2.0	1.10	0.52
RL110S-681L-RC	680	$\pm 15\%$	20	1 KHz	0.79 MHz	1.8	1.20	0.47
RL110S-821L-RC	820	$\pm 15\%$	10	1 KHz	0.79 MHz	1.6	1.30	0.43
RL110S-102L-RC	1000	$\pm 15\%$	50	1 KHz	0.25 MHz	1.5	1.50	0.39

How To Order

RL110S - 471L - RC

Model _____
 Value/Tolerance Code (see table) _____
 Compliance Code _____
 RC = RoHS Compliant

Example:

RL110S-471L-RC = 470 μ H, $\pm 15\%$

Electrical Schematic



General Specifications

Rated Current..... Inductance drop 10 %, or 40 °C temperature rise at I dc

Operating Temperature

.....-30 °C to +100 °C

Storage Temperature

.....-30 °C to +100 °C

Materials

Core Material..... Ferrite

Wire Enameled copper

Terminal Coating..... Sn/Ag/Cu alloy

Marking

..... Value code on top of inductor

Packaging

Standard..... 100 pcs. per bag

Product Dimensions

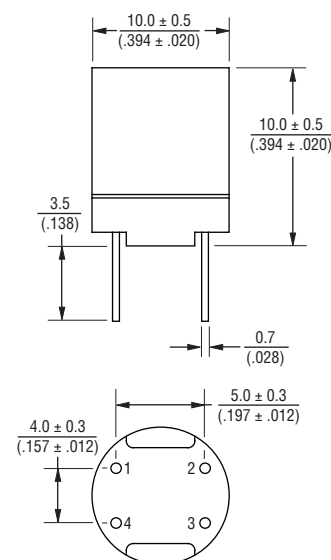

DIMENSIONS: $\frac{\text{MM}}{(\text{INCHES})}$

REV. 08/14

*RoHS Directive 2002/95/EC Jan. 27, 2003 including annex and RoHS Recast 2011/65/EU June 8, 2011.

Specifications are subject to change without notice.

The device characteristics and parameters in this data sheet can and do vary in different applications and actual device performance may vary over time.

Users should verify actual device performance in their specific applications.

Mouser Electronics

Authorized Distributor

Click to View Pricing, Inventory, Delivery & Lifecycle Information:

Bourns:

[RL110S-100M](#) [RL110S-101L](#) [RL110S-102L](#) [RL110S-120M](#) [RL110S-121L](#) [RL110S-150M](#) [RL110S-151L](#) [RL110S-180M](#) [RL110S-181L](#) [RL110S-220M](#) [RL110S-221L](#) [RL110S-270M](#) [RL110S-271L](#) [RL110S-330L](#) [RL110S-331L](#) [RL110S-390L](#) [RL110S-391L](#) [RL110S-470L](#) [RL110S-471L](#) [RL110S-560L](#) [RL110S-561L](#) [RL110S-680L](#) [RL110S-681L](#) [RL110S-820L](#) [RL110S-821L](#) [RL110S-150M-RC](#) [RL110S-471L-RC](#) [RL110S-271L-RC](#) [RL110S-561L-RC](#) [RL110S-181L-RC](#) [RL110S-681L-RC](#) [RL110S-331L-RC](#) [RL110S-820L-RC](#) [RL110S-390L-RC](#) [RL110S-270M-RC](#) [RL110S-560L-RC](#) [RL110S-102L-RC](#) [RL110S-151L-RC](#) [RL110S-821L-RC](#) [RL110S-470L-RC](#) [RL110S-101L-RC](#) [RL110S-391L-RC](#) [RL110S-120M-RC](#) [RL110S-220M-RC](#) [RL110S-680L-RC](#) [RL110S-121L-RC](#) [RL110S-221L-RC](#) [RL110S-100M-RC](#) [RL110S-180M-RC](#) [RL110S-330L-RC](#) [RL110S-470K-RC](#)