

# Actuator

704.011.618

Distribution by  
DigiKey

**DigiKey**



<https://digikey.eao.com/p/704.011.618>

Your product:

---



## 704.011.618 Actuator

### FRONT

Front dimension:	Ø 35 mm
Front form:	round
Front bezel material:	Aluminium
Front bezel colour:	Nature

### MOUNTING

Mounting cut-out:	Ø 30.5 mm
Design:	flush

### OPERATING-/INDICATION PART

Lens material:	Aluminium
Lens illumination:	non illuminative
Lens optics:	opaque
Lens shape:	flush
Lens colour:	Blue

### ELECTRICAL CHARACTERISTICS

Standards:	The switches comply with the "Standards for low-voltage switching devices" DIN EN 60947-1
------------	---

### MECHANICAL CHARACTERISTIC

Operating force:	8 N
Operating Travel:	ca. 5.8 mm ± 0.2 mm

<b>Switching action:</b>	Momentary
<b>Weight:</b>	0.051 kg
<b>Mechanical lifetime:</b>	≤3 Mio. cycles of operation

## AMBIENT CONDITION

<b>Storage temperature:</b>	– 40 °C ... + 85 °C
<b>IP Protection:</b>	IP65 front side
<b>Operating temperature:</b>	– 40 °C ... + 55 °C

## OTHER

<b>max. number of switching elements:</b>	3
<b>Housing colour:</b>	Grey
<b>Housing material:</b>	Plastic
<b>Short Description:</b>	Actuator, Ø 30.5 mm, Ø 35 mm, flush, non illuminative, Blue, Aluminium, opaque, round, Nature, Aluminium, anodised, Momentary
<b>Hints:</b>	Max. 3 switching elements can be clipped on, The colour of anodised aluminium parts can vary due to technical production reasons
<b>Mounting cut-outs:</b>	

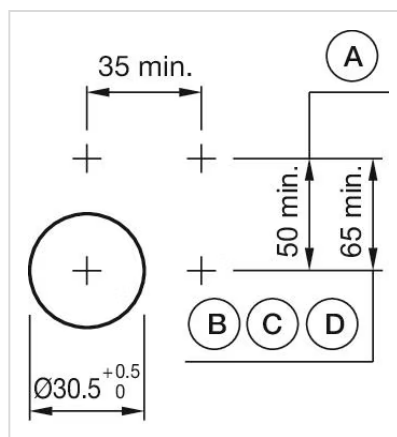

A = Screw terminal  
 B = Push-in terminal (PIT)  
 C = Plug-in terminal 6.3 mm x 0.8 mm  
 D = Double plug-in terminal 6.3 mm x 0.8 mm

## Wiring diagrams:

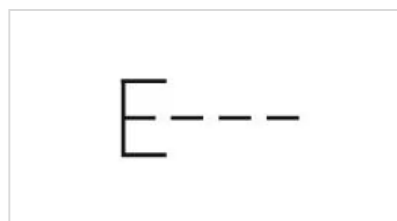

## Dimension drawings:

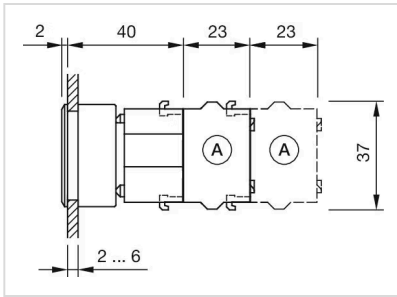

A = Screw terminal