

NOTES:

1. Material : Music Wire
2. Finish : Glod Irridite
3. Ends : Closed and Ground
4. Total Coils : 9.130
5. Sugg. Max. Deflection : 0.970 (in)
6. Sugg. Max. Load : 2.100 (lbs)
7. All Drawing Dimensions are in Inches [mm]

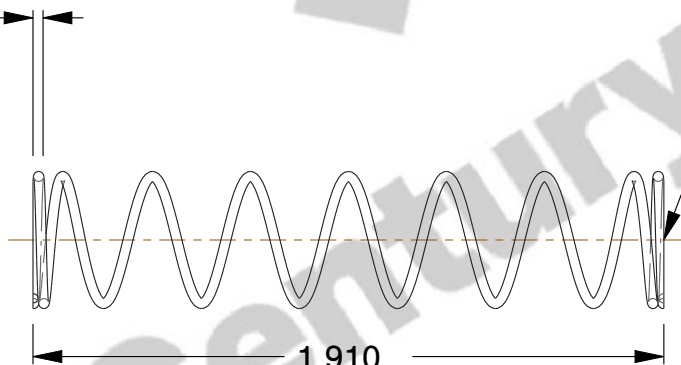

\varnothing 0.022
 [0,56]
 WIRE DIA



1.910
 [48,51]
 LENGTH

\varnothing 0.300
 [7,62]
 O.D

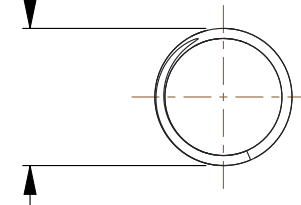

COMPONENT		SPRINGS	
70795 COMPRESSION SPRINGS		UNIT	INCH [mm]
		SHEET	1 of 1