

**Ordering number CA11053\_TINA2-O**

Family	Tina2	FWHM	(simulated) 36+14
Type	Assembly	Efficiency	89 %
LED	NCS19	cd/Im	-
Color	Black	Gerber File	Available
Diameter	16.1 mm		
Height	9.3 mm		
Style	Round		
Optic Material	PMMA		
Holder Material	PC		
Fastening	Pin, tape		
Status	Ready		

**Ordering number CA11020\_TINA2-RS**

Family	Tina2	FWHM	13 degrees
Type	Assembly	Efficiency	93 %
LED	NCS19	cd/Im	10.660
Color	Black	Gerber File	Available
Diameter	16.1 mm		
Height	9.3 mm		
Style	Round		
Optic Material	PMMA		
Holder Material	PC		
Fastening	Pin, tape		
Status	Ready		

**Ordering number CA11942\_TINA2-D**

Family	Tina2	FWHM	14 degrees
Type	Assembly	Efficiency	92 %
LED	NCS19	cd/Im	7.250
Color	Black	Gerber File	Available
Diameter	16.1 mm		
Height	9.3 mm		
Style	Round		
Optic Material	PMMA		
Holder Material	PC		
Fastening	Pin, tape		
Status	Ready		

**Ordering number CA11021\_TINA2-M**

Family	Tina2	FWHM	25 degrees
Type	Assembly	Efficiency	89 %
LED	NCS19	cd/Im	2.780
Color	Black	Gerber File	Available
Diameter	16.1 mm		
Height	9.3 mm		
Style	Round		
Optic Material	PMMA		
Holder Material	PC		
Fastening	Pin, tape		
Status	Ready		

**Ordering number** CA11022\_TINA2-W

Family	Tina2	FWHM	46 degrees
Type	Assembly	Efficiency	88 %
LED	NCS19	cd/lm	1.300
Color	Black	Gerber File	Available
Diameter	16.1 mm		
Height	9.3 mm		
Style	Round		
Optic Material	PMMA		
Holder Material	PC		
Fastening	Pin, tape		
Status	Ready		

**NOTE:** The typical divergence will be changed by different color, chip size and chip position tolerance. The typical total divergence is the full angle measured where the luminous intensity is half of the peak value.



## PRODUCT DATASHEET

### Tina2 series

last update 14/11/2012



#### GENERAL INFORMATION

- Product series especially designed & optimized for NCS19 series of LEDs.
- Special care taken to make light distribution as uniform as possible.
- Lens material optical grade PMMA with high UV and temperature resistance (105 degrees of Celcius / 220 degrees of Fahrenheit). Allows use of high current and temperature conditions.

Please find more information about used material from below:

[http://ledil.fi/sites/default/files/Documents/Technical/Material/PMMA%20N%20UL94\\_Yellow%20Card.pdf](http://ledil.fi/sites/default/files/Documents/Technical/Material/PMMA%20N%20UL94_Yellow%20Card.pdf)

<http://ledil.fi/sites/default/files/Documents/Technical/Material/PMMA%20N%20PLEXIGLAS-Datasheet.pdf>

- Optic holder molded by high quality PC material (120 dergees of Celcius / 248 degrees of Fahrenheit).

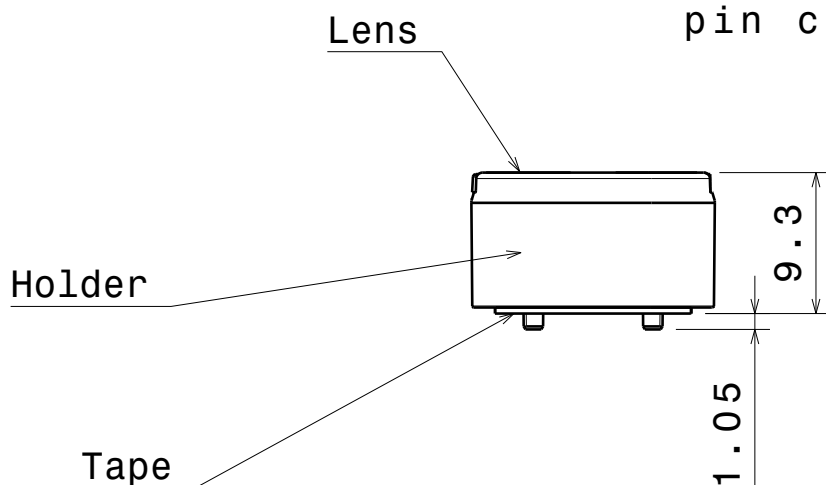
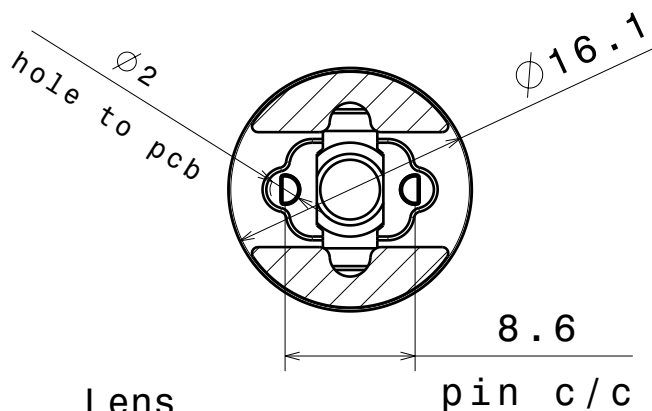
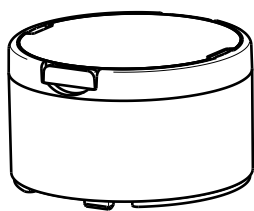

#### MATERIALS

Lens: PMMA

Holder: PC

Tape: PU Foam

#### Part no.s:

CA11020\_Tina2-RS-N119

CA11021\_Tina2-M-N119

CA11022\_Tina2-W-N119

CA11053\_Tina2-O-N119

CA11942\_Tina2-D-N119

This drawing is our property.  
It can't be reproduced  
or communicated without  
our written agreement.

LEDIL

L  
T  
F  
F

e  
e  
l  
i  
n

N

#### DRAWING TITLE

Datasheet Tina2-N119 series

DRAWN BY

p

DATE

09.12.2010

CHECKED BY

s

n

DATE

09.12.2010

DESIGNED BY

mav

DATE

10.10.2010

SIZE

A4

DRAWING NUMBER

-

REV

1

SCALE

2:1

WEIGHT (g)

-

SHEET

1 / 1

D

A

Luminaire: Ledil Oy CA11022\_TINA2-W (Nichia NCS19 95lm @ 250mA) Efficiency=88%  
Lamps: 1 x Nichia NCS19 95lm @ 250mA

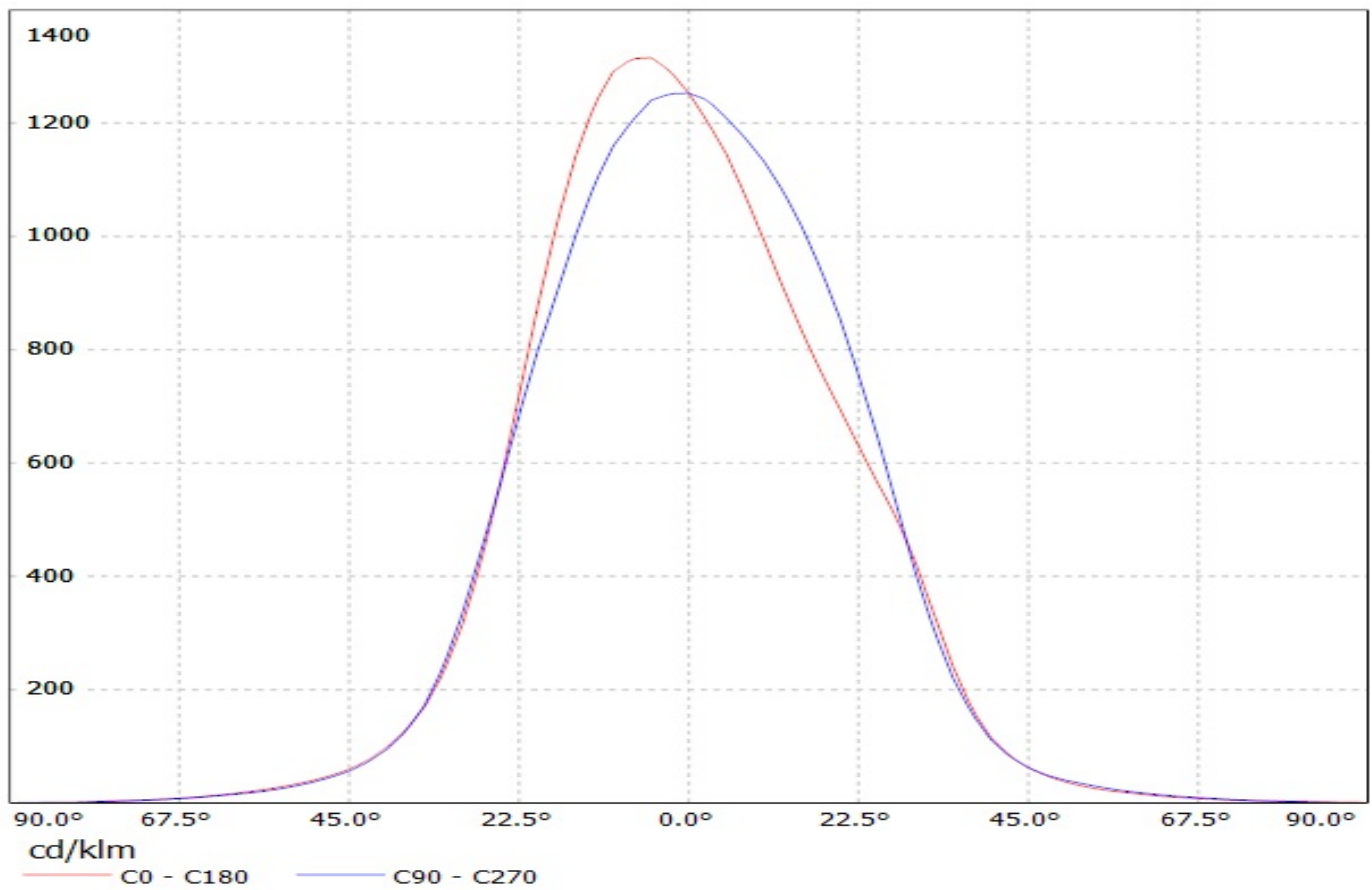

Luminaire: Ledil Oy CA11022\_TINA2-W (Nichia NCS19 95lm @ 250mA) Efficiency=88%  
Lamps: 1 x Nichia NCS19 95lm @ 250mA

