

# EV-GBG3PC-1AC32A-5,0M6,0ESBK01 - AC charging cable



1627605  
<https://www.phoenixcontact.com/us/products/1627605>

Please be informed that the data shown in this PDF document is generated from our online catalog. Please find the complete data in the user documentation. Our general terms of use for downloads are valid.



CHARX connect, Mobile AC charging cable, with vehicle charging connector and infrastructure charging plug, For charging electric vehicles (EV) with alternating current (AC) via GB/T vehicle charging inlets, with protective cap, GB/T, GB/T 20234.2-2015, GB/T 18487.1-2015, housing: black, gray, PHOENIX CONTACT logo, cable: 5 m, black, straight

## Product description

Mobile AC charging cable with vehicle connector and infrastructure plug for charging electric vehicles (EV) with alternating current (AC), via a GB/T vehicle charging inlet, compatible with GB/T Infrastructure Socket Outlets at charging stations for E-Mobility (EVSE)

## Your advantages

- Complete product range
- Convenient handling due to the ergonomic, triple award-winning design
- Available with your logo on request - for consistent branding of your charging station
- Longitudinal water tightness reliably prevents water ingress
- Developed and produced in accordance with the IATF 16949 automotive standard and ISO 9001
- Tested in accordance with automotive standards LV124, LV214, and LV215-2
- Tested in accordance with EV Ready 37 requirements

## Commercial data

Item number	1627605
Packing unit	1 pc
Minimum order quantity	1 pc
Product key	XWBAEF
Catalog page	Page 31 (C-7-2019)
GTIN	4055626342863
Weight per piece (including packing)	2,750 g
Weight per piece (excluding packing)	2,650 g
Country of origin	DE

# EV-GBG3PC-1AC32A-5,0M6,0ESBK01 - AC charging cable



1627605

<https://www.phoenixcontact.com/us/products/1627605>

## Technical data

### Product properties

Product type	AC charging cable
Product family	CHARX connect
Application	For charging electric vehicles (EV) with alternating current (AC) via GB/T vehicle charging inlets Compatible with GB/T infrastructure charging sockets at charging stations for electromobility (EVSE)
Type	Mobile AC charging cable with vehicle charging connector and infrastructure charging plug
Design	with protective cap
Affixed logo	PHOENIX CONTACT logo
Charging mode	Mode 3, Case B
Charging standard	GB/T

### Electrical properties

Type of charging current	AC single-phase
Charging power	8 kW
Charging current	32 A

### Material specifications

Color (Housing)	black (9005)
Color (Handle area)	gray (7042)
Color (Mating face)	black (9005)
Color (Protective cap)	black (9005)
Color (Cable)	black (9005)

### Cable/line

Cable length	5 m
Wiring standards/regulations	prEN 50620/DIN EN 50620
Wiring certifications	VDE
Cable weight	max. 305.00 kg/km
Cable type	Class 5
Cable type	straight
Cable structure	3 x 6.0 mm <sup>2</sup> + 1 x 0.5 mm <sup>2</sup>
External cable diameter	12.80 mm ±0.4 mm
Outer sheath, material	TPE-U
Cable resistance	≤ 0.0033 Ω/m (based on a power core, at an ambient temperature of 20°C)
Bending radius	min. 96 mm (7.5x diameter)
Cable length	5 m
External cable diameter	12.80 mm ±0.4 mm
Cable type	Class 5

# EV-GBG3PC-1AC32A-5,0M6,0ESBK01 - AC charging cable



1627605  
<https://www.phoenixcontact.com/us/products/1627605>

Wiring certifications	VDE
Wiring standards/regulations	prEN 50620/DIN EN 50620
Cable resistance	≤ 0.0033 Ω/m (based on a power core, at an ambient temperature of 20°C)

## Standards and regulations

Standards	
Standards/regulations	GB/T 20234.2-2015
	GB/T 18487.1-2015

# EV-GBG3PC-1AC32A-5,0M6,0ESBK01 - AC charging cable

1627605

<https://www.phoenixcontact.com/us/products/1627605>

## Drawings

Connection diagram

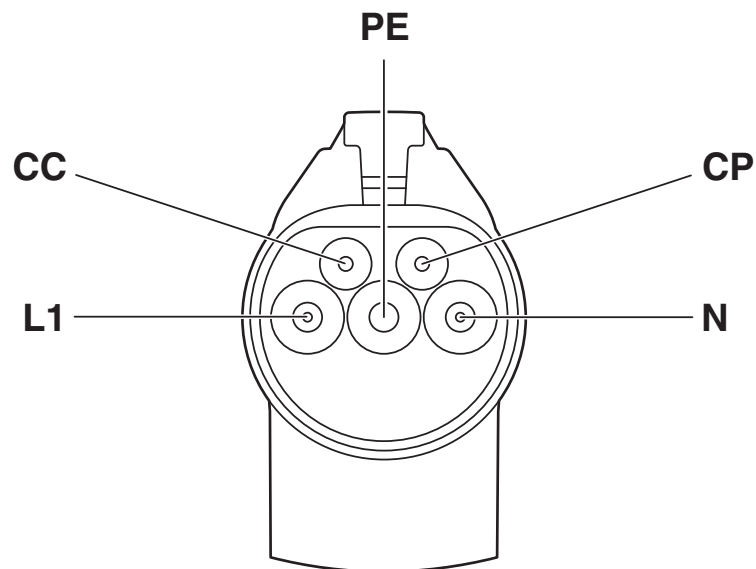

Pin assignment of Infrastructure Plug

Schematic diagram

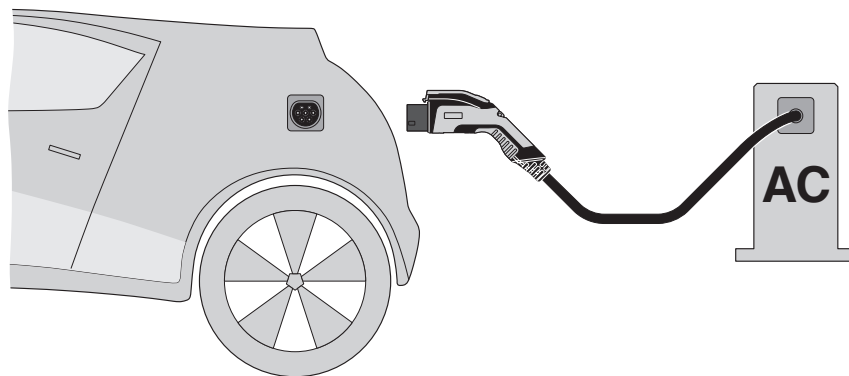

Terminology definition

# EV-GBG3PC-1AC32A-5,0M6,0ESBK01 - AC charging cable



1627605

<https://www.phoenixcontact.com/us/products/1627605>

Dimensional drawing

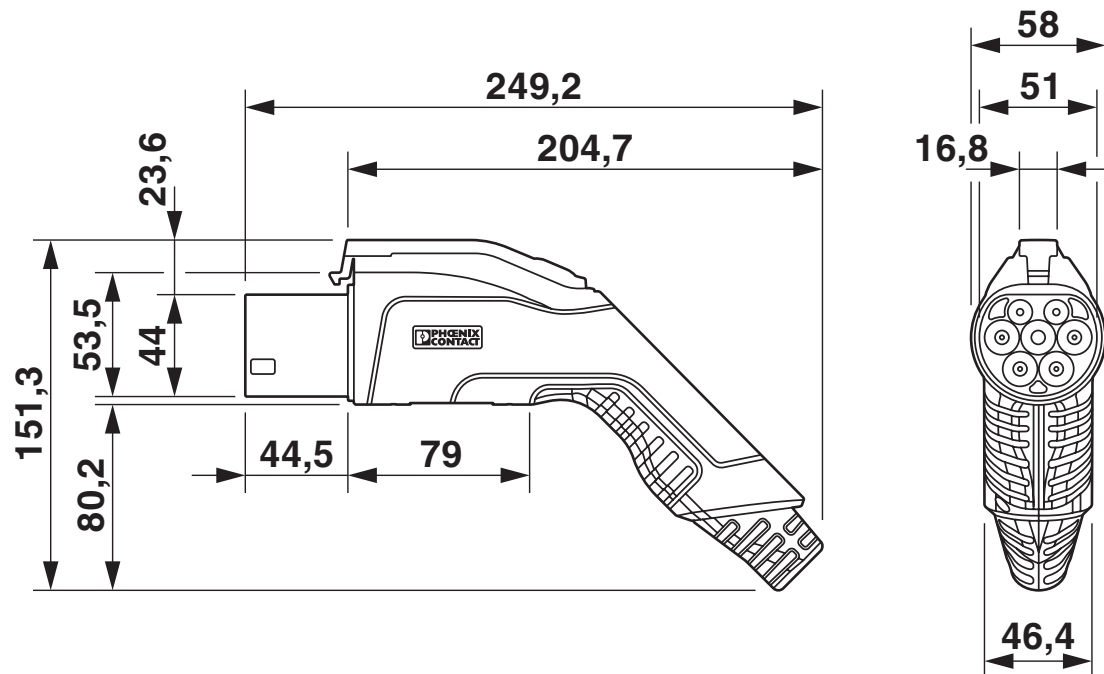

Infrastructure plug

# EV-GBG3PC-1AC32A-5,0M6,0ESBK01 - AC charging cable

1627605

<https://www.phoenixcontact.com/us/products/1627605>

## Schematic diagram

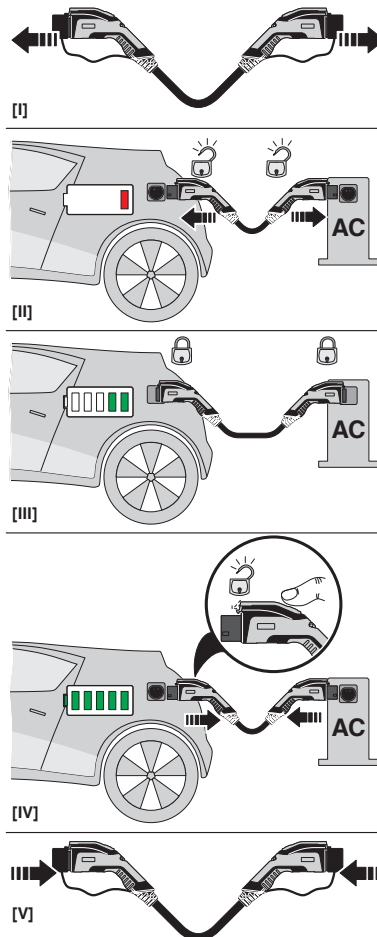

Operating instructions



# EV-GBG3PC-1AC32A-5,0M6,0ESBK01 - AC charging cable



1627605  
<https://www.phoenixcontact.com/us/products/1627605>

## Classifications

### ECLASS

ECLASS-11.0	27144705
-------------	----------

### ETIM

ETIM 8.0	EC002897
----------	----------

### UNSPSC

UNSPSC 21.0	39121500
-------------	----------

# EV-GBG3PC-1AC32A-5,0M6,0ESBK01 - AC charging cable



1627605  
<https://www.phoenixcontact.com/us/products/1627605>

## Environmental product compliance

China RoHS	
Environment friendly use period (EFUP)	<div>EFUP-10</div> <div>An article-related China RoHS declaration table can be found in the download area for the respective article under "Manufacturer declaration". For all articles with EFUP-E, no China RoHS declaration table issued and required.</div>
EU REACH SVHC	
REACH candidate substance (CAS No.)	No substance above 0.1 wt%

# EV-GBG3PC-1AC32A-5,0M6,0ESBK01 - AC charging cable



1627605

<https://www.phoenixcontact.com/us/products/1627605>

## Accessories

### EV-GBAC-PARK - Charging connector holder

1624142

<https://www.phoenixcontact.com/us/products/1624142>



CHARX connect, Charging connector holder, Accessories, for vehicle charging connectors on charging stations (EVSE), GB/T, GB/T 20234.2, Front mounting, housing: black

---

Phoenix Contact 2024 © - all rights reserved  
<https://www.phoenixcontact.com>

Phoenix Contact USA  
586 Fulling Mill Road  
Middletown, PA 17057, United States  
(+717) 944-1300  
[info@phoenixcon.com](mailto:info@phoenixcon.com)