

# Type BLC-06B

## Fuse Block

## MID Limiter Fuses



www.optifuse.com

(619) 593-5050

### Specifications:

**Voltage Rating: 32VDC**

**Current Rating:** 30A~100A (max.)

### Wire Sizes: #2-8AWG

**Fuse Type:** MID Limiter Fuse

**Base:** PBT (UL flame:94V-0)

**Cover:** Nylon (UL flame: 94V-0)

**Terminals:** M5 Nickel Plated Steel-

## Threaded Studs and Hex Nuts

### Mechanical Dimensions: Inches [mm]

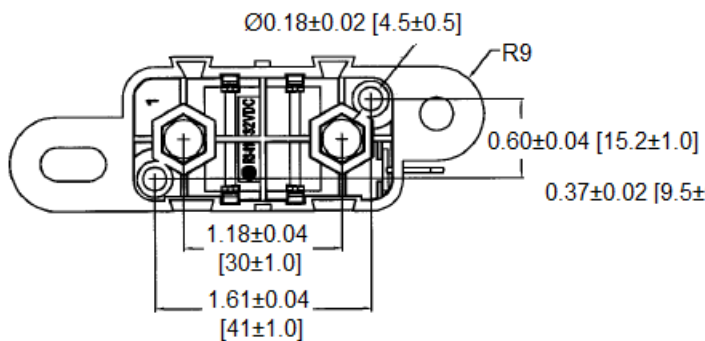
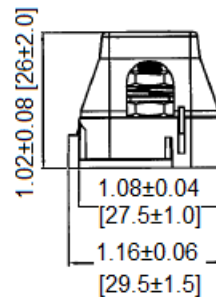
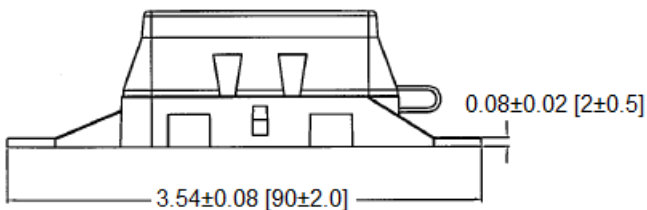
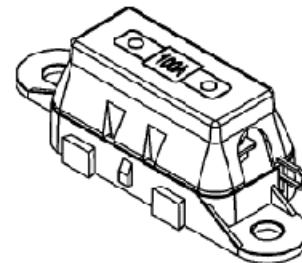
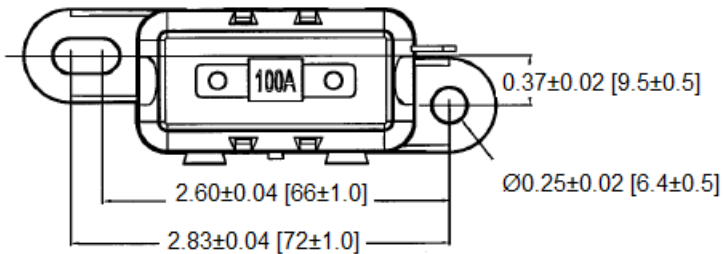

## MOUNTING HOLE DIMENSIONS

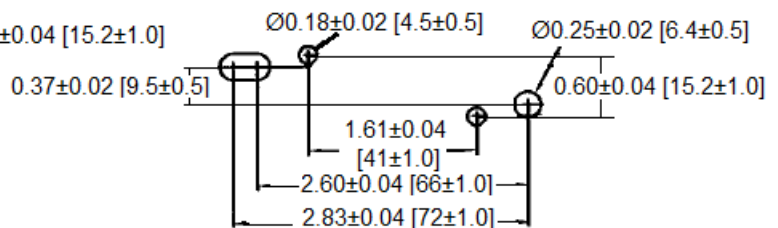

### Warning:



-Operation beyond the specified maximum ratings or improper use may result in damage and possible electrical arcing and/or flame.

-Avoid contact of device with chemical solvent. Prolonged contact may damage the device performance.