

Actuator

51-
259.025



<https://eao.com/p/51-259.025>

Your product:



51-259.025 Actuator

FRONT

Front dimension: Ø 24,5 mm

Front form: round

MOUNTING

Design: raised

Mounting type: Panel mounting

OPERATING-/INDICATION PART

Lens optics: opaque

Lens material: Plastic

Lens colour: Red

Lens shape: mushroom-head

Lens illumination: non illuminative

ELECTRICAL CHARACTERISTICS

Switching voltage and switching current: 250 VAC, 5 A (ohmic)
24 VDC, 2 A (inductive, L:R = 30 ms)

Switching rating: 250 V @ 5 A

Contacts: 2 NC / 2 NO

MECHANICAL CHARACTERISTIC

Switching action: Maintained

Switching system:

Self-cleaning, double-break snap action switching system, 1 normally closed and 1 normally open contact per element.

Mechanical lifetime:	100 000 cycles of operation
Contact material:	Gold
Tightening torque:	Fixing nut max. 0.5 Nm
Terminal:	Soldering terminal
Weight:	0.011 kg
Switching system:	Snap-action switching element
Operating force:	18 ... 21 N (depending on the switching element)

AMBIENT CONDITION

Operating temperature:	– 25 °C ... + 55 °C
Storage temperature:	– 40 °C ... + 85 °C
IP front protection:	IP65, according to DIN EN 60529

CERTIFICATE

Conformities:	CE, UKCA, 2006 / 42 / EC (MD), 2011 / 65 / EC (RoHS)
Approbations:	CB (IEC 61058-1), CSA, ENEC (EN 61058-1), UL
REACH:	REACH compliant
RoHS:	RoHS compliant

OTHER

Housing colour:	Black
Hints:	Marking arrows

Short Description: Actuator, Ø 24,5 mm, mushroom-head, non illuminative, Red, Plastic, opaque, round, 2 NC / 2 NO, Maintained, Soldering terminal, IP65, according to DIN EN 60529

Wiring diagrams:

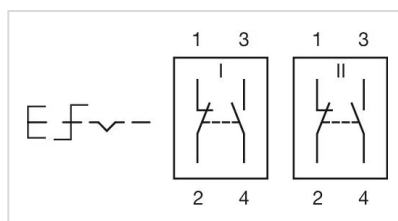

Dimension drawings:

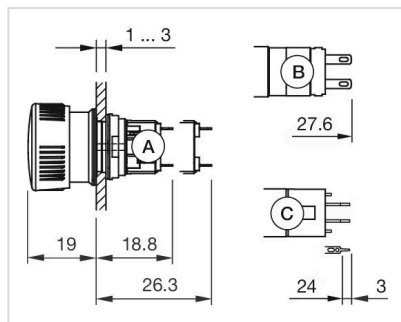

A = Solder terminal
 B = Plug-in terminal 2.8 mm x 0.5 mm
 C = Universal terminal 2.0 mm x 0.5 mm

Mounting cut-outs:

