

# AI-TWIN 2X 6 -14 GN - Ferrule



1213205

<https://www.phoenixcontact.com/us/products/1213205>

Please be informed that the data shown in this PDF document is generated from our online catalog. Please find the complete data in the user documentation. Our general terms of use for downloads are valid.



Ferrule, sleeve length: 14 mm, color: green

## Your advantages

- These special ferrules allow chain bridges to be set up with ease
- The TWIN ferrules provide a practical way of crimping two conductors in one ferrule
- Different versions of the individual TWIN ferrules can be selected for specific applications

## Commercial data

Item number	1213205
Packing unit	100 pc
Minimum order quantity	100 pc
Sales key	BH34
Product key	BH3413
Catalog page	Page 486 (C-3-2019)
GTIN	4055626280851
Weight per piece (including packing)	0.718 g
Weight per piece (excluding packing)	0.671 g
Customs tariff number	85369010
Country of origin	DE

# AI-TWIN 2X 6 -14 GN - Ferrule



1213205

<https://www.phoenixcontact.com/us/products/1213205>

## Technical data

### Product properties

Product type	Cable end sleeve
Conductor category	stranded conductors, class 2, 5, 6 / B, C, K, M

### Data management status

Article revision	03
------------------	----

### Connection data

#### Conductor connection

Conductor cross section flexible max.	6 mm²
Conductor cross section AWG max.	10
Stripping length	19 mm

### Dimensions

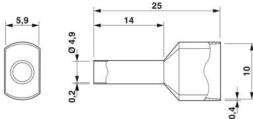
Dimensional drawing	
Sleeve length	14 mm
Maximum stripping length	19 mm
Ferrule diameter	4.9 mm
Sleeve wall thickness	0.2 mm
Insulating collar thickness	0.4 mm
Inner dimensions of the insulating collar	5.9 mm

### Material specifications

Color	green (RAL 6021)
Material	CU-DHP
Flammability rating according to UL 94	HB
Coating	tin-plated (galvanic)
Components	free from silicone and halogen

### Mechanical properties

#### Technical data

Sleeve length	14 mm
---------------	-------

### Environmental and real-life conditions

#### Ambient conditions

Permanent temperature	105 °C (-40 °C no load / 0 °C dynamic load)
Short-term temperature	120 °C

# AI-TWIN 2X 6 -14 GN - Ferrule



1213205

<https://www.phoenixcontact.com/us/products/1213205>

## Standards and regulations

Design according to standard	DIN 46228-4
------------------------------	-------------

# AI-TWIN 2X 6 -14 GN - Ferrule

1213205

<https://www.phoenixcontact.com/us/products/1213205>



## Drawings

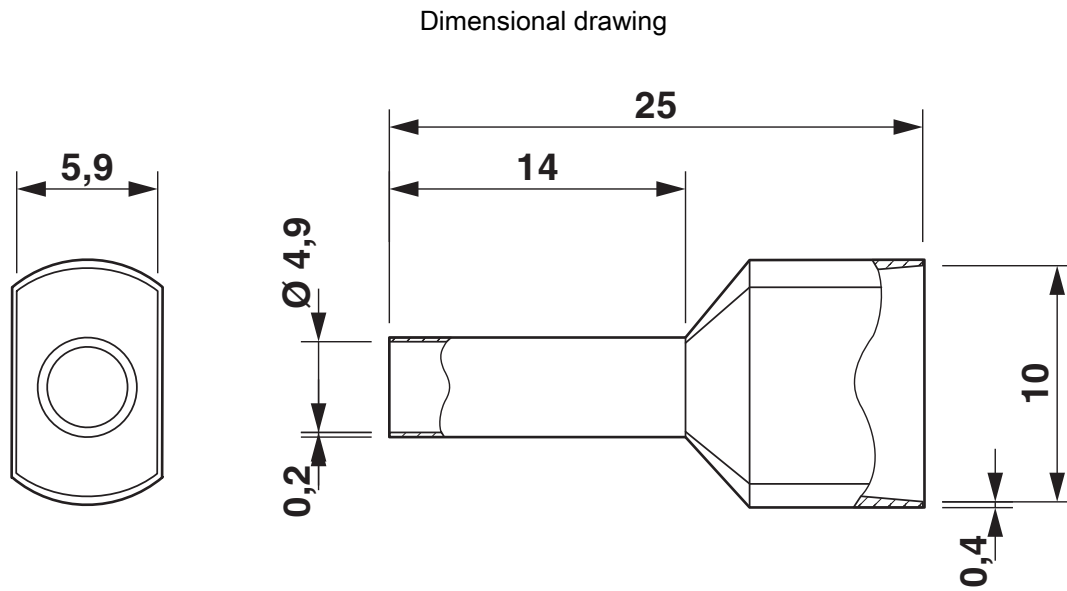

# AI-TWIN 2X 6 -14 GN - Ferrule



1213205

<https://www.phoenixcontact.com/us/products/1213205>

## Approvals

 To download certificates, visit the product detail page: <https://www.phoenixcontact.com/us/products/1213205>



**cULus Listed**

Approval ID: E488001

# AI-TWIN 2X 6 -14 GN - Ferrule



1213205

<https://www.phoenixcontact.com/us/products/1213205>

## Classifications

### ECLASS

ECLASS-11.0	27400201
ECLASS-13.0	27400201
ECLASS-12.0	27400201

### ETIM

ETIM 9.0	EC000005
----------	----------

### UNSPSC

UNSPSC 21.0	27121700
-------------	----------

# AI-TWIN 2X 6 -14 GN - Ferrule



1213205

<https://www.phoenixcontact.com/us/products/1213205>

## Environmental product compliance

EU RoHS	
Fulfills EU RoHS substance requirements	Yes, No exemptions
China RoHS	
Environment friendly use period (EFUP)	EFUP-E
	No hazardous substances above the limits
EU REACH SVHC	
REACH candidate substance (CAS No.)	No substance above 0.1 wt%

Phoenix Contact 2024 © - all rights reserved  
<https://www.phoenixcontact.com>

Phoenix Contact USA  
586 Fulling Mill Road  
Middletown, PA 17057, United States  
(+717) 944-1300  
[info@phoenixcon.com](mailto:info@phoenixcon.com)