

Actuator

51-
259.0250

Distribution by
DigiKey

DigiKey



<https://digikey.eao.com/p/51-259.0250>

Your product:



51-259.0250 Actuator

FRONT

Front dimension: Ø 24,5 mm

MOUNTING

Design: raised

OPERATING-/INDICATION PART

Lens shape: mushroom-head

Lens colour: Black

Lens illumination: non illuminative

Lens optics: opaque

Lens material: Plastic

ELECTRICAL CHARACTERISTICS

Contacts: 2 NC / 2 NO

Switching voltage and switching current: 250 VAC, 5 A (ohmic)
24 VDC, 2 A (inductive, L:R = 30 ms)

MECHANICAL CHARACTERISTIC

Mechanical lifetime: 100 000 cycles of operation

Contact material: Gold

Weight: 0.011 kg

Switching system: Self-cleaning, double-break snap action switching system, 1 normally closed and 1 normally open contact per element.

Operating force:	18 ... 21 N (depending on the switching element)
Switching system:	Snap-action switching element
Terminal:	Soldering terminal
Tightening torque:	Fixing nut max. 0.5 Nm
Switching action:	Maintained

AMBIENT CONDITION

Operating temperature:	– 25 °C ... + 55 °C
Storage temperature:	– 40 °C ... + 85 °C
IP front protection:	IP65, according to DIN EN 60529

CERTIFICATE

Approbations:	CB (IEC 61058-1), CSA, ENEC (EN 61058-1), UL
Conformities:	CE, UKCA, 2006 / 42 / EC (MD), 2011 / 65 / EC (RoHS)

OTHER

Short Description: Actuator, Ø 24,5 mm, mushroom-head, non illuminative, Black, Plastic, opaque, 2 NC / 2 NO, Maintained, Soldering terminal, IP65, according to DIN EN 60529

Housing colour: Black

Hints: Marking arrows

Wiring diagrams:

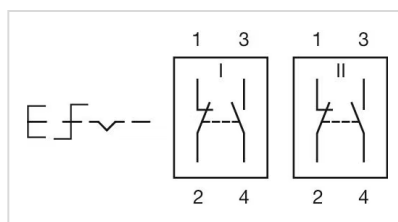

Dimension drawings:

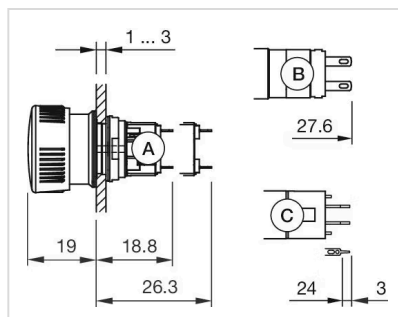

A = Solder terminal
B = Plug-in terminal 2.8 mm x 0.5 mm
C = Universal terminal 2.0 mm x 0.5 mm

Mounting cut-outs:

