

© COPYRIGHT 2022 BY INDUSTRIAL FIBER OPTICS, INC.
ALL RIGHTS RESERVED.

REVISIONS

REV	DESCRIPTION	ECO	DATE	DWN	APVD
A	Initial Release	00354	08/26/2019	DDH	BB
B	Replaced TCU-1000(L) with TCU-1000	00381	09/28/20	DDH	BB
C	Added note regarding material substitution, removed IF 3118	00417	8/15/2022	BB	DDH

LENGTH	TOLERANCE
0.1m	+0.03;-0.0m
0.2-0.99m	± 0.03m
1-5.49m	± 0.05m
5.5-12.99m	± 0.1m
13-29.99m	± 0.15m
30-50m	± 0.3m
50.1 - 80	± 0.5m

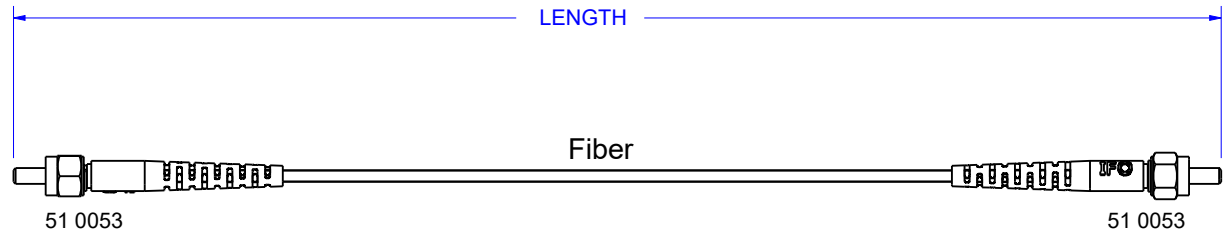

Variations to Standard Assembly

SERIES	FIBER*	CONNECTOR	BOOT
IF 111W	GHEL4001-OR	51 0059	Heat Shrink
IF 11AL	PVC Coated armor 4.8 mm jacket TC-1000 or GH4001	51 0561	Metal Sleeve
IF 635B	84C01000S333	SSMA SS0 02 0070	w/connector
IF 635	GHTT4001	51 0061	Metal Sleeve

*The fiber cable used for the assembly will be based upon the category of cable used for the SERIES. Asahi Kasei and Mitsubishi Eska optical fiber cable are shown, however other manufacturers' cable may be used based on availability.

SERIES	FIBER*
IF 636	TCF-1000 GHCP4001
IF 111L	TC-1000 GH4001
IF 111M	TCV-1000 GHV4001
IF 637	GHN4001
IF 111V	BH4001 SHCN-1000(E)
IF 111D	DC-1000 SH4001
IF 111Y	LH4001-N

UNLESS OTHERWISE SPECIFIED DIMENSIONS MILLIMETERS [IN.]	PRODUCT	Industrial Fiber Optics TEMPE, AZ 85281				
	MATERIAL					
DIMENSIONS ARE FOR REFERENCE ONLY NO TOLERANCES MAY BE IMPLIED FROM THIS DOCUMENT	FINISH	NONE	NAME			
	DRAWN BY	David Hanson	SMA (SERCOS) POF Simplex Cable Assembly			
	DATE	8/26/2019				
	CHECKED BY	B. Bidwell	SIZE	SCALE	DOCUMENT NUMBER	REV
	DATE	9/28/2020	A	1:1	IF 111x	C
DO NOT SCALE DRAWING			1 OF 1			

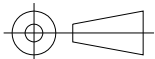

METRIC