

MATERIAL NO.	NUMBER OF CIRCUITS "XX"	DIM. "A"		DIM. "B"	
38703-6502	02	14.6	[.58]	8.26	[.325]
38703-6503	03	22.9	[.90]	16.51	[.650]
38703-6504	04	31.1	[1.23]	24.77	[.975]
38703-6505	05	39.4	[1.55]	33.02	[1.300]
38703-6506	06	47.6	[1.88]	41.28	[1.625]
	07	55.9	[2.20]	49.53	[1.950]
38703-6508	08	64.1	[2.53]	57.79	[2.275]
	09	72.4	[2.85]	66.04	[2.600]
38703-6510	10	80.6	[3.18]	74.30	[2.925]
	11	88.9	[3.50]	82.55	[3.250]
	12	97.2	[3.83]	90.81	[3.575]
	13	105.41	[4.15]	99.06	[3.900]
	14	113.7	[4.48]	107.32	[4.225]
	15	121.9	[4.80]	115.57	[4.550]
38703-6516	16	130.2	[5.13]	123.83	[4.875]
	17	138.4	[5.45]	132.08	[5.200]
	18	146.7	[5.78]	140.34	[5.525]
	19	154.9	[6.10]	148.59	[5.850]
	20	163.2	[6.43]	156.85	[6.175]
	21	171.5	[6.75]	165.10	[6.500]
	22	179.7	[7.08]	173.36	[6.825]
	23	188.0	[7.40]	181.61	[7.150]
	24	196.2	[7.73]	189.87	[7.475]
	25	204.5	[8.05]	198.12	[7.800]
	26	212.7	[8.38]	206.38	[8.125]
	27	221.0	[8.70]	214.63	[8.450]
	28	229.2	[9.03]	222.89	[8.775]
	29	237.5	[9.35]	231.14	[9.100]
	30	245.7	[9.68]	239.40	[9.425]

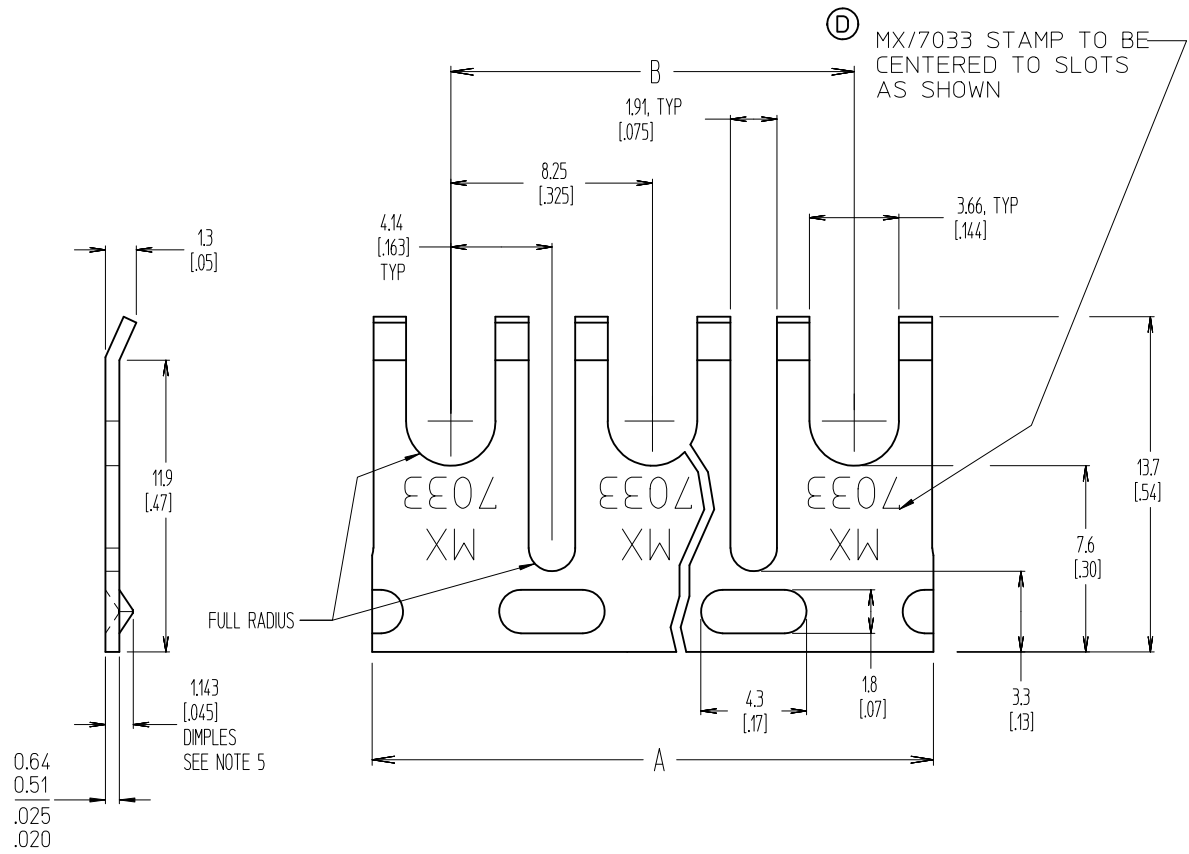

NOTES:

1. MATERIAL: SEE TABLE
2. FINISHES: SEE TABLE
3. INCHES SHOWN IN BRACKETS [XXX].
4. USED ON: SERIES 7000
5. THE DIMPLE HEIGHT MAY VARY TO MAINTAIN PART STRAIGHTNESS TO WITHIN 0.8 [03]/25.4 [1.00], AND HOLD THE LONG SLOT WIDTH TO 1.91 [075].
6. PART IS ROHS COMPLIANT.

ITEM	QTY.	DESCRIPTION	MATERIAL	FINISH
1	1	TERMINAL JUMPER	BRASS	NICKEL

MX STAMP WAS BEAU EC NO: WNA2012-0084 DRW:HRSTONE 2011/08/04 CHK:BRUPERT 2011/08/04 APPR:JFURPHY 2011/08/13	DESCRIPTION REV	QUALITY SYMBOLS	GENERAL TOLERANCES (UNLESS SPECIFIED)	DIMENSION STYLE	SCALE	DESIGN UNITS	THIRD ANGLE PROJECTION	
		▼=0 ▽=0	mm INCH 4 PLACES ± --- ± --- 3 PLACES ± --- ± .005 2 PLACES ± 0.13 ± .01 1 PLACE ± 0.3 ± --- ANGULAR ± 2 °	MM/IN	5:1	INCH		
			DRAFT WHERE APPLICABLE MUST REMAIN WITHIN DIMENSIONS	DRAWN BY DATE W. HOWARD 2003/12/12 CHECKED BY DATE R. KEMP 2003/12/12 APPROVED BY DATE P. WALTZ 2003/12/12	TITLE	JUMPER, TERMINAL (EDGE-ON TYPE)		
			SEE CHART	MATERIAL NO.	DOCUMENT NO.	MOLLEX INCORPORATED		
				SIZE B	THIS DRAWING CONTAINS INFORMATION THAT IS PROPRIETARY TO MOLEX INCORPORATED AND SHOULD NOT BE USED WITHOUT WRITTEN PERMISSION			
							SD-38703-001	
							SHEET NO. 1 OF 1	