

NOTE) 1 . ALL LEAD CO-PLANARITY SHALL BE 0.08mm MAX

2 . CONTACT PLATING SPECIFICATIONS.

CONTACT AREA : GOLD 0.05  $\mu$ m MIN

SMT LEAD : GOLD 0.05  $\mu$ m MIN

UNDERPLATING : NICKEL 1  $\mu$ m MIN

( SURFACE : SEALING )

3 . EACH CONTACTS AT 4 CORNERS ARE PROVIDED FOR METAL FITTINGS AND GROUNDING PURPOSE.

4 . HRS MARK AND CAV NO. ARE INDICATED IN APPROX POSITION SHOWN.

5 . GATE POSITION IS INDICATED IN APPROX POSITION SHOWN.

A-A (50:1)

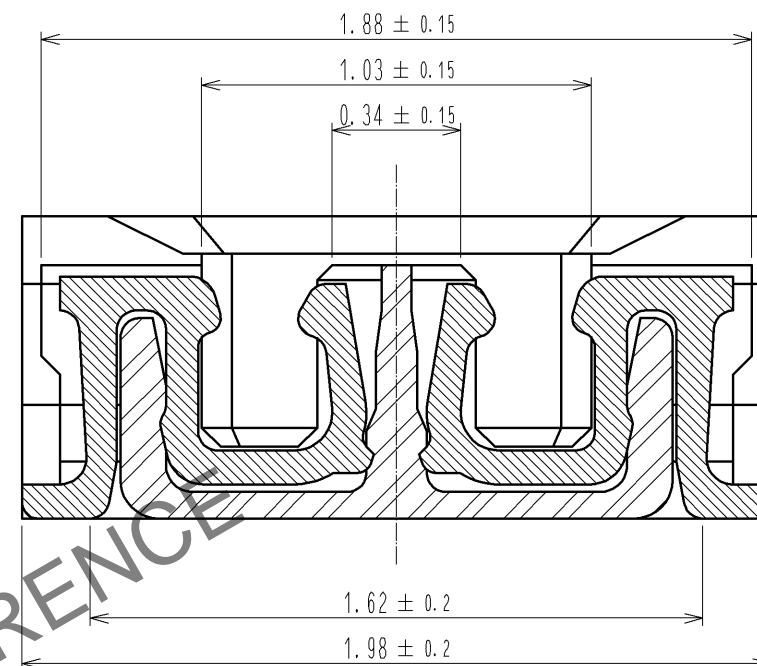

ENGAGEMENT FIGURE (50:1)

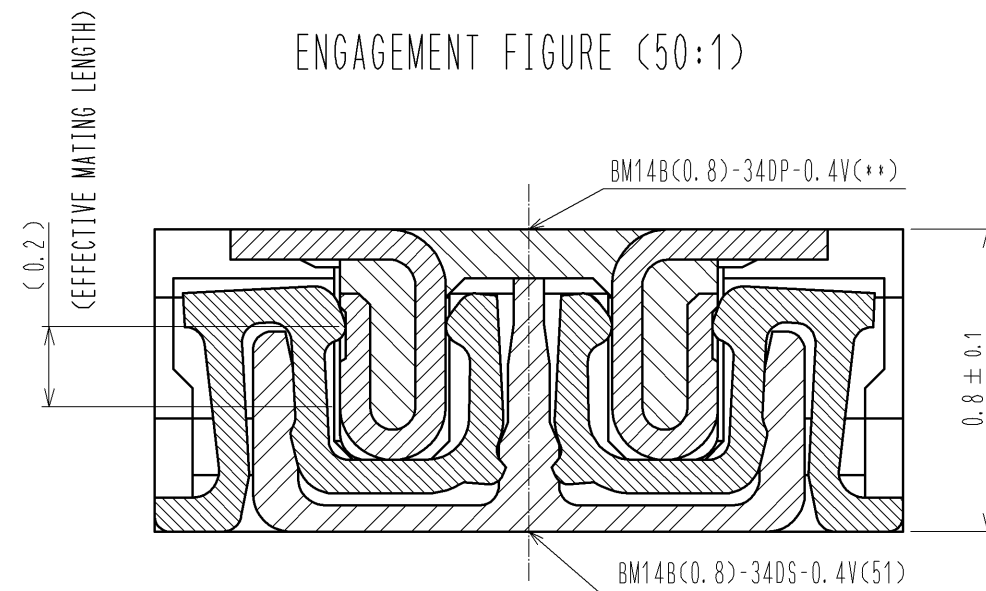

3	PS	CLEAR (ENBOSSED CARRIER TAPE)	6	PS	CLEAR (REINFORCEMENT COLLAR)
2	PHOSPHOR BRONZE	2	5	PS	BLACK (PLASTIC REEL)
1	LCP	UL94 V-0, BLACK	4	POLYESTER	CLEAR (COVER TAPE)
NO.	MATERIAL	FINISH , REMARKS	NO.	MATERIAL	FINISH , REMARKS
UNITS mm		SCALE 10 : 1	COUNT 1	DESCRIPTION OF REVISIONS	DESIGNED
HIROSE ELECTRIC CO., LTD.		APPROVED : KH. IKEDA	14. 01. 23	DRAWING NO.	EDC3-319842-01
		CHECKED : TS. MIYAZAKI	14. 01. 23	PART NO.	BM14B(0.8)-34DS-0.4V(51)
		DESIGNED : YH. MICHIDA	14. 01. 23	CODE NO.	CL684-8007-6-51
		DRAWN : KR. AJITO	14. 01. 23		

## ◆ RECOMMENDED PCB LAYOUT

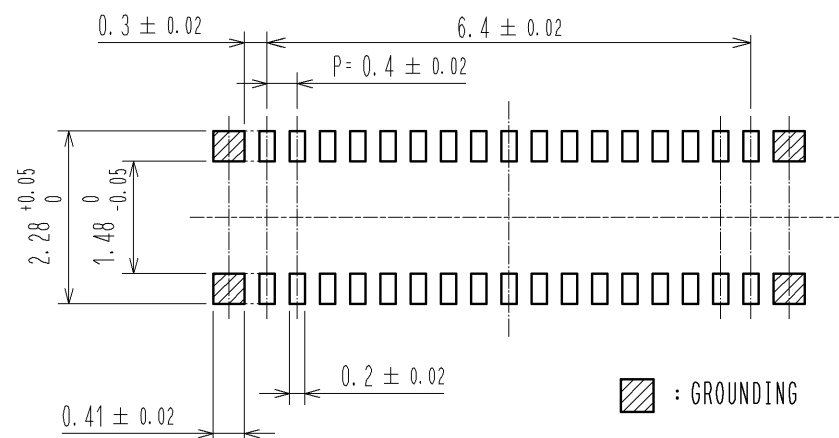

## ◆ RECOMMENDED METAL MASK DIMENSIONS

METAL MASK THICKNESS :  $100 \mu\text{m}$

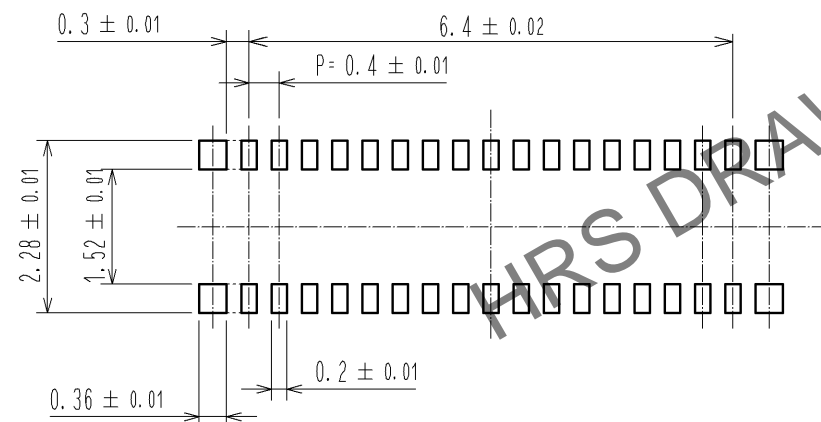

## 6 RECOMMENDED REFLOW TEMPERATURE PROFILE USING LEAD-FREE SOLDER PASTE.

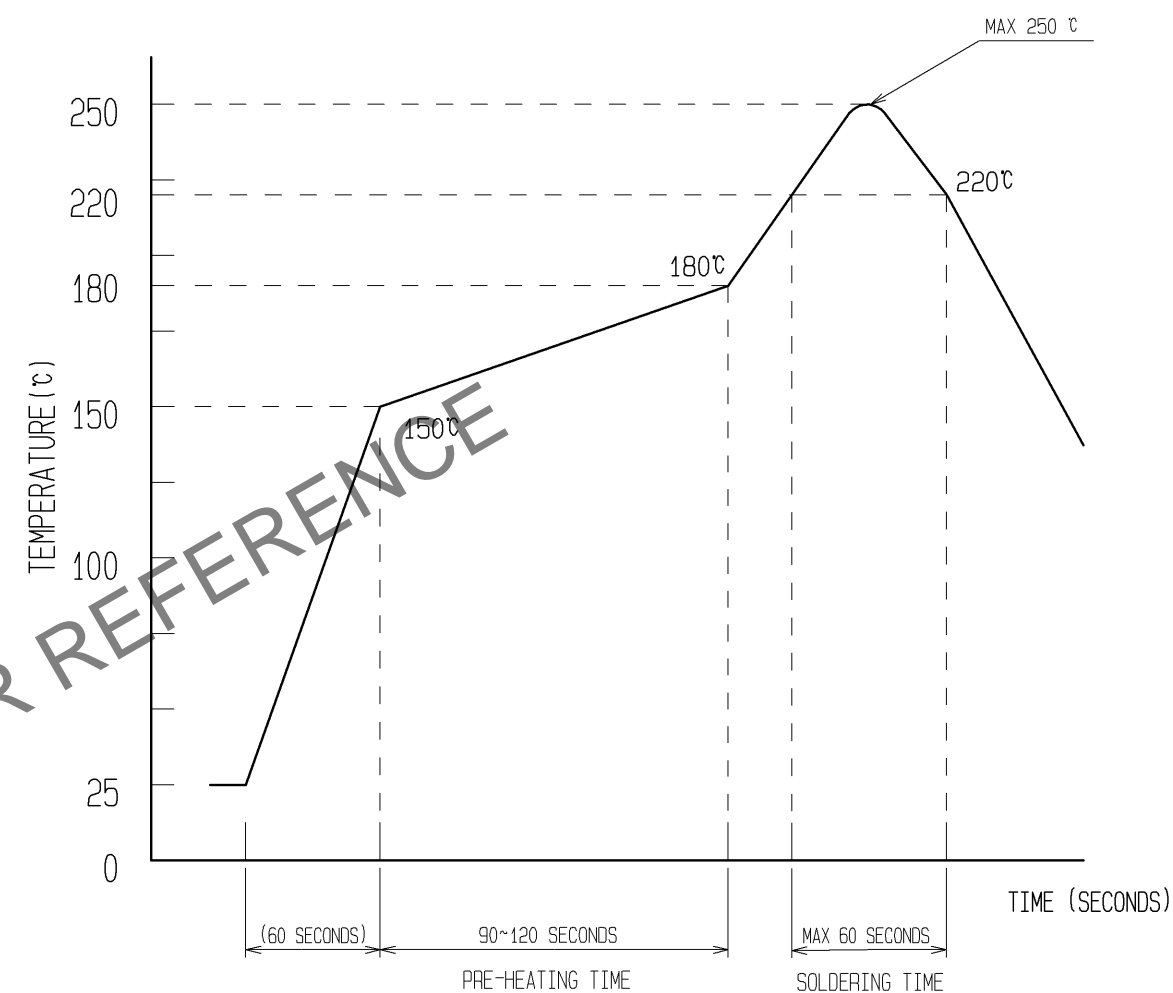

- REFLOW METHOD: IR REFLOW  
NUMBER OF REFLOW CYCLES: 2 CYCLES MAX.
- 1) REFLOW TIME  
DURATION ABOVE 220 $^{\circ}\text{C}$ , 60 SEC. MAX.  
(PEAK TEMPERATURE: 250 $^{\circ}\text{C}$  MAX)
  - 2) PRE-HEAT TIME  
PRE-HEAT TEMPERATURE(MIN): 150 $^{\circ}\text{C}$   
PRE-HEAT TEMPERATURE(MAX): 180 $^{\circ}\text{C}$   
PRE-HEAT TIME: 90-120 sec.

6 THIS TEMPERATURE PROFILE IS PER THE CONDITIONS SHOWN ABOVE.  
ADDITIONAL FACTORS, SUCH AS SOLDER PASTE TYPE, PCB SIZE AND  
OTHER MOUNTED COMPONENTS COULD AFFECT THE PROFILE, THEREFORE,  
A THOROUGH EVALUATION OF MOUNTING CONDITION IS REQUIRED  
PRIOR TO PRODUCTION. TEMPERATURE IS MEASURED AT CONTACT LEAD.

**HRS**

DRAWING NO.	EDC3-319842-01
PART NO.	BM14B(0.8)-34DS-0.4V(51)
CODE NO.	CL684-8007-6-51

2/3

