

Product data sheet

Power connectors



Product description	RD24 Male panel mount connector, Contacts: 3+PE, unshielded, screw clamp, IP67, UL, ESTI+, VDE
Area	series 693
Part no.	09 4223 00 04

Illustration

Scale drawing

Contact arrangement (Plug-in side)

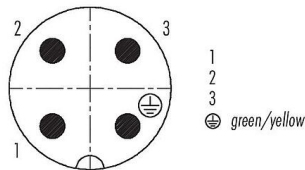
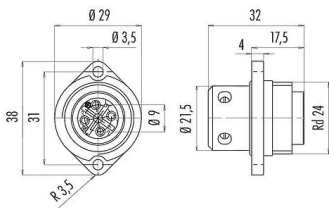

You can find the assembly instructions on the next page.

Technical data

General features

Part no.	09 4223 00 04
Connector design	Male panel mount connector
Version	Connector pin straight
Connector locking system	screw
Termination	screw clamp
Degree of protection	IP67
Cross-sectional area	max. 2.50 mm ² / AWG 14
Temperature range from/to	-40 °C / 100 °C
Mechanical operation	> 500 Mating cycles
Weight (g)	22.39
Customs tariff number	85369010
Country of Origin	DE

Electrical parameters

Rated voltage	400 V (600 V UL)
Rated voltage UL	11768
Rated impulse voltage	6000 V
Rated current	16 A (12 A UL)
Insulation resistance	≥ 10 ¹⁰ Ω
Pollution degree	3
Overvoltage category	III
Insulating material group	III
EMC compliance	unshielded

Material

Contact body material	PBT
-----------------------	-----

Product description	RD24 Male panel mount connector, Contacts: 3+PE, unshielded, screw clamp, IP67, UL, ESTI+, VDE
Area	series 693
Part no.	09 4223 00 04

Contact material	CuZn (brass)
Contact plating	Ag (silver)
REACH SVHC	CAS 7439-92-1 (Lead)
SCIP number	c7a8c0c8-6e33-4db7-8703-a4bfc70ca66

Authorization/approvals

Approvals	UL, ESTI+, VDE
-----------	----------------

Classifications

eCl@ss 11.1	27-44-01-09
ETIM 9.0	EC003569

Assembly instructions / Panel cut-out

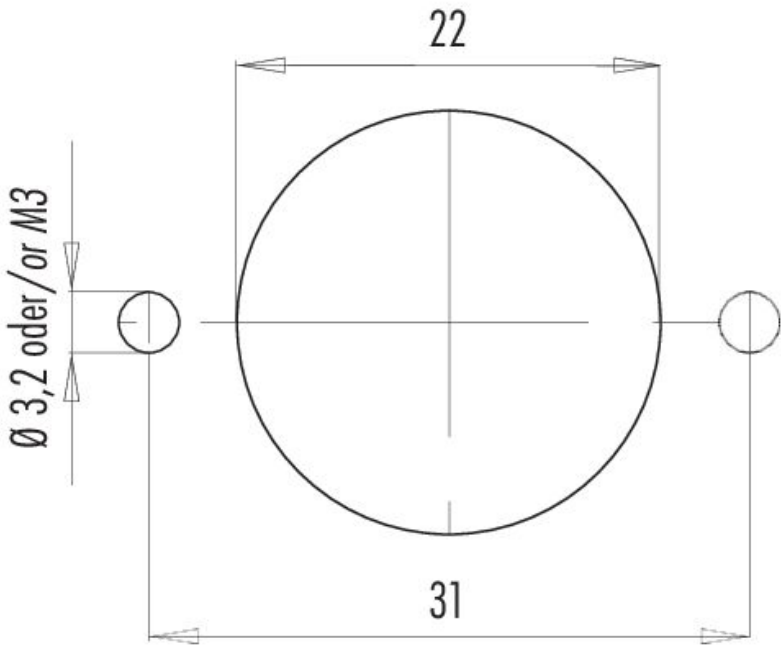

Product description	RD24 Male panel mount connector, Contacts: 3+PE, unshielded, screw clamp, IP67, UL, ESTI+, VDE
Area	series 693
Part no.	09 4223 00 04

Derating curve

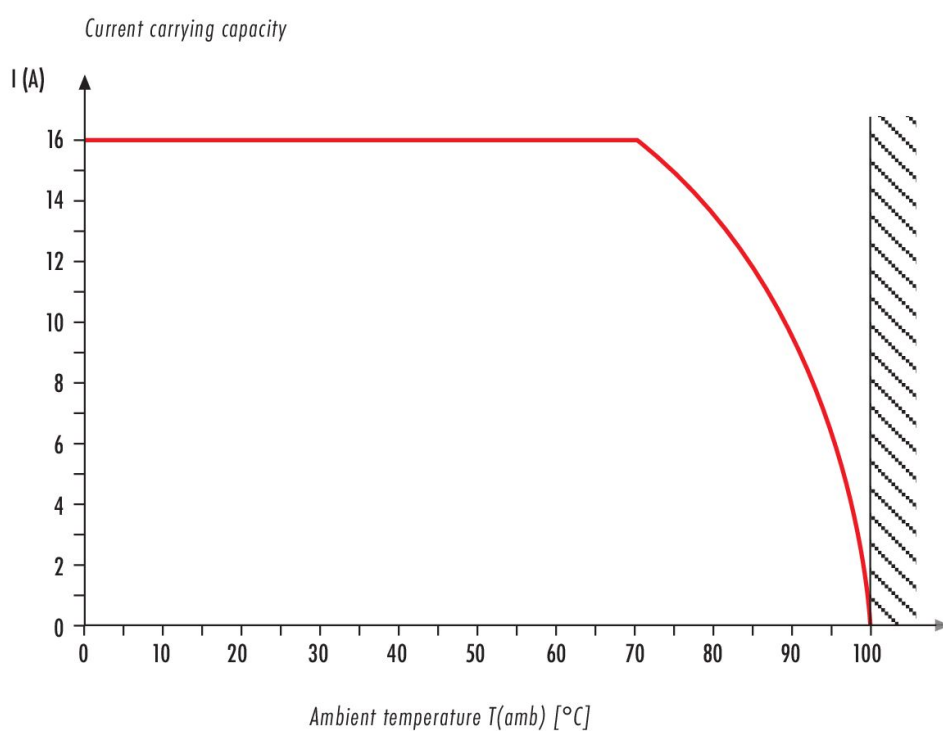

Product description	RD24 Male panel mount connector, Contacts: 3+PE, unshielded, screw clamp, IP67, UL, ESTI+, VDE
Area	series 693
Part no.	09 4223 00 04

Security notices

The connector must not be plugged or unplugged under load. Non-observance and improper use can result in personal injury.

The connectors have been developed for applications in plant engineering, control and electrical equipment construction. The user is responsible for checking whether the connectors can also be used in other areas of application.

Connectors which are used in circuits with voltages dangerous to the touch may only be installed and used by, or under the supervision of, persons with electrical engineering training, taking into account the applicable regulations and standards.

The user must take suitable safety precautions to ensure that the connector cannot be accidentally disconnected.

The plug connector is not suitable for mains voltages Please observe the pollution degree and the overvoltage category. For further information, please refer to the download center "Technical Information".

To lock the cable connector to the device connector, we recommend tightening the threaded ring to 2 Nm. A suitable torque wrench is available as an accessory (order no. 07 0082 000).