

Actuator

704.292.008I

Distribution by
DigiKey

DigiKey



<https://digikey.eao.com/p/704.292.008I>

Your product:



704.292.008I Actuator

FRONT

Front bezel material:	Plastic
Front dimension:	35 mm x 35 mm
Front bezel colour:	Silver

MOUNTING

Mounting cut-out:	30 mm x 30 mm
Design:	flush

OPERATING-/INDICATION PART

Lever colour:	Black
Lever shape:	long
Lever material:	plastic

ELECTRICAL CHARACTERISTICS

Standards:	The switches comply with the "Standards for low-voltage switching devices" DIN EN 60947-1
------------	---

MECHANICAL CHARACTERISTIC

Weight:	0.056 kg
Switching angle:	42° left / 42° right
Switching action:	Maintained - Rest - Maintained
Switching positions:	3 positions
Mechanical lifetime:	≤2.5 Mio. cycles of operation

AMBIENT CONDITION

Storage temperature:	– 40 °C ... + 85 °C
Operating temperature:	– 40 °C ... + 55 °C
IP Protection:	IP65 front side

OTHER

Short Description:	Actuator, 30 mm x 30 mm, 35 mm x 35 mm, optional illuminative, Black, long, Silver, Plastic, Maintained - Rest - Maintained
---------------------------	---

Hints:	Max. 3 switching elements can be clipped on
---------------	---

max. number of switching elements:	3
---	---

Switching positions:

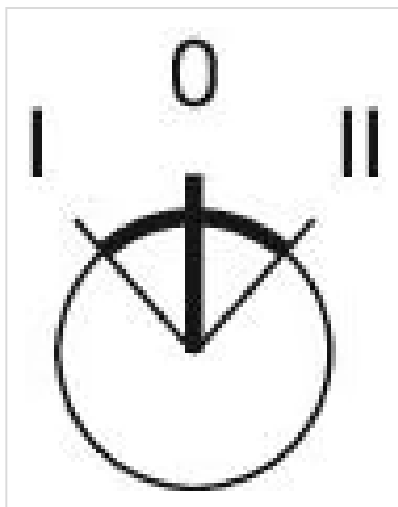

Dimension drawings:

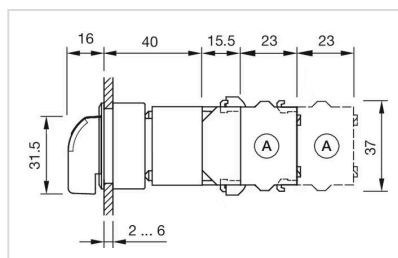

A = Screw terminal

Wiring diagrams:

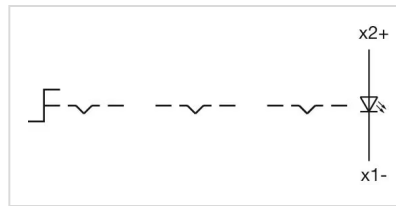

Mounting cut-outs:

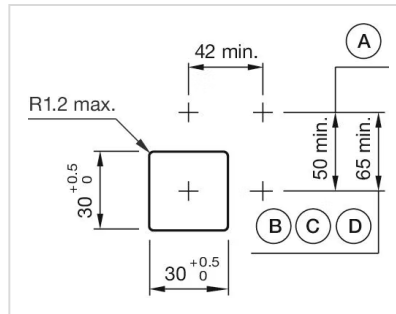

A = Screw terminal
B = Push-in terminal (PIT)
C = Plug-in terminal 6.3 mm x 0.8 mm
D = Double plug-in terminal 6.3v x 0.8 mm