

ACRK-16-02-G-S-B1-P-1

ACRK-16-01-G-T-B1-P-1

ACRK-16-06-G-T-B1-M-1

ACRK-16 SERIES

16 mm IP68 FIELD TERMINATION KIT

SPECIFICATIONS

For complete specifications and processing guidelines see www.samtec.com?ACRK-16

Terminal Material:

Brass

Contact Material:

Brass/BeCu

Operating Temp Range:

-40 °C to +105 °C

Housing:

-P: Thermoplastic

-M: Zinc Alloy

RoHS Compliant:

Yes

Mates with:

ACP-16, ACPK-16

| CURRENT RATING | | |
|----------------|--|-------------|
| LEAD STYLE | PINS POWERED | CCC per PIN |
| -01 | 14 | 1.3 A |
| -02 | 10 | 2.6 A |
| -06 | 2 (plus 8 signal pins powered @ 1A) | 11.6 A |

For general reference only. See www.samtec.com?ACRK-16 for complete test data or contact AccliMate@samtec.com for applications requiring higher current carrying capacity.



Solutionator
DESIGN IN A MINUTE

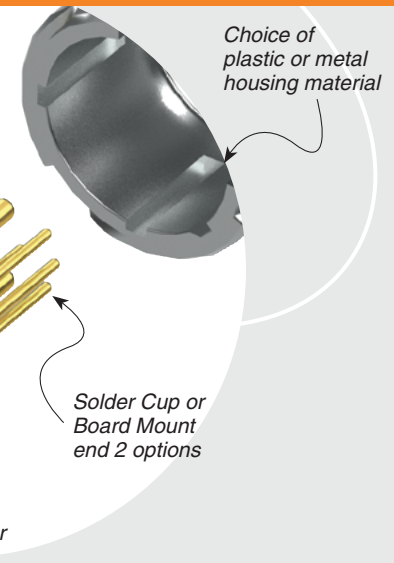

DUST CAPS

- DCA-ACR-16-M-X (Metal)
- DCA-ACR-16-P-X (Plastic)



- Visit sealedio.samtec.com for a complete list of sealed systems

PANEL OPENING

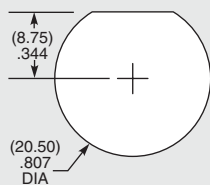

NOTE

For complete specifications and processing guidelines see www.samtec.com?ACRK-16

Note: Some lengths, styles and options are non-standard, non-returnable.

| ACRK | 16 | LEAD STYLE | PLATING | END 1 | END 2 | HOUSING MATERIAL | KEYING OPTIONS |
|------|----|--|--|--|--|--|-------------------------------|
| | | -01 = 0.5 mm DIA (14) (26-30 AWG) -02 = 1.0 mm DIA (10) (20-24 AWG) -06 = 1.5 mm DIA (2) (14-18 AWG) + 0.5 mm DIA (8) (26-30 AWG) | -G = 10 μm (0.25 μm) Gold over 50 μm (1.27 μm) Ni on contact | -T = Terminal -S = Socket | -C = Solder Cup -B1 = (1.60 mm) .062" Board Mount | -P = Plastic -M = Metal | -1 = Orange, 45° |
| | | | -01 | | | -02 | |
| | | | | -B1 END SHOWN | | -C END SHOWN | -06 |

Due to technical progress, all designs, specifications and components are subject to change without notice.

WWW.SAMTEC.COM

All parts within this catalog are built to Samtec's specifications.
Components must be approved by Samtec and identified in a Samtec customer-specific drawing to apply.