

# Component-to-wire connectors

Sicma



## 2 way female housings for 2.8 mm terminals

### Features

- High density, reduced size housings
- Hinge secondary lock for terminal position assurance (T.P.A.)
- 2 way housing compatible with ISO standard for loudspeaker
- Several colour codings available



### Performance characteristics

- Temperature range:  
from -40°C to +125°C
- Contact retention force: > 120 N
- Contact insertion force: < 7 N
- Connector mating force: < 30 N

### Construction

- Housing material: PBT

### Tooling

- Terminal removal tool: 210S045
- Flap opening: 210S043

### Connector compatibility

- Usable terminals:
  - Sicma-2 2.8 mm female terminals
  - Sicma-3 2.8 mm female terminals

Part Numbers	No. of position	Terminal size	Colour
211 PC023S0017	2	2.8 mm	Black
211 PC023S6017	2	2.8 mm	Blue
211 PC023S8017	2	2.8 mm	Grey
211 PC023S9017	2	2.8 mm	Crystal

# Component-to-wire connectors

Sicma



## 2 way female housings for 2.8 mm terminals

### Dimensional characteristics

Notes:

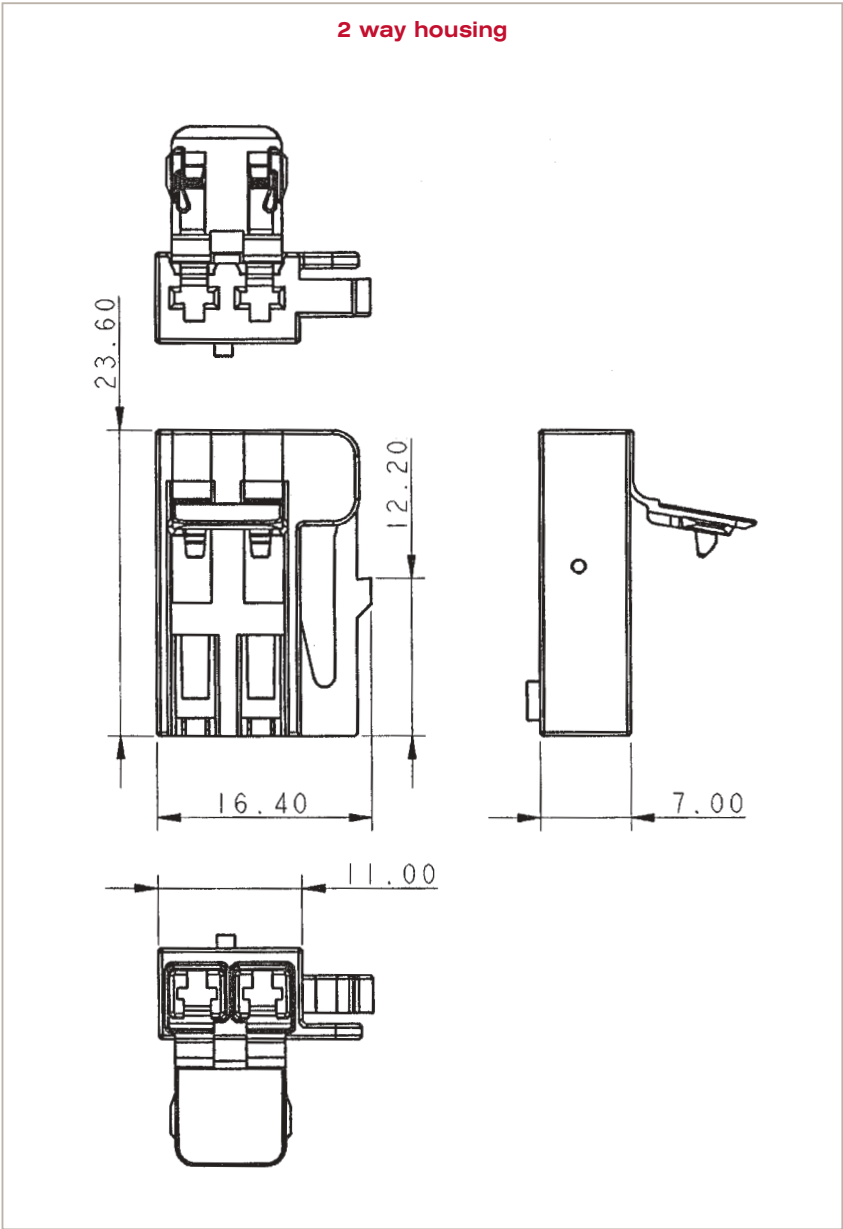

### Codings

