

HC-ADV-B10-HHWH-1TGM32-PL - Housing



1404229

<https://www.phoenixcontact.com/us/products/1404229>

Please be informed that the data shown in this PDF document is generated from our online catalog. Please find the complete data in the user documentation. Our general terms of use for downloads are valid.



Sleeve housing B10, with screw locking, material: PA, cable outlets: 1, straight, M32, height: 95 mm, cable gland: with, Standard

Your advantages

- Integrated screw connection
- Lower costs than metal version
- Low weight
- Lower risk of condensation

Commercial data

Item number	1404229
Packing unit	1 pc
Minimum order quantity	1 pc
Sales key	BF58
Product key	BF7APG
Catalog page	Page 602 (C-2-2019)
GTIN	4046356682008
Weight per piece (including packing)	147.9 g
Weight per piece (excluding packing)	142.1 g
Customs tariff number	85389099
Country of origin	DE

HC-ADV-B10-HHWH-1TGM32-PL - Housing



1404229

<https://www.phoenixcontact.com/us/products/1404229>

Technical data

Notes

General	For contact inserts HC-B10, BB18, DD42, M, K8/24, HV03-I-PT, HC- 3-E...C
---------	--

Product properties

Product type	Housing with screw locking
Housing type	Sleeve housing
Application	Standard
Type	B10
No. of cable outlets	1
Type of the screw connection	M32
Type	Tall design
Fixing screws	M6 (screw head: 5 mm Allen screw)
Shielded	no
Cable outlet	straight
Pg screw connection	with

Connection data

External cable diameter	11 mm ... 21 mm
Tightening torque	3 Nm ... 5 Nm (for M6 mounting screws on the sleeve housing)
Tightening torque, union nut	7.50 Nm

Dimensions

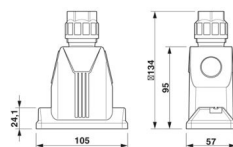
Dimensional drawing	
Width	57 mm
Height	95 mm
Length	105 mm
Wrench size, union nut	30 mm

Installation dimensions

Width of the assembly cutout	35 mm
Length of the assembly cutout	65 mm

Material specifications

Material Pressure screw	PA
Flammability rating according to UL 94	V0 (Housing)
Seal material Profile gasket	NBR
Seal material Cable seal	NBR

HC-ADV-B10-HHWH-1TGM32-PL - Housing



1404229

<https://www.phoenixcontact.com/us/products/1404229>

Housing material	PA
Locking latch material	Stainless steel
Material of locking screw	Stainless steel

Environmental and real-life conditions

Ambient conditions

Degree of protection	IP66
	IP67
Impact strength	IK08
Ambient temperature (operation)	-40 °C ... 100 °C

Mechanical properties

Mechanical data

Type of the screw connection	M32
Locking type	Screw

Cable/line

External cable diameter Cable 1	11 mm ... 21 mm
---------------------------------	-----------------

Mounting

Assembly note	M6 locking screw, with 5 mm Allen screw head
Fixing screws	M6 (screw head: 5 mm Allen screw)

Drawings

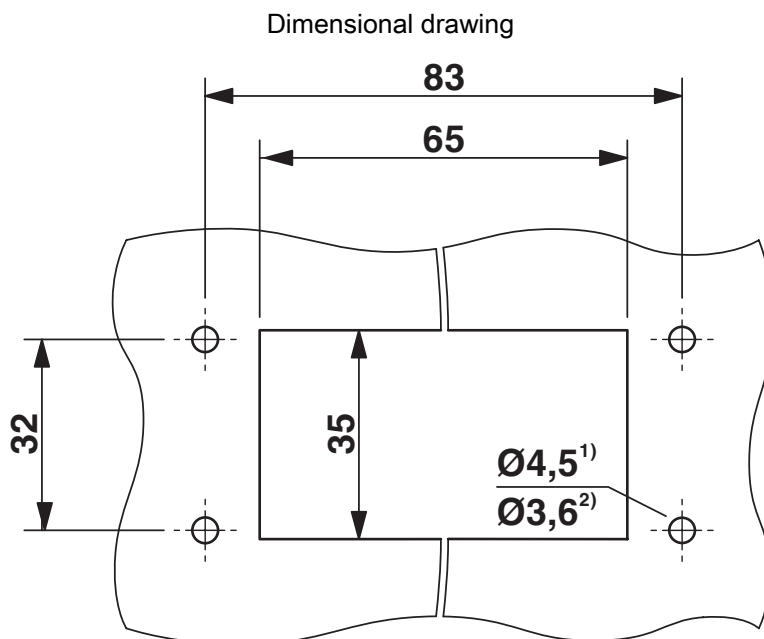

Mounting cutout

1) when M4 screws are used

2) when self-tapping Torx® screws are used (Torx® 20, M4)

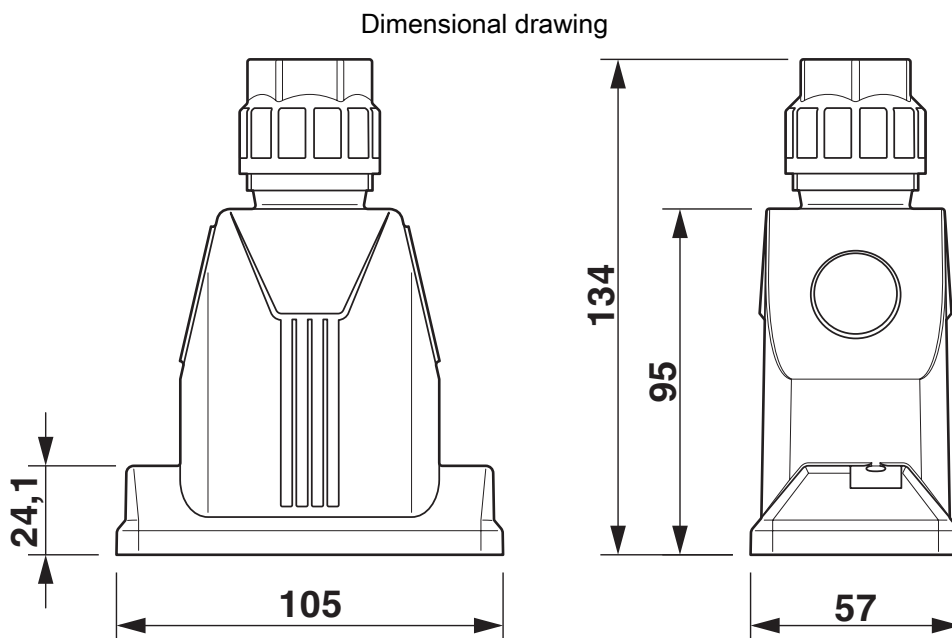

Dimensional drawing

HC-ADV-B10-HHWH-1TGM32-PL - Housing





1404229

<https://www.phoenixcontact.com/us/products/1404229>

Approvals

To download certificates, visit the product detail page: <https://www.phoenixcontact.com/us/products/1404229>

**DNV**
Approval ID: TAE000037S

**EAC**
Approval ID: RU C-DE.BL08.B.00511

**cUL Recognized**
Approval ID: E255026

**UL Recognized**
Approval ID: E255026

cULus Recognized

HC-ADV-B10-HHWH-1TGM32-PL - Housing



1404229

<https://www.phoenixcontact.com/us/products/1404229>

Classifications

ECLASS

ECLASS-11.0	27440202
ECLASS-12.0	27440202
ECLASS-13.0	27440202

ETIM

ETIM 9.0	EC000437
----------	----------

UNSPSC

UNSPSC 21.0	31261500
-------------	----------

Environmental product compliance

EU RoHS	
Fulfills EU RoHS substance requirements	Yes, No exemptions
China RoHS	
Environment friendly use period (EFUP)	EFUP-E
	No hazardous substances above the limits
EU REACH SVHC	
REACH candidate substance (CAS No.)	No substance above 0.1 wt%

HC-ADV-B10-HHWH-1TGM32-PL - Housing

1404229

<https://www.phoenixcontact.com/us/products/1404229>



Accessories

HC-B-AF - Panel-mount flange

1686533

<https://www.phoenixcontact.com/us/products/1686533>



Panel-mount flange for HEAVYCON ADVANCE housing

HC-B-AF-SET - Panel-mount flange

1604638

<https://www.phoenixcontact.com/us/products/1604638>

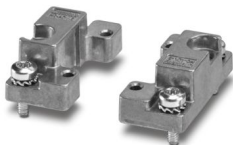

Panel-mount flange for HEAVYCON ADVANCE housing, set consisting of:
2 panel-mount flanges with 4 self-tapping screws (M4, Torx®) and 4 fan-type washers

HC-ADV-B10-HHWH-1TGM32-PL - Housing

1404229

<https://www.phoenixcontact.com/us/products/1404229>



US-EMP (20X9) - Snap-in markers

0829439

<https://www.phoenixcontact.com/us/products/0829439>



Snap-in markers, Card, white, unlabeled, can be labeled with: BLUEMARK ID COLOR, BLUEMARK ID, THERMOMARK PRIME, THERMOMARK CARD 2.0, THERMOMARK CARD, mounting type: snapped, lettering field size: 20 x 9 mm, Number of individual labels: 70

US-EMP (20X9) CUS - Snap-in markers

0830028

<https://www.phoenixcontact.com/us/products/0830028>



Snap-in markers, can be ordered: by card, white, labeled according to customer specifications, mounting type: snapped into marker carrier, lettering field size: 20 x 9 mm, Number of individual labels: 70

HC-ADV-B10-HHWH-1TGM32-PL - Housing

1404229

<https://www.phoenixcontact.com/us/products/1404229>



SF-M BH - Screwdriver

1212070

<https://www.phoenixcontact.com/us/products/1212070>



Bit screwdriver, with 1/4" quick-action chuck, handle length 119 mm, 2-component handle, with non-slip grip, suitable for bits according to DIN 3126-C 6.3 and E 6.3/ISO 1173, magnetic

SF-BIT-HEXB 5-89 - Screw insert

1208911

<https://www.phoenixcontact.com/us/products/1208911>



Screw bit, hexagonal with ball head, E6.3-1/4" drive, size: Hex 5 x 89 mm, hardened, suitable for holder according to DIN 3126-F 6.3/ISO 1173

Phoenix Contact 2024 © - all rights reserved
<https://www.phoenixcontact.com>

Phoenix Contact USA
586 Fulling Mill Road
Middletown, PA 17057, United States
(+717) 944-1300
info@phoenixcon.com